

RapidWire

by

WireCrafters

Installation Instructions

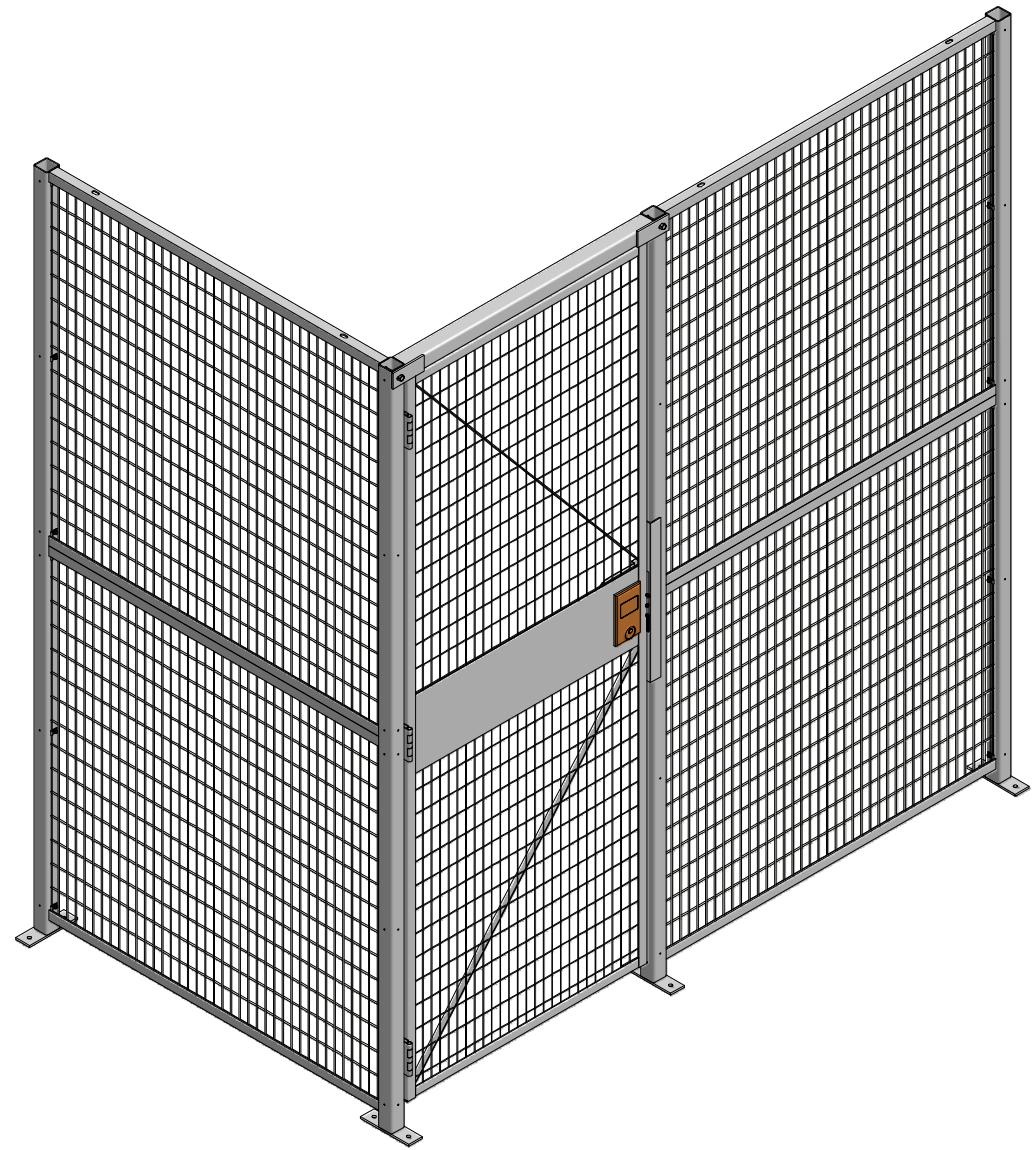

We're Here To Help
1-800-626-1816
Mon-Fri 8am-5pm ET

RapidWire

Panels and Posts Installation

1. Use a chalk line to outline the partition layout on the floor.
 - a. Out to out dimensions shown on drawing are to face side of posts.
 - b. Post base plates project 2-1/2" beyond outline of partition.
2. Lag end of post (A) to floor per Fig. 3 using two anchors provided.
 - a. If end partition mounts directly to building wall, support panel with 2" spacer block, and mount panel to wall with appropriate wall mount kit.
3. Mount bottom panel (B) to post (A)
 - a. **Note: Panels install horizontally; 13 gauge angle parallel with floor.**
4. Attach opposite end of panel (B) to second post (C).
5. Lag post to floor using two anchors provided.
6. Install top panel (D) between posts and bolt to lower panel (B) per Fig. 1 using 3/8" x 1" nuts and bolts.

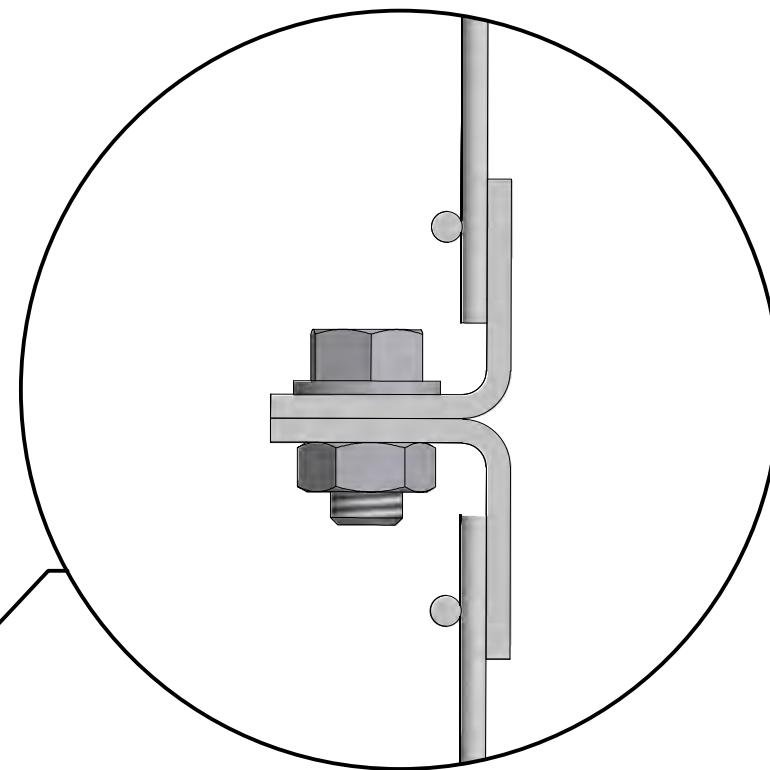

Fig. 1

INSTALLER NOTES

Component parts attach using self-drilling screws. Use variable speed screw gun with adjustable clutch or depth locating nose piece. Use care not to overtighten and strip threads. **DO NOT USE IMPACT TYPE GUNS.**

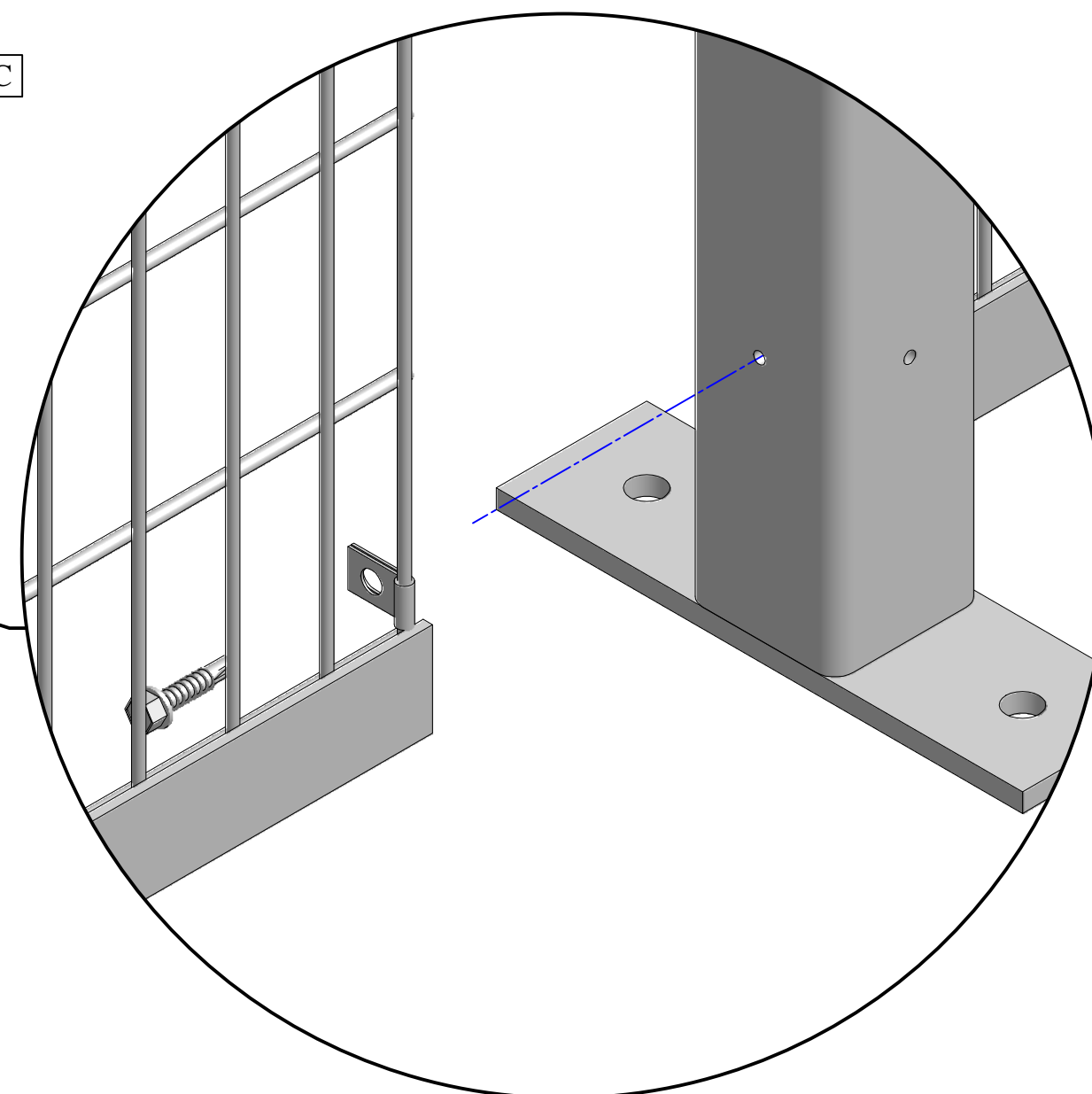

Fig. 2

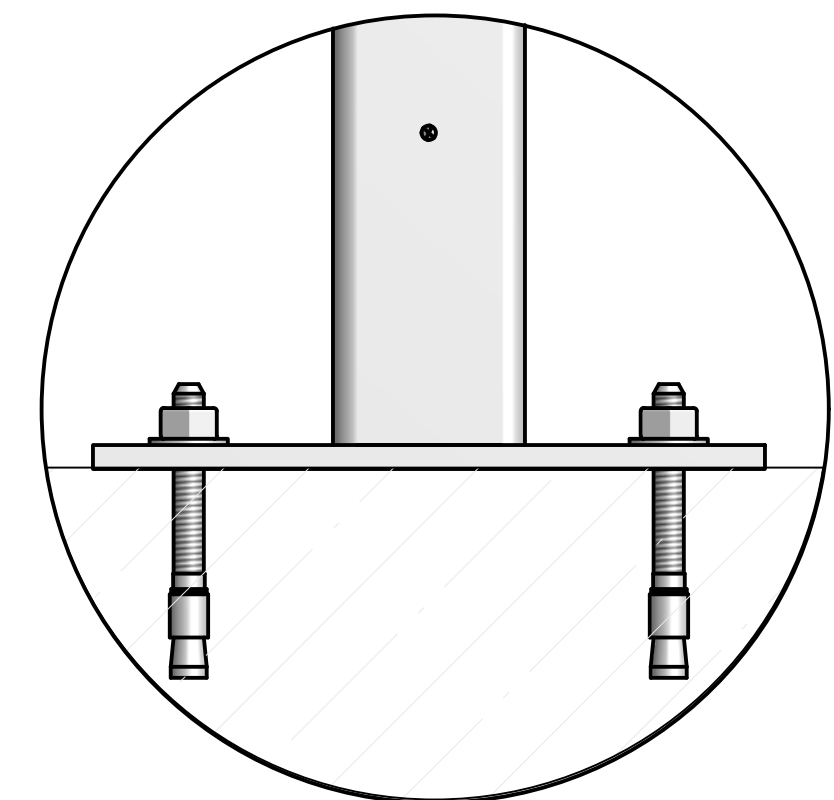
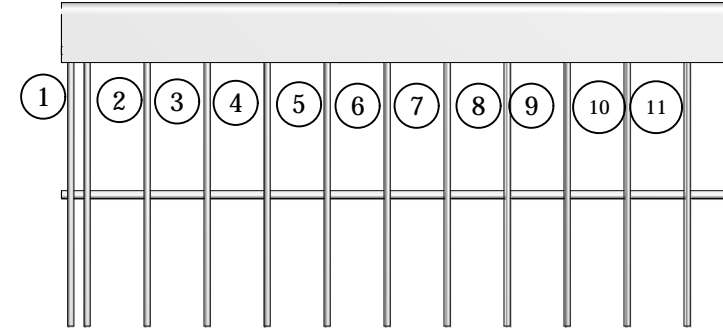
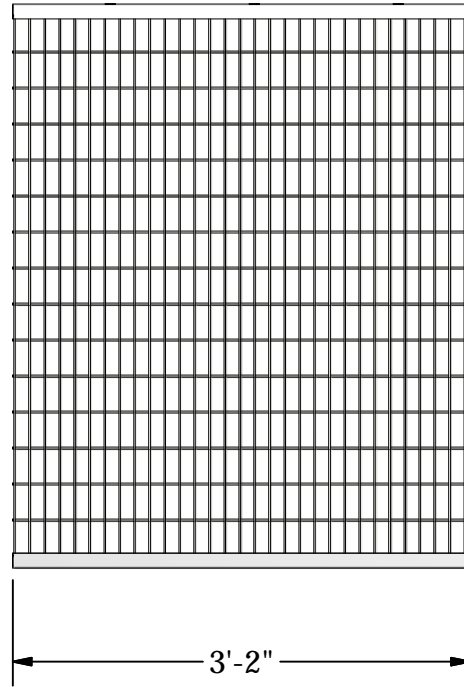
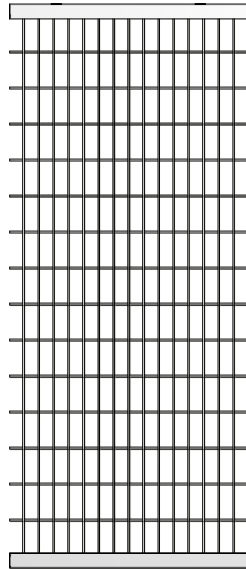
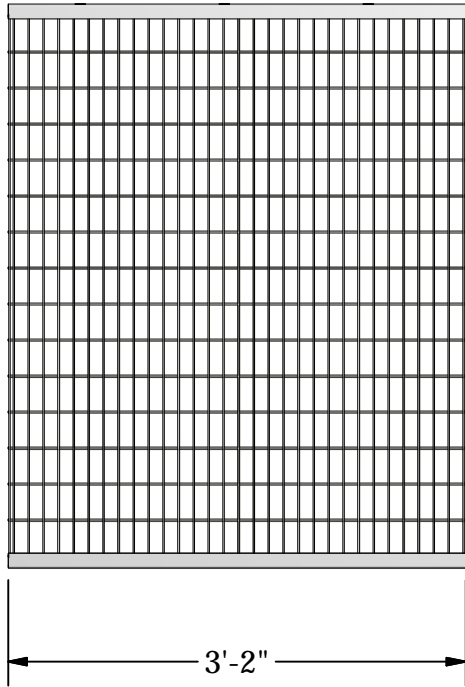
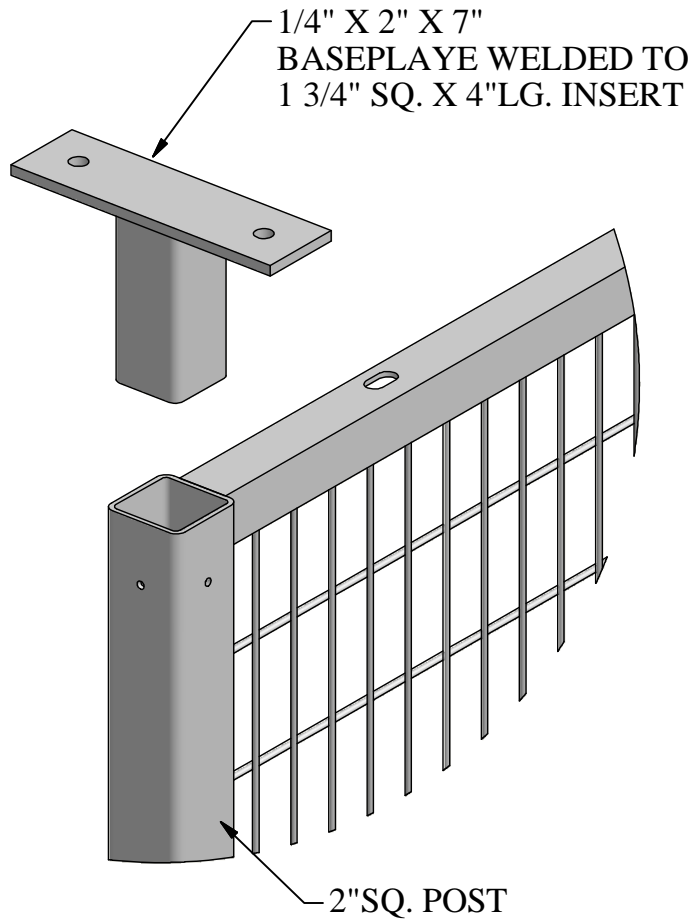

Fig. 3



8'-0" Long will make the following panel stacks

<u>Panel Width</u>	<u>Cut Along Wire #</u>	<u>Panel Width</u>	<u>Cut Along Wire #</u>
0'-11 3/4"	11	2'-6 1/2"	26
1'-1"	12	2'-7 3/4"	27
1'-2 1/4"	13	2'-9"	28
1'-3 1/2"	14	2'-10 1/4"	29
1'-4 3/4"	15	2'-11 1/2"	30
1'-6"	16	3'-0 3/4"	31
1'-7 1/4"	17	3'-2"	32
1'-8 1/2"	18	3'-2 1/4"	33
1'-9 3/4"	19	3'-4 1/2"	34
1'-11"	20	3'-5 3/4"	35
2'-0 1/4"	21	3'-7"	36
2'-1 1/2"	22	3'-8 1/4"	37
2'-2 3/4"	23	3'-9 1/2"	38
2'-4"	24	3'-10 3/4"	39
2'-5 1/4"	25		



DETAIL TES-4

Accessory item used to anchor
partition wall to overhead structure

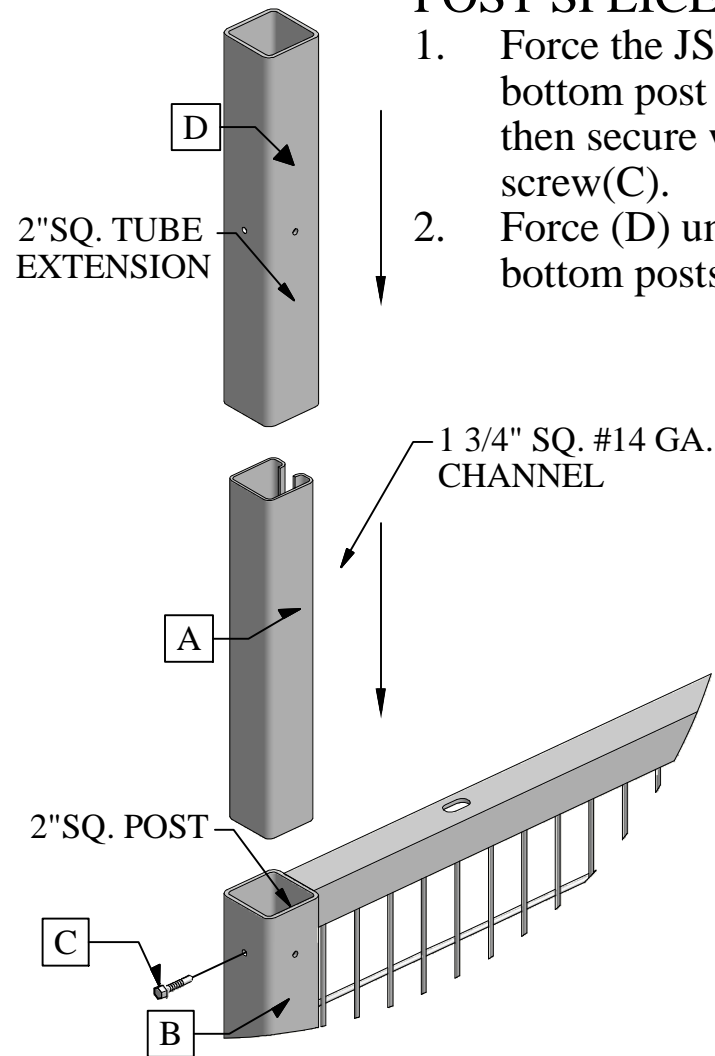

POST SPLICE INSTRUCTIONS

1. Force the JSPE (A) into the bottom post (B) five inches then secure with self drilling screw (C).
2. Force (D) until the top and bottom posts meet flush.

DETAIL JSPE

Accessory item used to extend
height to existing wall.

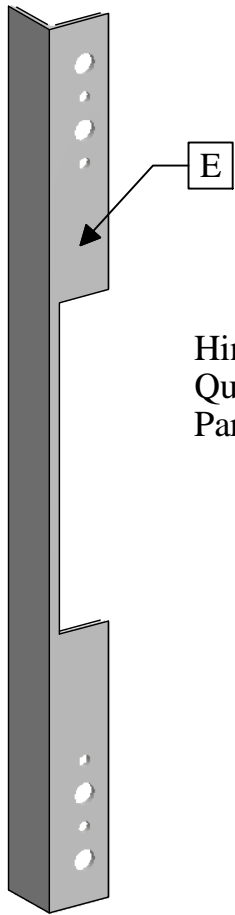

Hinge Door Angle Pick Plate
Quantity (1)
Part# HDCPLI

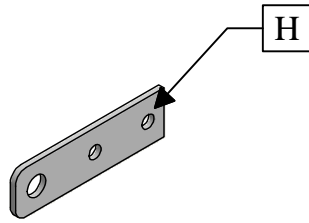

Hinge Door Flat Padlock Lug
Quantity (1)
Part# HDLPLLI

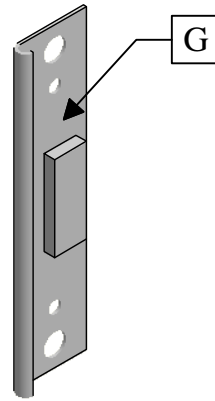

Hinge Door Lock Receiver
Quantity (1)
Part# HDLRLI

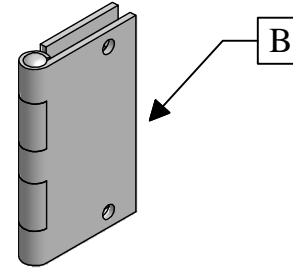

Door Hinge
Quantity (3)
Part# HDHG44I

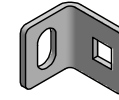

Hinge Door Angle Padlock Lug
Quantity (1)
Part# HDANPLL

**SEE SUPPLIED LOCK MANUFACTURER
INSTRUCTIONS FOR ASSEMBLY**

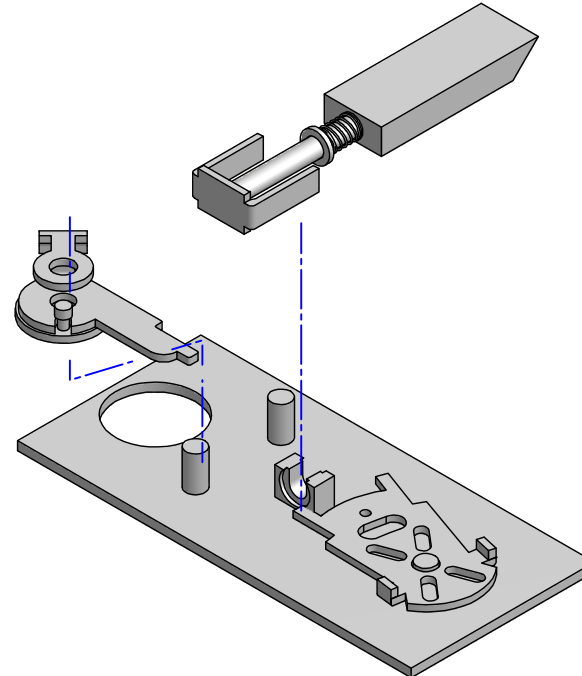

RIGHT HAND ASSEMBLY

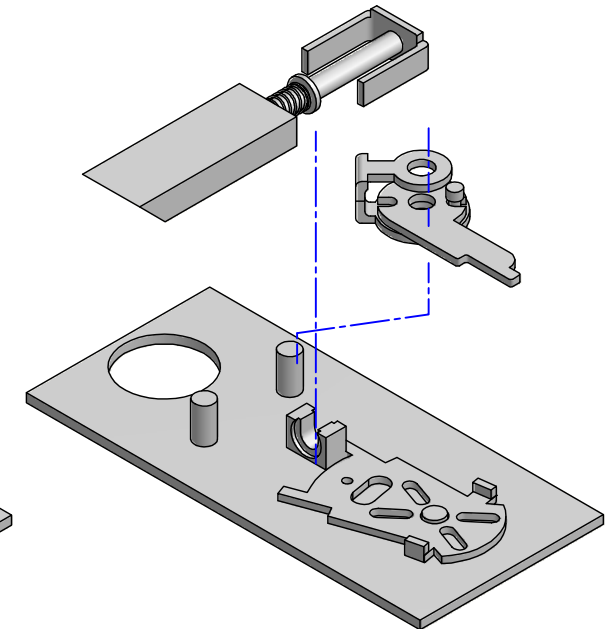

LEFT HAND ASSEMBLY

HDFSPK - Fasener Pack (Contents Below)

- (25) FSHOPG - Gray Hole Plugs
- (8) COBO - 3/8" Corner Bolts
- (8) FS383 - 3/8" x 3" Hex Head Cap Screw
- (6) FS381 - 3/8" x 1" Hex Head Cap Screw
- (30) FS38N - 3/8" Hex Nut
- (4) FS38STA - 3/8" Wedge Anchor
- (1) FSTRNSPK - Self-Drilling Screws (25)

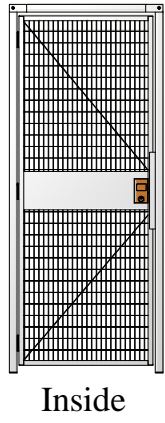
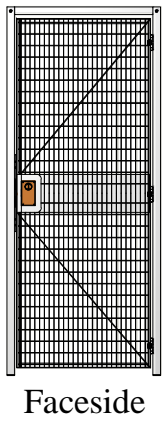
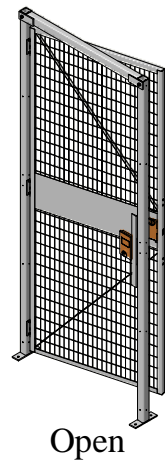

INSTALLER NOTES

Component parts attach using self-drilling screws. Use variable speed screw gun with adjustable clutch or depth locating nose piece. Use care not to overtighten and strip threads. DO NOT USE IMPACT TYPE GUNS.

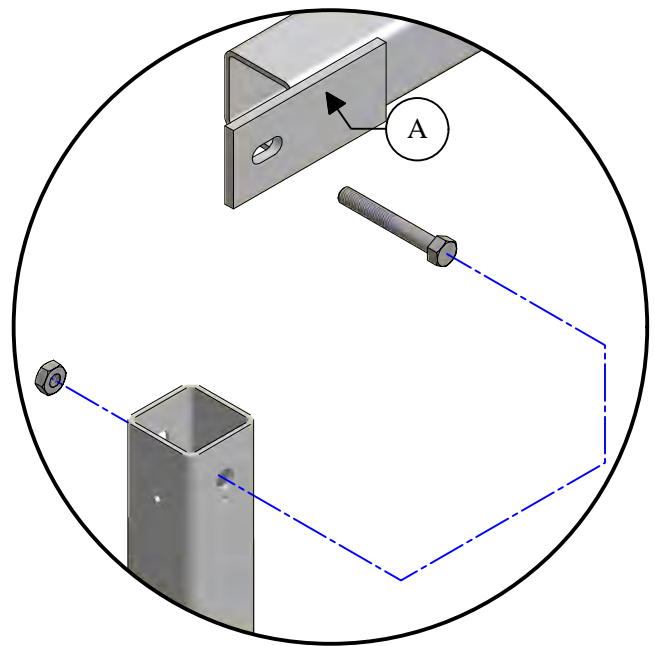

Fig. 1

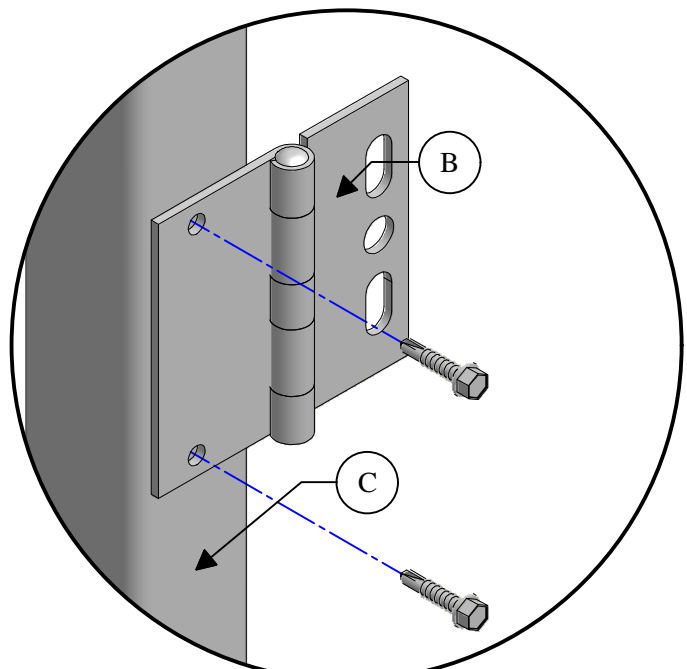

Fig. 2

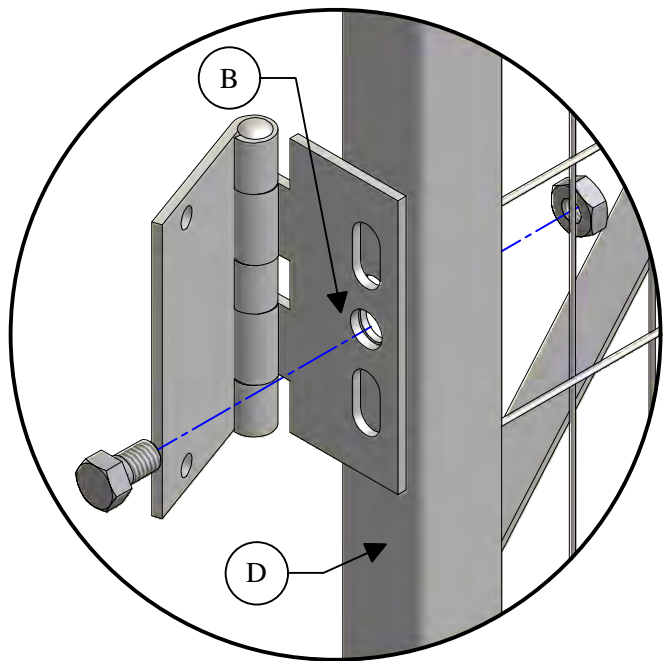

Fig. 3

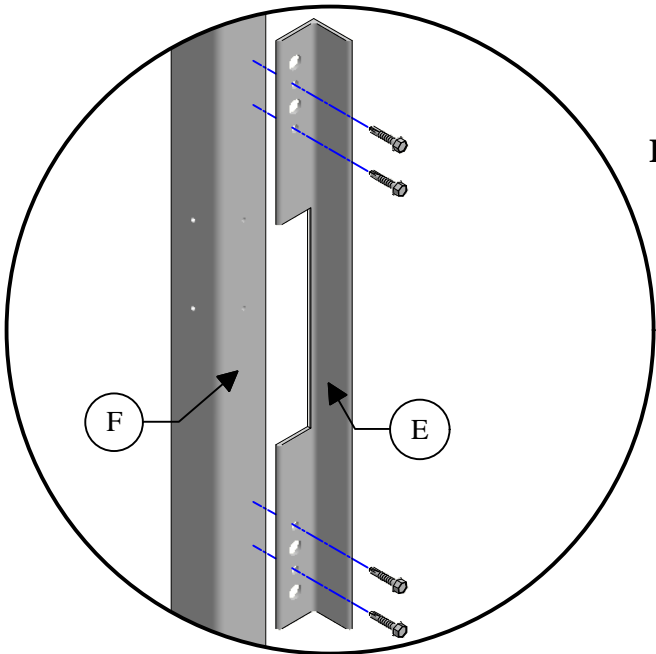

Fig. 4

INSTALLER NOTES

Component parts attach using self-drilling screws. Use variable speed screw gun with adjustable clutch or depth locating nose piece. Use care not to overtighten and strip threads. DO NOT USE IMPACT TYPE GUNS.

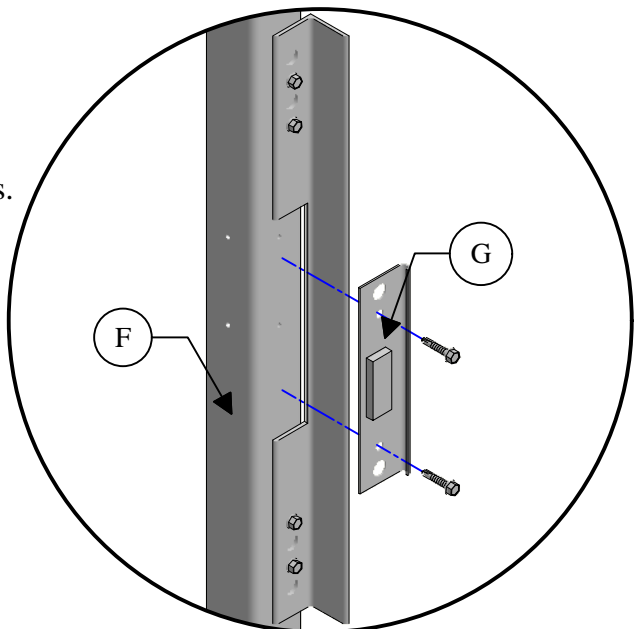
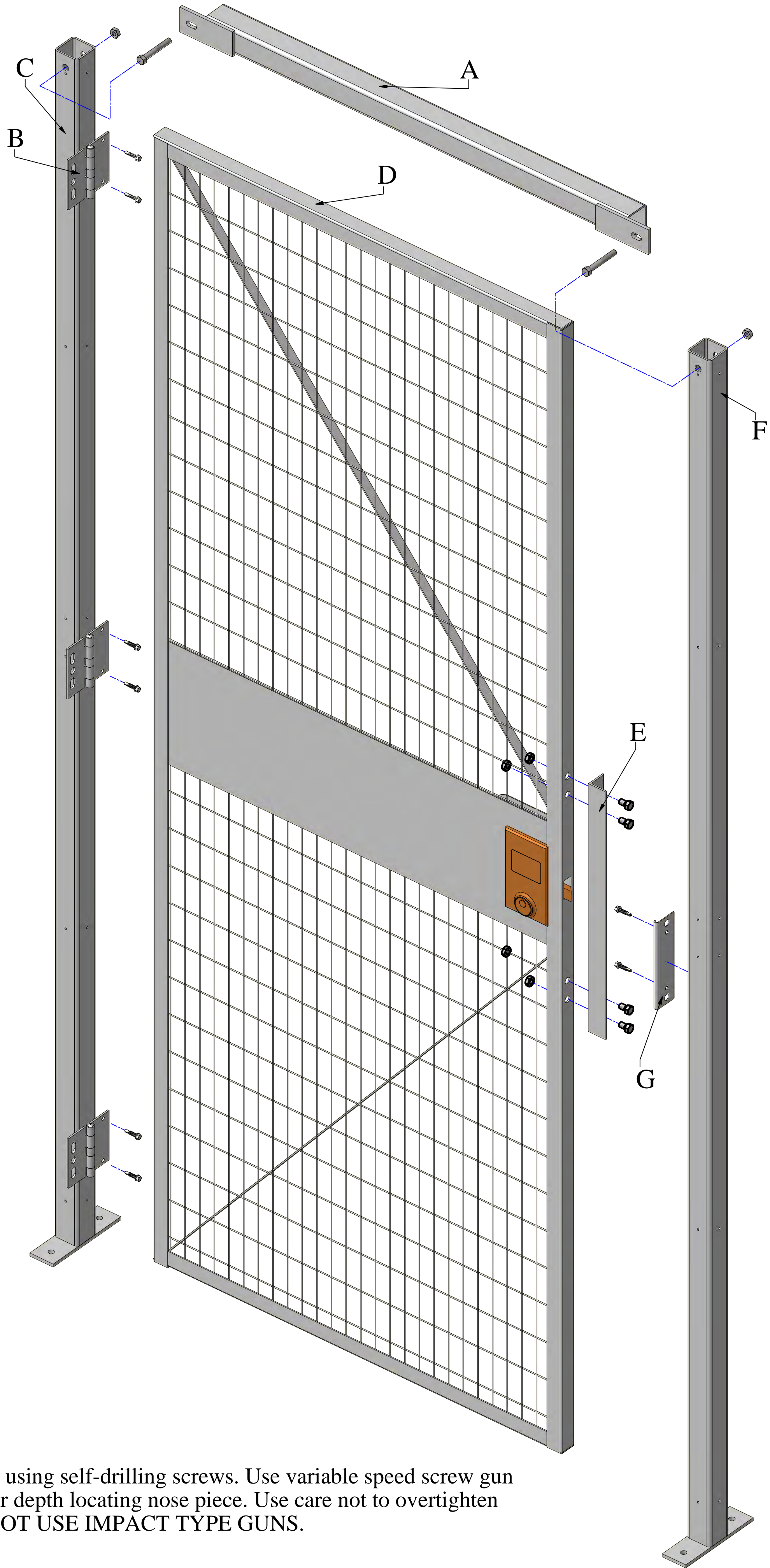
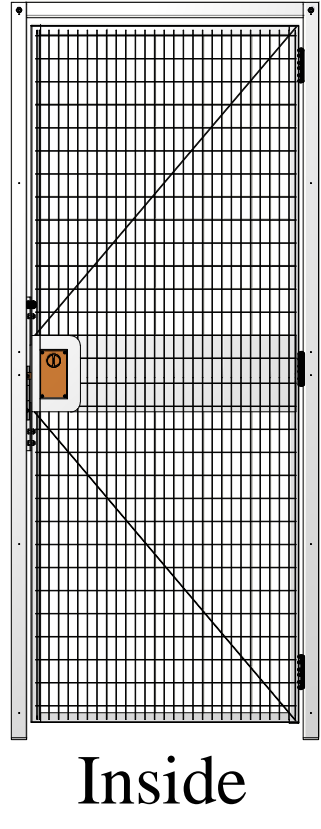
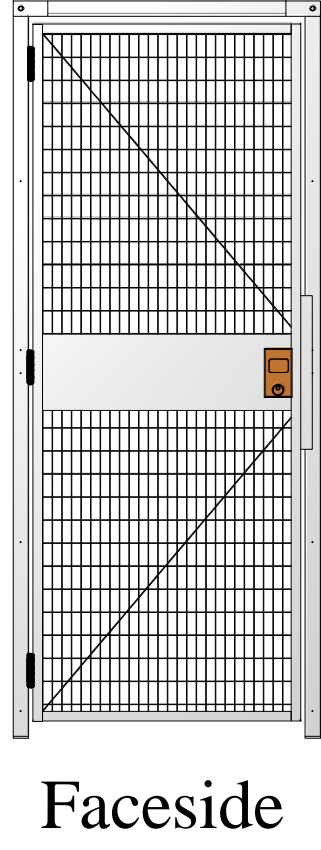
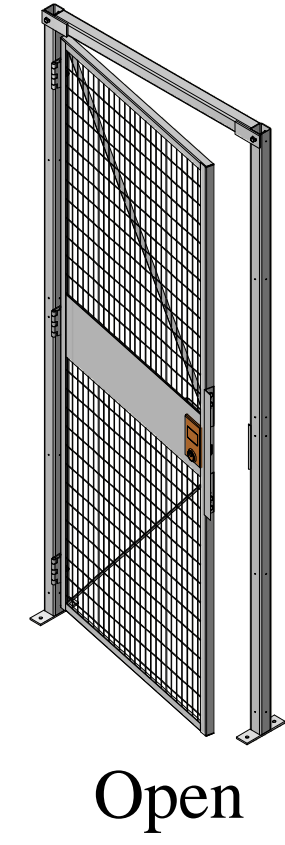

Fig. 5



INSTALLER NOTES

Component parts attach using self-drilling screws. Use variable speed screw gun with adjustable clutch or depth locating nose piece. Use care not to overtighten and strip threads. DO NOT USE IMPACT TYPE GUNS.

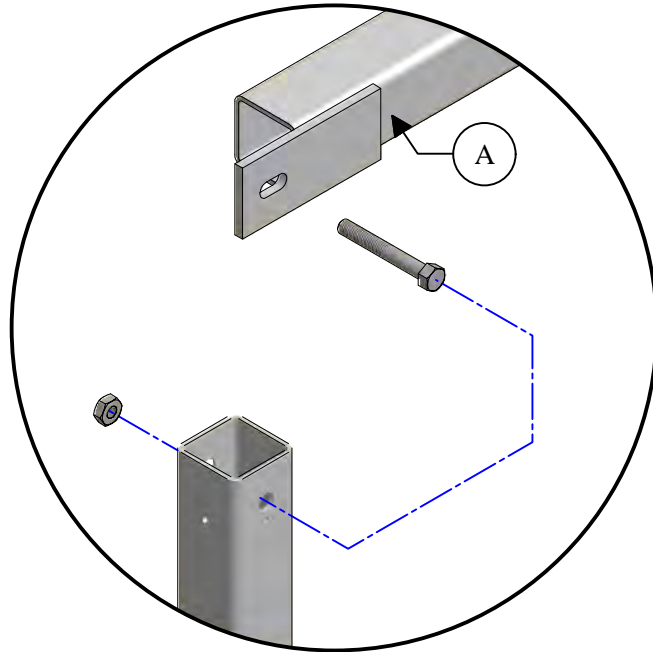

Fig. 1

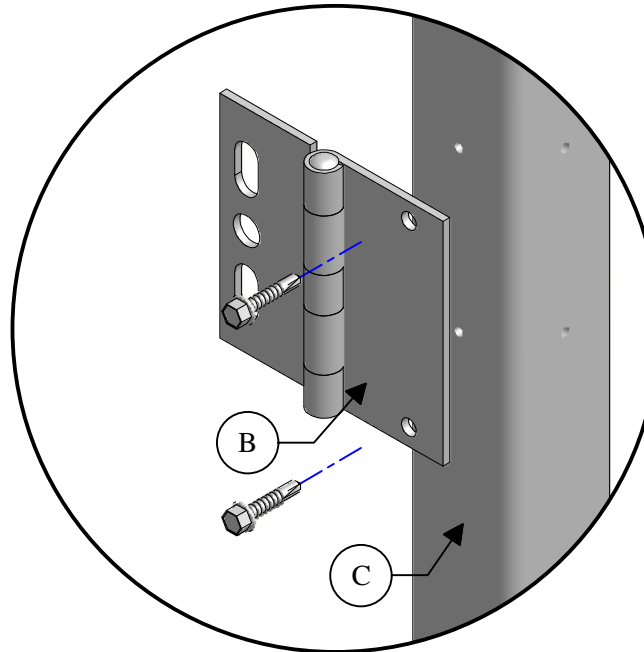

Fig. 2

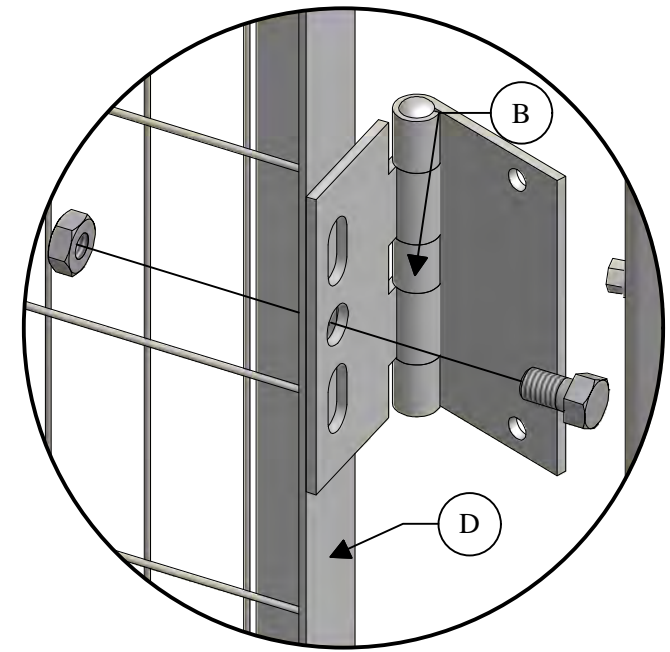

Fig. 3

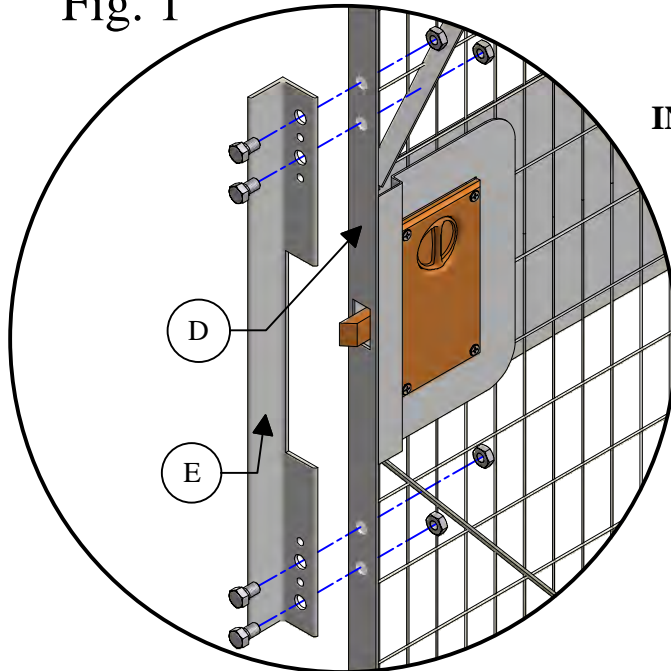

Fig. 4

INSTALLER NOTES

Component parts attach using self-drilling screws. Use variable speed screw gun with adjustable clutch or depth locating nose piece. Use care not to overtighten and strip threads. DO NOT USE IMPACT TYPE GUNS.

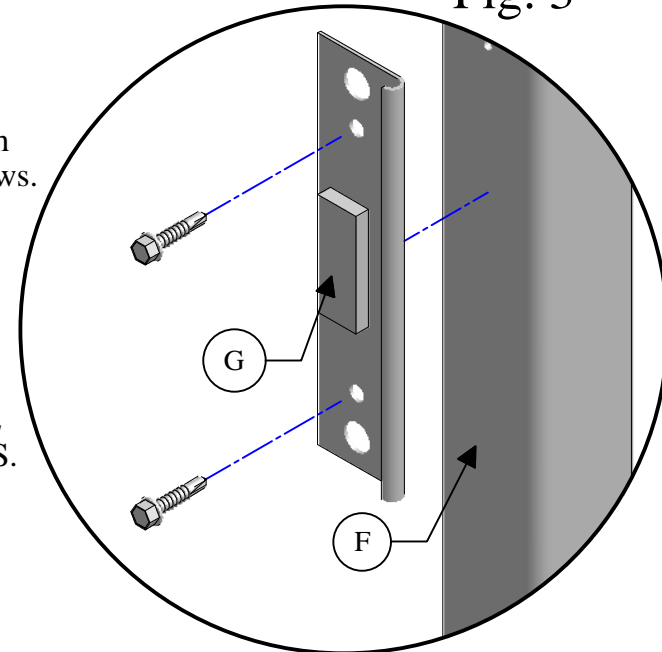
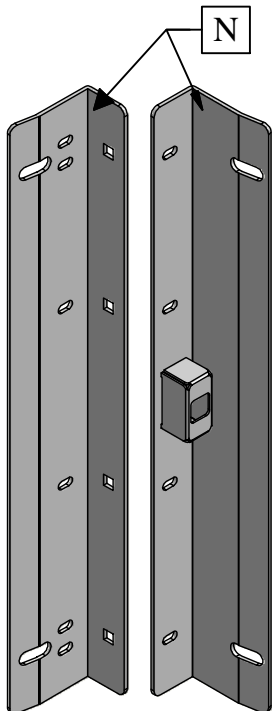
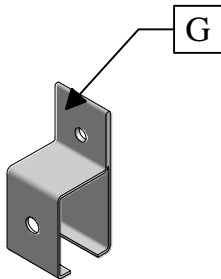

Fig. 5



SDRECA SDRECB
Slide Door Receiver
Quantity (1)
Part# SDREC



G
Slide Door Track Bracket
Quantity (2)
Part# SDTCBKT

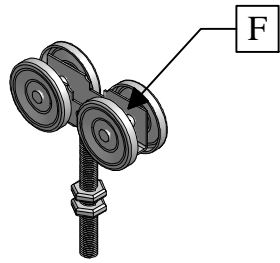

F
4 Wheel Trolley truck
Quantity (2)
Part# SDTT4WH

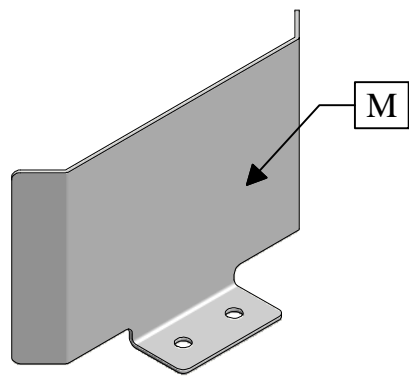

M
Door Guide
Quantity (1)
Part# SDDGH18

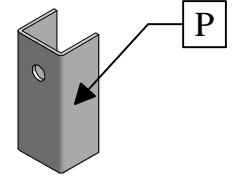

P
1 11/6" x 1 1/2" Channel 4" Lg.
Quantity (1)
Part# SDSDT

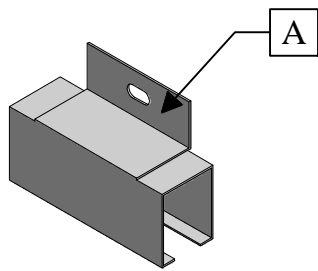

A
Splice Track Bracket
Quantity (1)
Part# SDTJBKT

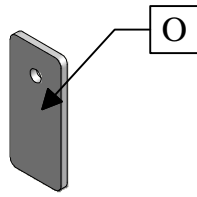

O
Slide Door Shim
Quantity (4)
Part# SDSCH412238

**SEE SUPPLIED LOCK
MANUFACTURER INSTRUCTIONS FOR
ASSEMBLY**

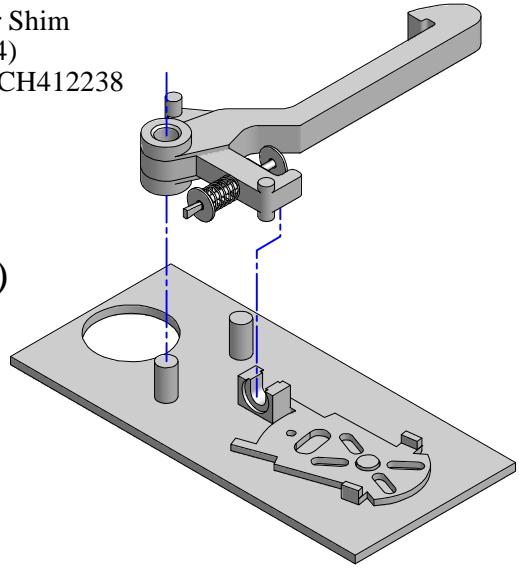

RIGHT HAND ASSEMBLY

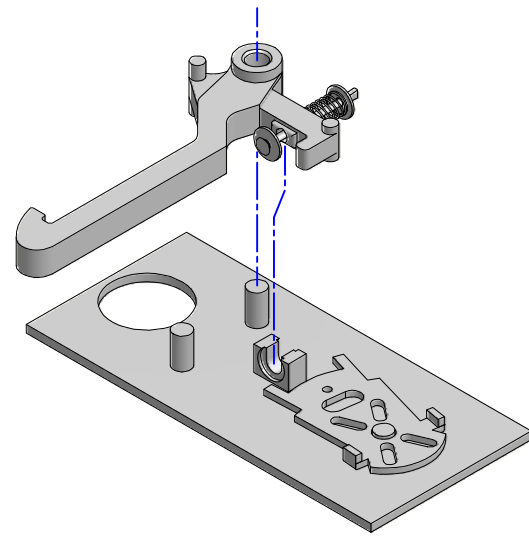

LEFT HAND ASSEMBLY

SDFSPK - Slide Door Fastener Pack (Contents below)

- (35) FSHPOG - Gray Hole Plugs
- (2) COBO - 3/8" Corner bolts
- (9) FS383 - 3/8" Hex Head Cap Screw
- (2) FS381 - 3/8" x 1" Hex Head cap Screw
- (17) FS38N - 3/8" Hex Nut
- (6) FS38STA - 3/8" Wedge Anchor
- (6) FS38FW - 3/8" Flat Washer
- (1) FS38112 - 3/8" x 1 1/2" Hex Head Cap Screw
- (1) FSTRNSPK - 1/4" x 1" Self-Drilling Screws (25) & 5/16" Carriage Bolts (4)

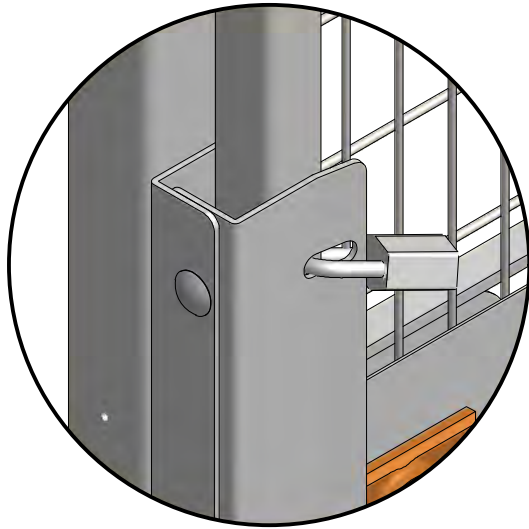

TYPICAL PADLOCK LUG CONNECTION

INSTALLER NOTES

Component parts attach using self-drilling screws. Use variable speed screw gun with adjustable clutch or depth locating nose piece. Use care not to overtighten and strip threads. **DO NOT USE IMPACT TYPE GUNS.**

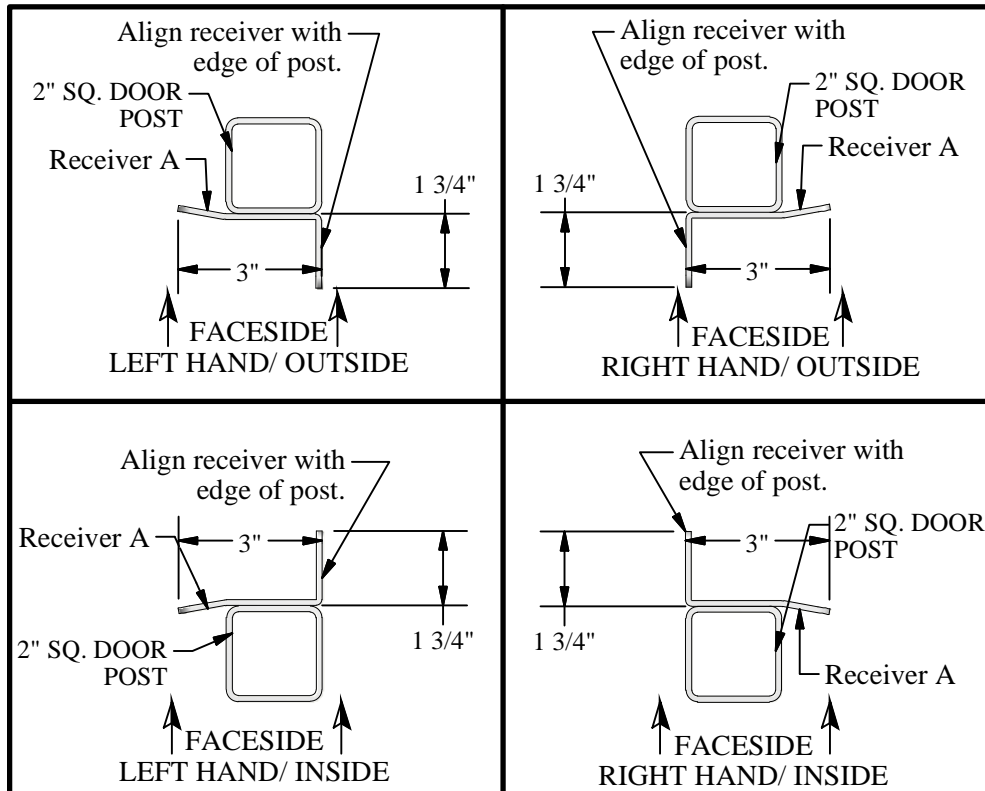
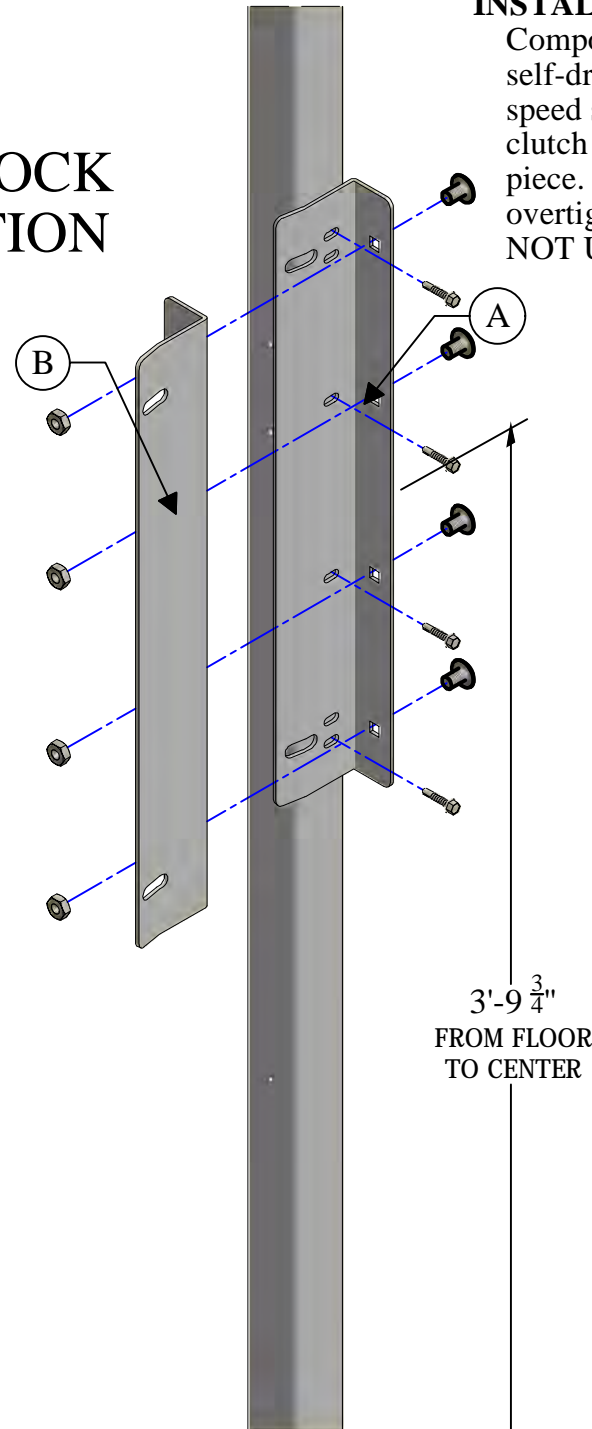

Fig. 1

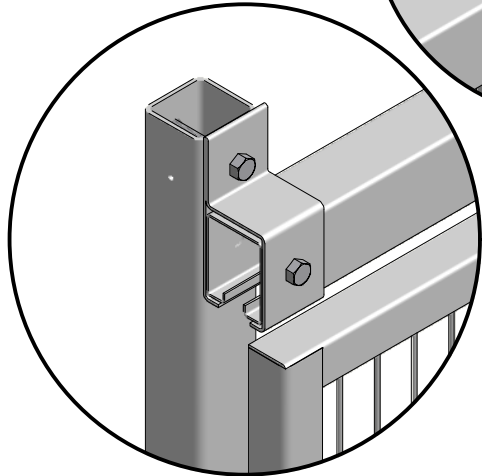
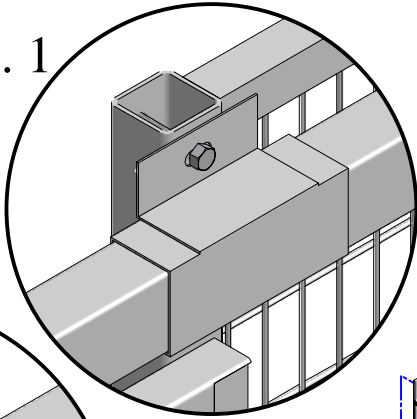

Fig. 2

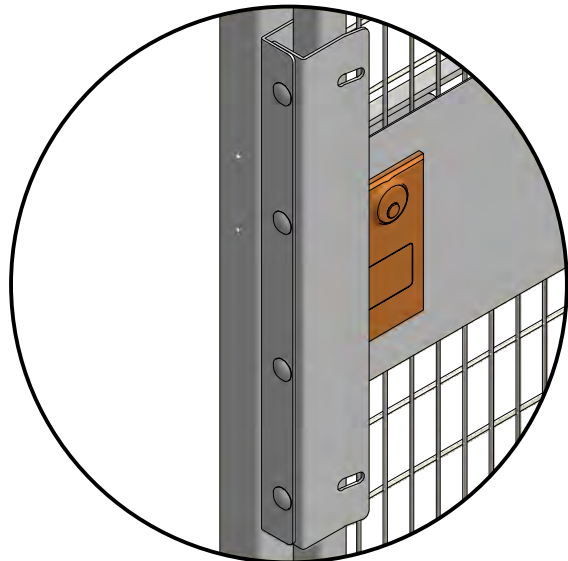

Fig. 5

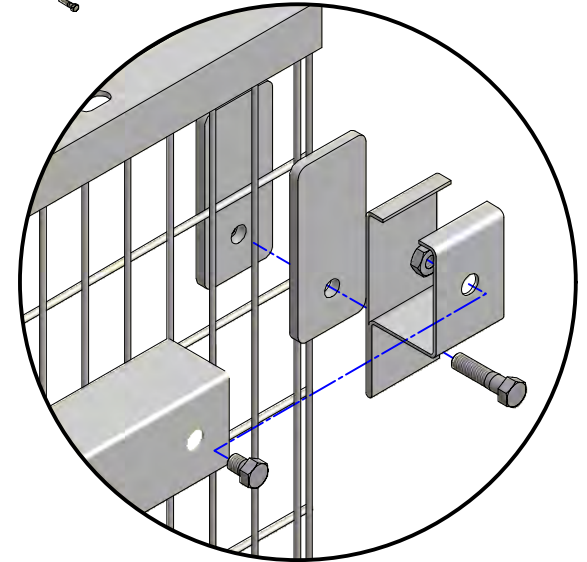
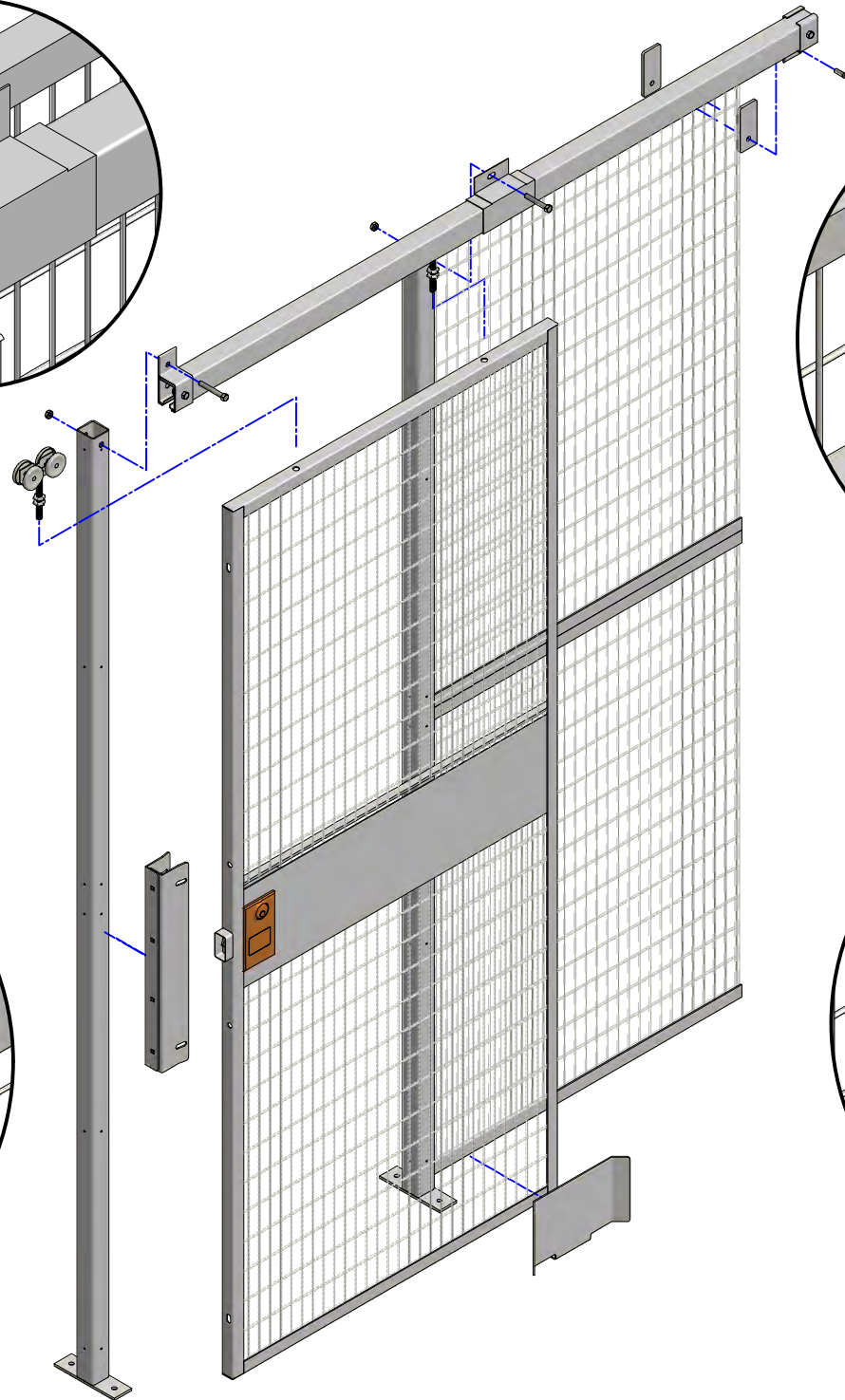

Fig. 3

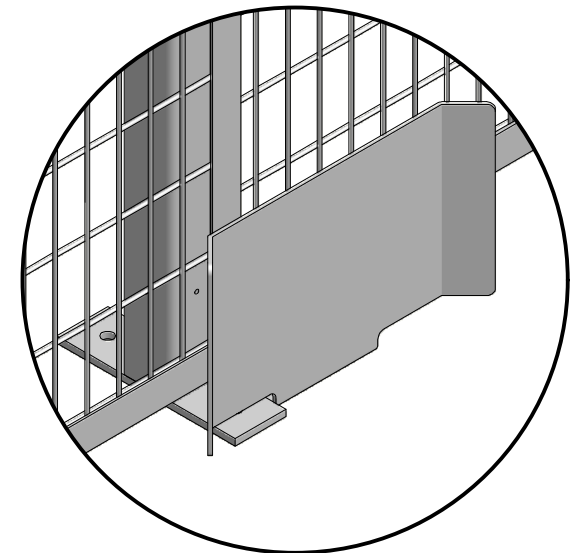

Fig. 4

RapidWire

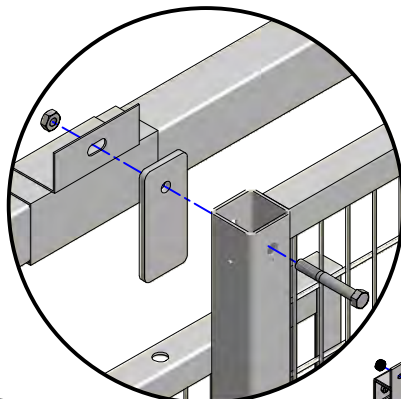

Fig. 1

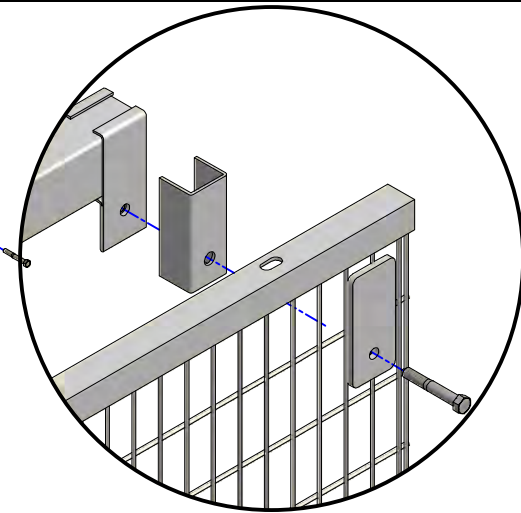

Fig. 3

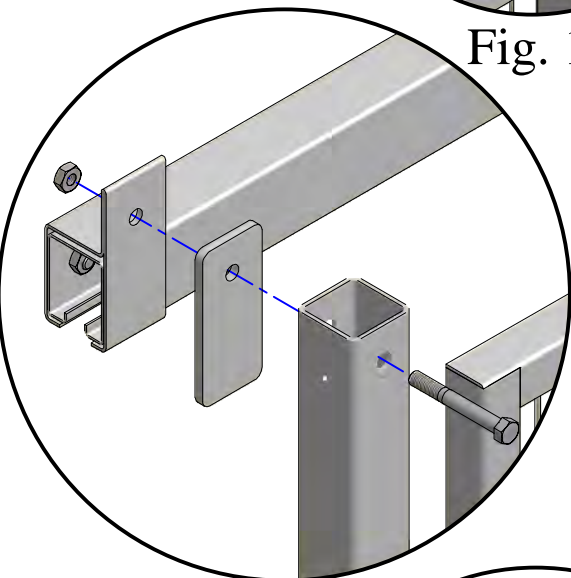

Fig. 2

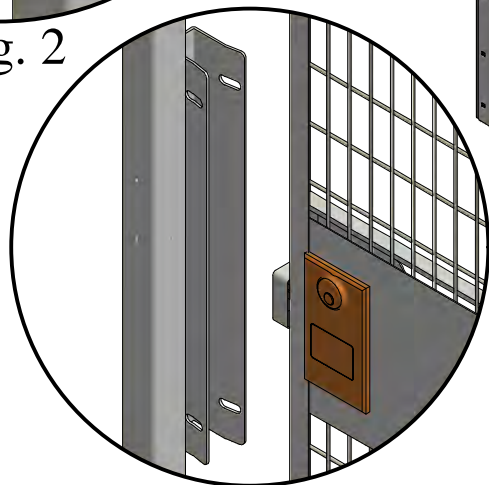

Fig. 5

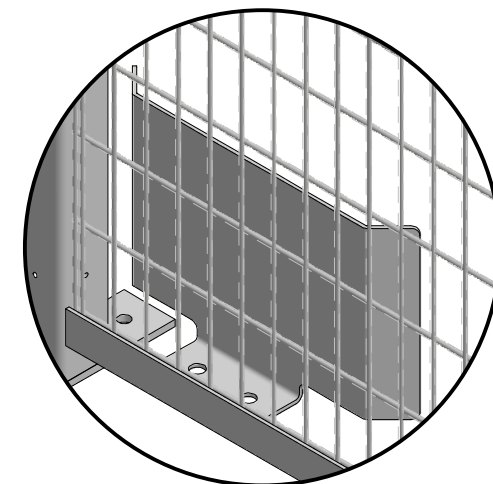
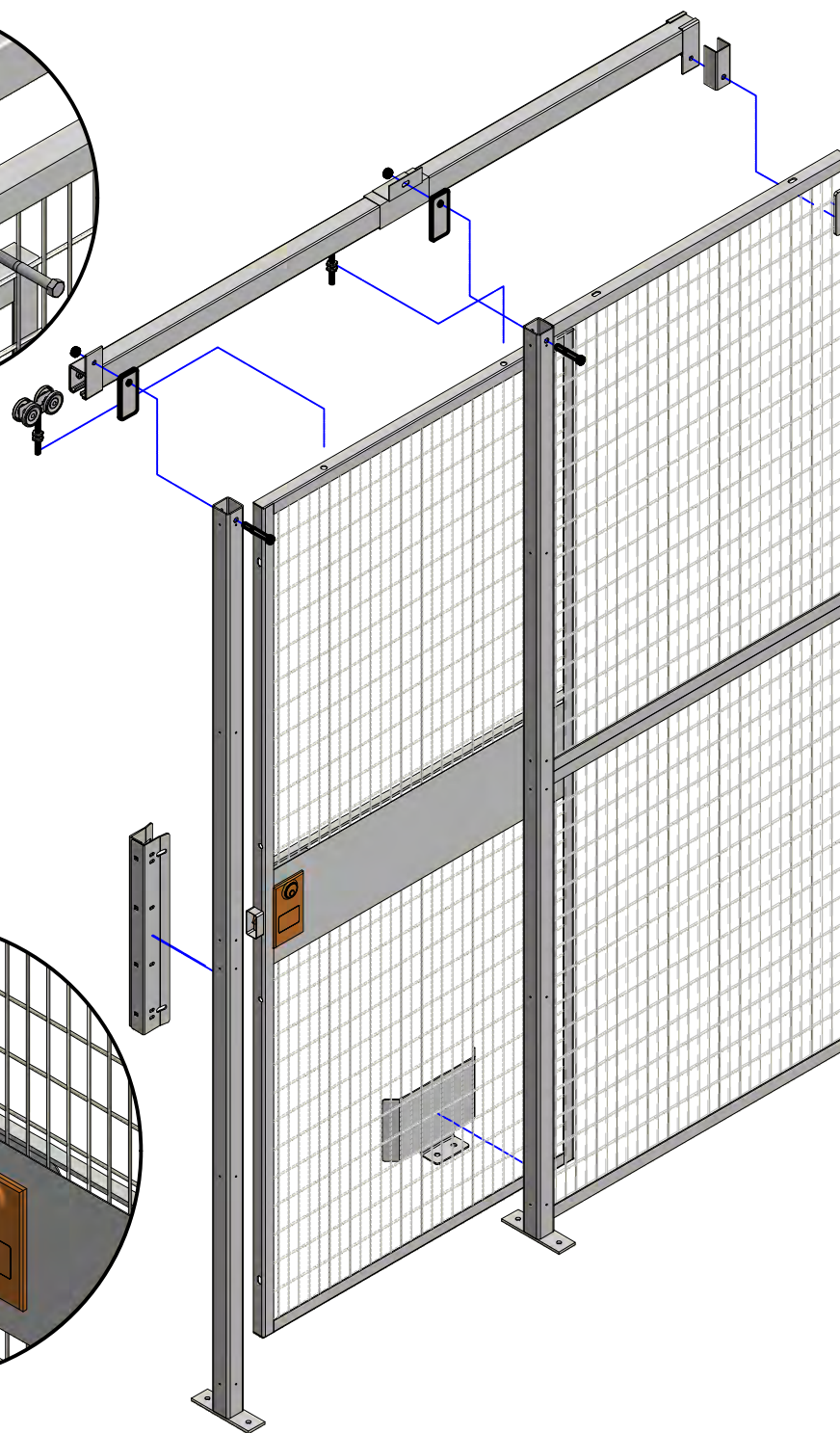

Fig. 4

NOTE: Part (C) DEP for 10'
High Doors Only

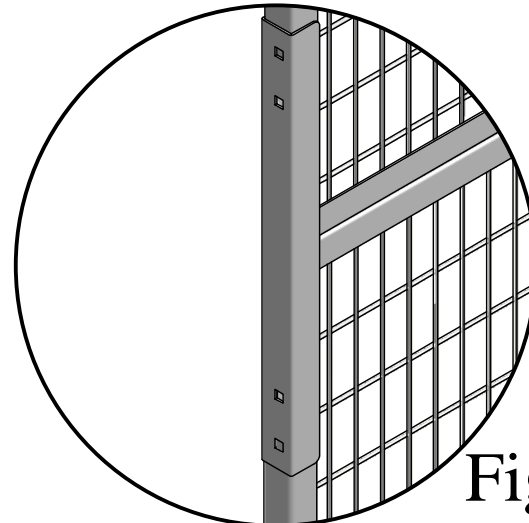
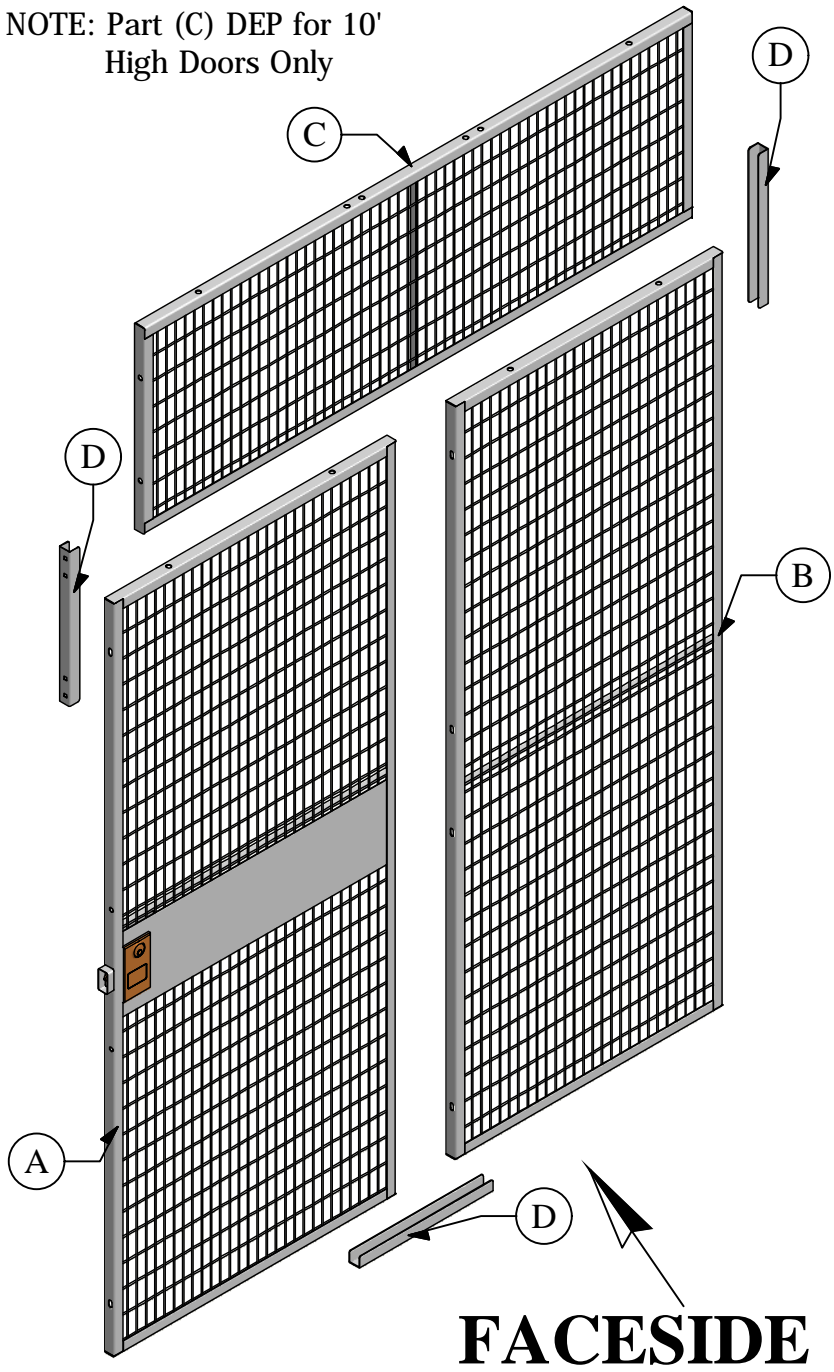

Fig. 1
10' High Doors or Taller

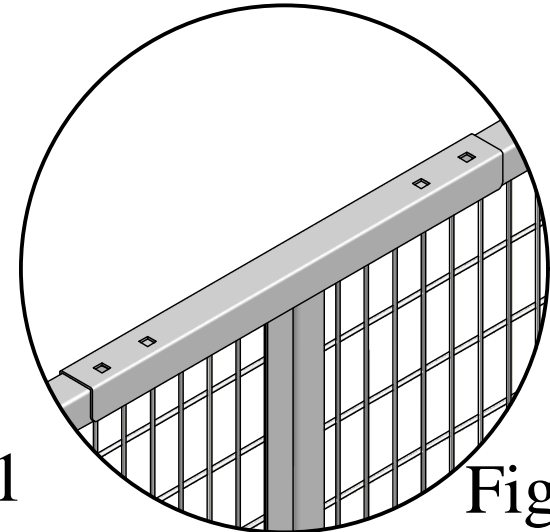

Fig. 2
8' High Doors or Shorter