

# Shop Desk Assembly Instructions Part No. 8356

Shop Desk with Riser Penco Part No. 35100

## Parts List

Qty.	Description
1	Desktop Assembly
4	Legs
2	Side Bars
1	Foot Rest
1	Drawer
1	Drawer Stop
22	Screws 1/4 x 20 x 1/2
22	Nuts 1/4 x 20
1	Built-In Lock for Drawer
2	Keys for Built-In Lock

## Tools Needed

Flat Head Screwdriver  
7/16" Wrench or Nut Driver

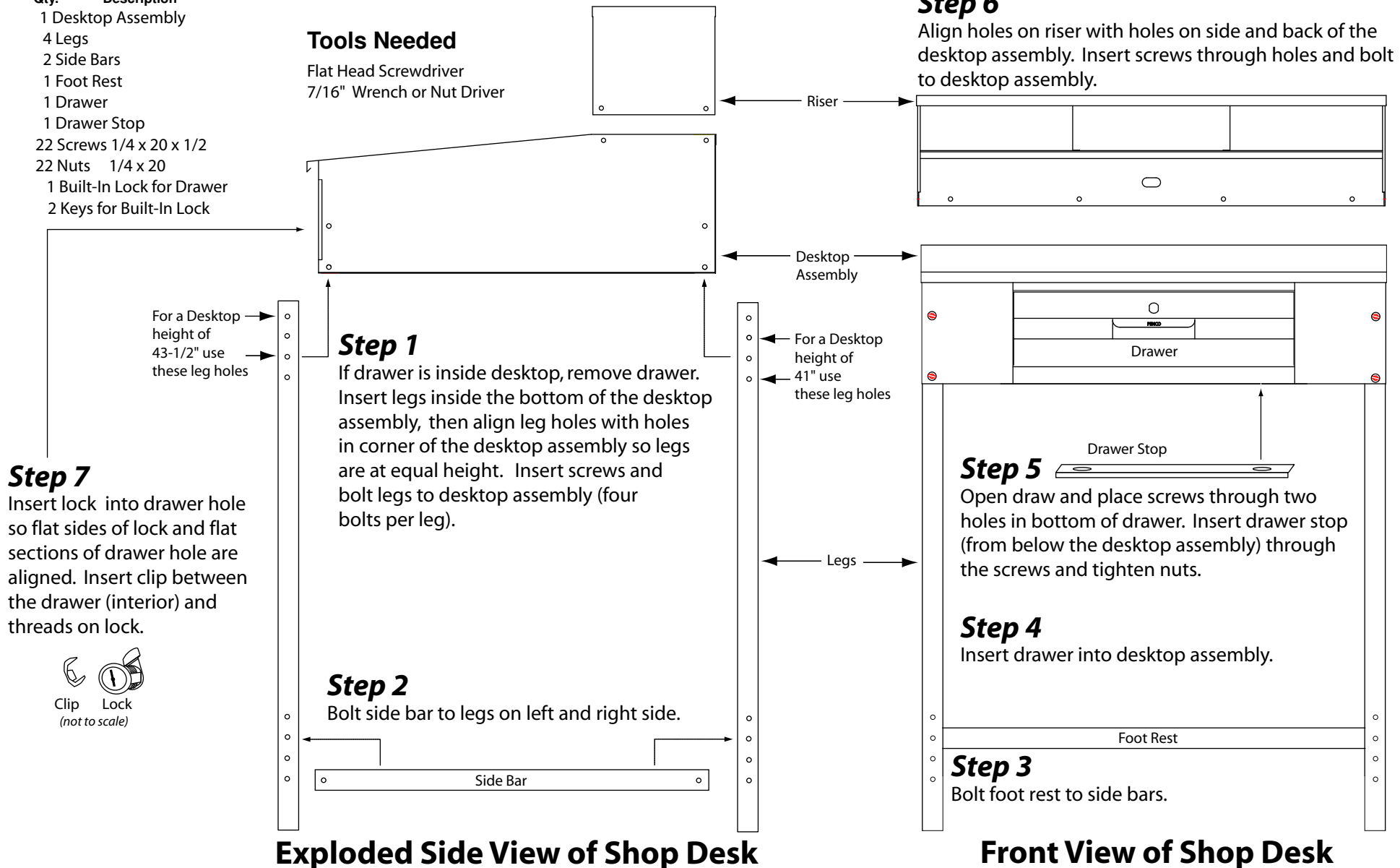

**Exploded Side View of Shop Desk**

**Front View of Shop Desk**