

BESTTM

Diversified Products, Inc.

PowerTrax

Operation, Maintenance and Parts Manual

Manual

Factory Order Number: _____

Serial Number: _____

Ship Date: _____

Best Diversified Products, Inc.

107 Flint St.

Jonesboro, Arkansas 72401

Phone: 870-935-0970

Toll Free: 800-327-9209

Fax: 870-935-3661



File Number E230497

99053

July 23, 2003

Please visit our website at www.bestconveyors.com and click on downloads for the latest updates to this manual.

Please read entire manual before operating conveyor.

Table of Contents

Introduction.....	3
Warranty.....	3
UL Statement.....	4
Safety Information.....	5
Operating Instructions.....	5
Standard Features and Options.....	6
Troubleshooting/Maintenance.....	7-8
PowerTrax 24” Gravity Bed Parts List.....	10-11
PowerTrax 30” Gravity Bed Parts List.....	12-13
PowerTrax 24” Power Bed Parts List.....	14-15
PowerTrax 30” Power Bed Parts List.....	16-17
Accumulation Photo Eye Kit, 24”.....	18
Accumulation Photo Eye Kit, 30”.....	19
Photo Eye Package Stop Kit, 24”.....	20
Photo Eye Package Stop Kit, 30”.....	21
Wiring Diagram, Gravity Bed.....	22
Wiring Diagram, Power Bed.....	23
Wiring Diagram, PowerTrax With Accumulation.....	24
Wiring Diagram, Photo Eye Package Stop.....	25
Control Enclosure.....	26

PowerTrax Manual

Introduction

Thank you for purchasing the PowerTrax. The PowerTrax was carefully designed by engineers at Best Diversified Products, Inc. to make loading and unloading trailers safer, easier and faster. It has variable speed control and operates only when the switch is held down for safety. The durable all steel construction chassis and the pneumatic slick wheels provide positive traction to travel easily over dock levelers. An electrical brake can be installed to hold the PowerTrax on larger inclines. It conveniently comes in 110V and 240V AC models. It also has built-in adjustable height capabilities.

The PowerTrax is available with gravity or powered rollers, so it works perfectly with any Best/Flex, gravity or power, conveyor system. It comes in 24" and 30" widths, but can be made to fit all of Best's expandable conveyors. It can be retrofitted or mounted to a complete system. The optics package can be added to the powered-roller PowerTrax.

Before using the PowerTrax, please take time to review the drawings and instructions in this manual.

Warranty Summary Statement

Your Best conveyor is protected by our premier warranty. Best Diversified Products, Inc. will replace, free of charge, parts that are damaged during the course of normal operation due to material or workmanship defects. This warranty extends for a period of two (2) years on all mechanical components and one (1) year on all electrical components, as measured from the date you take possession of your conveyor.

This warranty does not cover damage due to accident, misuse, abuse, and negligence. This warranty does not cover damage due to improper operation or maintenance, connection to improper voltage supply, or attempted repair/modification by anyone other than an authorized Best Diversified Products, Inc. service personnel.

For specific warranty information or assistance, please contact your Best Diversified Products, Inc. sales representative at 1-800-327-9209.

UL Statement



Underwriter's Laboratories Certification Statement

Best conveyors have been thoroughly tested by Underwriter's Laboratories, and have been found to meet their strict standards for Factory Automation Equipment. Our conveyors are certified to UL508 Standards when shipped from our plant. Our UL file number is E230497. All standards can be found on-line at www.ul.com.

ANY MODIFICATION FROM ORIGINAL FACTORY CONDITION OR REPAIRS NOT PERFORMED BY BEST DIVERSIFIED PRODUCTS' TECHNITIONS OR CERTIFIED CONTRACTORS MAY VOID UL CERTIFICATION.

For specific assistance regarding any UL issues, please contact your Best Diversified Products, Inc. sales representative at 1-800-327-9209.

Safety Information

- Move the PowerTrax only by grasping the handles located on each side and at the front of the unit.
- Do not tape or in any way fix the RUN switch in the operating position.
- Do not exceed the PowerTrax load capacity, as it may result in possible operator injury or damage to the unit.
- The PowerTrax should never be operated unmanned.
- Keep long hair and loose clothing pulled up to prevent it from becoming caught in moving parts.
- Keep feet clear of the drive wheels at all times.
- Broken or worn parts must be immediately replaced.
- Properly trained and qualified technicians must service the PowerTrax and its electrical systems.
- Never service the PowerTrax with the power applied. Always disconnect power before servicing equipment.

Operating Instructions

- 1) Check the travel path and verify that it is clear.
- 2) Select the appropriate speed by turning the knob next to the power switch (maximum speed is approximately normal walking speed, or 50 feet per minute).
- 3) Push and hold down the momentary rocker switch on top of the handle to move the PowerTrax.
- 4) When the switch is released, the PowerTrax will stop.
- 5) Use the side handles and front handle to steer the PowerTrax
- 6) On the powered-roller models of PowerTrax, the roller speed and related functions are controlled on the conveyor system.

Standard Features

- **Parallel Shaft DC Drive Motor**
HP Rating: ¼ hp
Maximum Safe Torque: 250.0 in/lbs.
Maximum Voltage: 90V
Maximum Amperage: 2.2A
- **Solid State DC Motor Speed Controller**
HP Rating: 1 hp at 115V and 2 hp at 230V AC
Maximum Voltage: 90V
Maximum Amperage: 11.0A
- **Speed of the unit is 0 to 50 feet per minute**
- **Roller Bed Speed (1.9” rollers)**
Motor speed is 0 to 120 feet per minute
- **Chassis is all steel construction.**
- **Wheels are 12” x 4” pneumatic slicks in back and 8” swivel casters in front.**
- **Standard height adjustment is 27 to 37 inches.**
- **Emergency Stop Switch**

Options

- 1) **Manual Package Stop** – Manually stops packages at the end of the roller bed.
- 2) **Optics** – Electronically stops packages at the end of the roller bed.

PowerTrax

Troubleshooting Guide

Motor Controller and Motor

Symptom	Possible Cause	Corrective Action
1. Motor does not run; power ON indicator not lit.	1. Power Switch in Off position, Or AC voltage not brought to L1, L2 terminals in controller.	1. Move power switch to ON position. Correct wiring to controller.
	2. Blown Fuse	2. Replace line fuse with 12 Amp rated 3AB-type fuse. If blew due to miss wiring, speed control module may be defective.
	3. Speed control knob set to 0	3. Turn knob CW to start motor
	4. Defective motor	4. Check the defective motor, worn brushes, etc. Replace motor.
	5. Plug-In Horespower Resistor not installed.	5. Install proper size Plug-in Horespower Resistor.
2. Motor hums, or runs at very low speed (with control knob set at high number) or motor slows down substantially when load is applied.	1. Low voltage.	1. Check line voltage at controller and rewire rewire as required.
	2. Overload condition; control in current limit mode (CL) (trimpot not set correctly).	2. Reduce loading; CL trimpot setting may have to be increased.
	3. Plug-In Horsepower Resistor not correct size.	3. Install proper size resistor.
	4. Incorrect wiring. Armature and shunt connections interchanged. (shunt motor only).	4. Correct wiring (armature has lower resistance than field).
3. Erratic motor performance	1. Defective motor, worn brushes etc.	1. Repair motor.
	2. Overload condition.	2. Remove overload.
	3. Plug-In Horsepower Resistor wrong size.	3. Replace with proper size.
	4. IR comp and/or CL trimpots not set properly.	4. Readjust trimpots.
	5. Defective speed control module.	5. Replace module.
4. Motor continues to run when speed control knob is set to 0.	1. Min speed trimpot not set to full CCW position.	1. readjust min. trimpot.
	2. IR comp trimpot set too high.	2. Lower IR comp trimpot setting.
5. Motor will not run in either forward or reverse direction.	1. Incorrect wiring or faulty reversing switch.	1. Correct wiring.
	2. Defective APRM.	2. Replace APRM.

PowerTrax

Troubleshooting Guide (Cont.)

6. No Braking action in brake mode.	1. Incorrect wiring.	1. Correct wiring.
	2. Defective brake resistor.	2. Replace resistor.
	3. Defective APRM.	3. Replace APRM.
7. Motor runs in wrong direction.	1. Armature leads reversed.	1. Reconnect armature leads.

Maintenance Schedule

The PowerTrax is virtually maintenance free, however, we do recommend the following:

- Keep the PowerTrax clean and free of debris, dirt and grease accumulation.
- Inspect belts for wear (in power applications). Replace excessively worn belts.
- Make sure photoeyes are clean and unobstructed (in Accumulation and Photo Eye Package Stop applications).
- Test all EMERGENCY STOP pushbuttons to verify proper operation.
- Check the chain tension.

All of the above maintenance inspections should be conducted daily.

Page intentionally left blank

PowerTrax Parts			PowerTrax Parts		
Item	Part #	Description	Item	Part #	Description
1	10010	SCREW HHC 1/4-20X3/4	48	70242	SPRCKET 35B17 3/4 BORE
2	10011	SCREW HHC 1/4-28X1	49	99020	DECAL SHOCK HAZARD
3	10035	SCREW HHC 3/8-16X3/4	50	See Dwg	Control Enclosure
4	10042	SCREW HHC 3/8-16X1	51	400803	Control Enclosure Guard
5	10061	SCREW HHC 1/2-13X1-1/4	52	10530-2	SCREW RHM #10-32 X 3/4
6	10532	SCREW, #6X1/2 PAN HD	53	11279-1	NUT HEX #10-32
7	10580	BOLT CARR 5/16-18X1	54	15010-N	NUT CONN CABL/BOX 1/2 NPT
8	10676	BOLT CARR 3/8-16X1	55	15012-1	STRAIN RELIEF 16/3 WIRE
9	11110	LOCKNUT NYL 1/4	56	15030-3	SCREW RHM #8-32 X 3/4
10	11122	LOCKNUT NYL NTE 5/16-18	57	15036-1	HANDY BOX 1/2 KO 2 1/8 DP
11	11260	LOCKNUT T-WAY 1/2	58	15037-1	CORD ELEC 14/3 SJ 300V
12	11279	NUT #8-32	59	15037-3	CORD ELECT 16/4 SO
13	11490	NUT FLANGE 3/8-16 SERRATD	60	15045-15	FUSE 15AMP 250VOLT CERMIC
14	11999	WASHER FLAT 3/16	61	1-90057	ENCLOSURE POWER SUPPLY
15	12000	WASHER FLAT 1/4"	62	1-90065	KNOB/DIAL KIT KB CONTROL
16	12020	WASHER FLAT 3/8"	63	1-90155	SCREW #12X1/2 TYPE A
17	12030	WASHER FLAT 1/2"	64	8-14100	CAP LEG 1 1/2 X3X14GA
18	12085	WASHER FLAT 5/16"	65	8-15501	SWITCH, EATON#8006K32N1V2
19	12107	NIPPLE GALV 1/2X1 1/2	66	8-21001	BEARING FLANGE 1-3/8 BORE
20	12120	WASHER LOCK 3/16	67	8-21003	HANDLE PULL
21	12121	WASHER LOCK 1/4"	68	8-44001	W END CAP 30"
22	12130	WASHER LOCK 3/8"	69	8-44002	W END CAP 24"
23	12185	SPAC 3/40DX13/32IDX.200	70	8-44003	W LEG CASTER
24	12460	BELT .156X11 15/16 POLYPRO	71	8-44004	W HANDLE LH
25	12466	BELT .210X13 3/16 DRIVE	72	8-44005	W HANDLE RH
26	12549	RESIST/FUS KT .05 OHM/4A	73	8-44010	W MOTOR SUPP PT 24" PF
27	12560	KEY 1/4 SQX1	74	8-44011	W MOTOR SUPP PT 30" PF
28	12589	PIN CLIP 3/8X1-3/8	75	8-51001	ROLLER 1.9X23 POP-IN
29	12590	CLIP PIN 3/8X1-3/4	76	8-51002	ROLLER 1.9X28 5/8 POP-IN
30	12749	CHAIN #35	77	85-61041	SIDE MEMBER RH
31	12750	CHAIN MASTER LINK #35	78	85-61042	SIDE MEMBER LH
32	14069	LEG CAP 1" SQR/14 GA	79	8-61005	MAIN FRAME POWER TRAX
33	15004	CYCLER VARIABLE SPEED	80	8-61009	CHANNEL ADJUSTMENT FRONT
34	15011	OLIFLEX COMP.FTG. 16/3	81	8-61010	CHANNEL ADJUSTMENT REAR
35	15015	TERM FORK#10STUD 16-14GAB	82	8-61020	CAP LEG 1 1/2X3X17GA
36	15016	TERM RING .25STUD 16-14GA	83	8-61021	WHEEL ASSY REWORKED
37	15017	TERM FEM DISC 16-14 .25TA	84	8-61029	MOTOR MNT. REWORKED
38	15023	PLUG M TL 15/10A 125V/250V	85	8-61039	CASTER 8X2 REWORKED
39	15024	PLUG M 15A/125V 2P/3 WIRE	86	8-61044	HEYCO CAP PLUG
40	15025	CABLE TIE 7 3/8L, 3/16W	87	8-61045	FRAME STIFFENER
41	15026	WIRE NUT (YELLOW) HI-Y	88	8-70000	SPROCKET 35B42 REWORKEDR
42	15037	CORD ELECT 16/3 SO 600V	89	8-96000	AXLE POWER TRAX 24"
43	15060	RELAY #C25BNB225A SER C1	90	8-96001	AXLE POWER TRAX 30"
44	15108	EL 90 PULL 1/2 CONDUIT	91	8-99901	DECAL POWER TRAX
45	19006	PULLEY DRIVE DBL GROOVE	92	8-99902	DECAL POWER TRAX
46	70236	MOTOR,1/8 HP 180V DC	93	8-99903	DECAL RUN (FRWRD/RVRS)
47	70247	MOTOR 1/4 HP DC P/FLX 50			

PowerTrax 30" Gravity

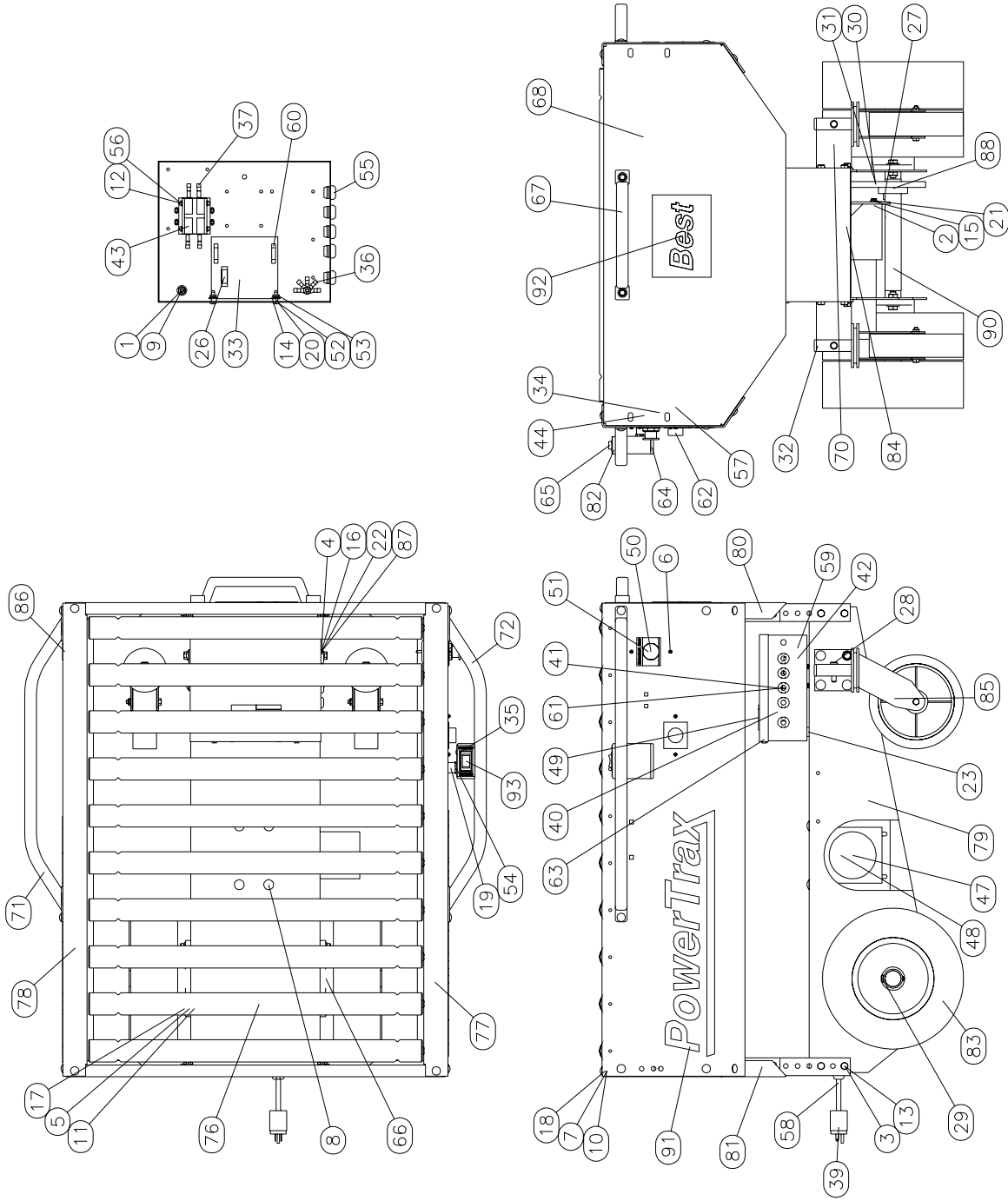

PowerTrax Parts			PowerTrax Parts		
Item	Part #	Description	Item	Part #	Description
1	10010	SCREW HHC 1/4-20X3/4	48	70242	SPRCKET 35B17 3/4 BORE
2	10011	SCREW HHC 1/4-28X1	49	99020	DECAL SHOCK HAZARD
3	10035	SCREW HHC 3/8-16X3/4	50	See Dwg	Control Enclosure
4	10042	SCREW HHC 3/8-16X1	51	400803	Control Enclosure Guard
5	10061	SCREW HHC 1/2-13X1-1/4	52	10530-2	SCREW RHM #10-32 X 3/4
6	10532	SCREW, #6X1/2 PAN HD	53	11279-1	NUT HEX #10-32
7	10580	BOLT CARR 5/16-18X1	54	15010-N	NUT_CONN CABL/BOX 1/2 NPT
8	10676	BOLT CARR 3/8-16X1	55	15012-1	STRAIN RELIEF 16/3 WIRE
9	11110	LOCKNUT NYL 1/4	56	15030-3	SCREW RHM #8-32 X 3/4
10	11122	LOCKNUT NYL NTE 5/16-18	57	15036-1	HANDY BOX 1/2 KO 2 1/8 DP
11	11260	LOCKNUT T-WAY 1/2	58	15037-1	CORD ELEC 14/3 SJ 300V
12	11279	NUT #8-32	59	15037-3	CORD ELECT 16/4 SO
13	11490	NUT FLANGE 3/8-16 SERRTD	60	15045-15	FUSE 15AMP 250VOLT CERMIC
14	11999	WASHER FLAT 3/16	61	1-90057	ENCLOSURE POWER SUPPLY
15	12000	WASHER FLAT 1/4"	62	1-90065	KNOB/DIAL KIT KB CONTROL
16	12020	WASHER FLAT 3/8"	63	1-90155	SCREW #12X1/2 TYPE A
17	12030	WASHER FLAT 1/2"	64	8-14100	CAP LEG 1 1/2 X3X14GA
18	12085	WASHER FLAT 5/16"	65	8-15501	SWITCH, EATON#8006K32N1V2
19	12107	NIPPLE GALV 1/2X1 1/2	66	8-21001	BEARING FLANGE 1-3/8 BORE
20	12120	WASHER LOCK 3/16	67	8-21003	HANDLE PULL
21	12121	WASHER LOCK 1/4"	68	8-44001	W END CAP 30"
22	12130	WASHER LOCK 3/8"	69	8-44002	W END CAP 24"
23	12185	SPAC 3/4ODX13/32IDX.200	70	8-44003	W LEG CASTER
24	12460	BELT .156X11 15/16 POLYPRO	71	8-44004	W HANDLE LH
25	12466	BELT .210X13 3/16 DRIVE	72	8-44005	W HANDLE RH
26	12549	RESIST/FUS KT .05 OHM/4A	73	8-44010	W MOTOR SUPP PT 24" PF
27	12560	KEY 1/4 SQX1	74	8-44011	W MOTOR SUPP PT 30" PF
28	12589	PIN CLIP 3/8X1-3/8	75	8-51001	ROLLER 1.9X2.3 POP-IN
29	12590	CLIP PIN 3/8X1-3/4	76	8-51002	ROLLER 1.9X2.8 5/8 POP-IN
30	12749	CHAIN #35	77	85-61041	SIDE MEMBER RH
31	12750	CHAIN MASTER LINK #35	78	85-61042	SIDE MEMBER LH
32	14069	LEG CAP 1" SQR/14 GA	79	8-61005	MAIN FRAME POWER TRAX
33	15004	CYCLER VARIABLE SPEED	80	8-61009	CHANNEL ADJUSTMENT FRONT
34	15011	OLFLEX COMP.FTG. 16/3	81	8-61010	CHANNEL ADJUSTMENT REAR
35	15015	TERM FORK#105TUD 16-14GAB	82	8-61020	CAP LEG 1 1/2X3X17GA
36	15016	TERM RING .25STUD 16-14GA	83	8-61021	WHEEL ASSY REWORKED
37	15017	TERM FEM DISC 16-14 .25TA	84	8-61029	MOTOR MNT. REWORKED
38	15023	PLUG M TL 15/10A 125/250V	85	8-61039	CASTER 8X2 REWORKED
39	15024	PLUG M 15A/125V 2P/3 WIRE	86	8-61044	HEYCO CAP PLUG
40	15025	CABLE TIE 7 3/8L, 3/16W	87	8-61045	FRAME STIFFENER
41	15026	WIRE NUT (YELLOW) HI-Y	88	8-70000	SPROCKET 35B42 REWORKEDR
42	15037	CORD ELECT 16/3 SO 600V	89	8-96000	AXLE POWER TRAX 24"
43	15060	RELAY #C25BNB225A SER C1	90	8-96001	AXLE POWER TRAX 30"
44	15108	EL 90 PULL 1/2 CONDUIT	91	8-99901	DECAL POWER TRAX
45	19006	PULLEY DRIVE DBL GROOVE	92	8-99902	DECAL POWER TRAX
46	70236	MOTOR 1/8 HP 180V DC	93	8-99903	DECAL RUN (FRWRD/RVRS)
47	70247	MOTOR 1/4 HP DC P/FLX 50			

PowerTrax 24" Power

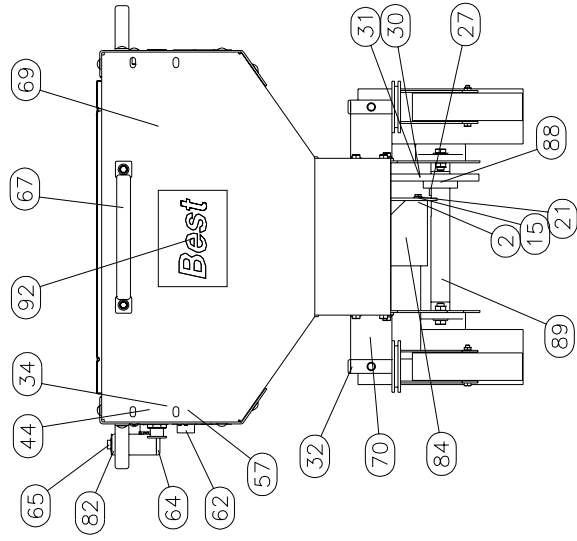
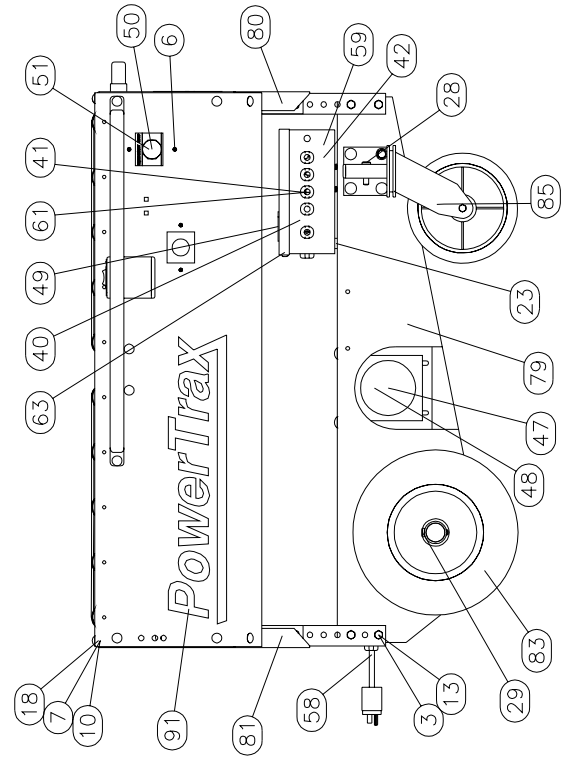
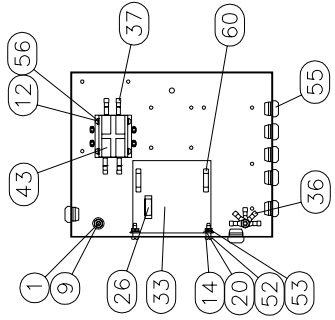
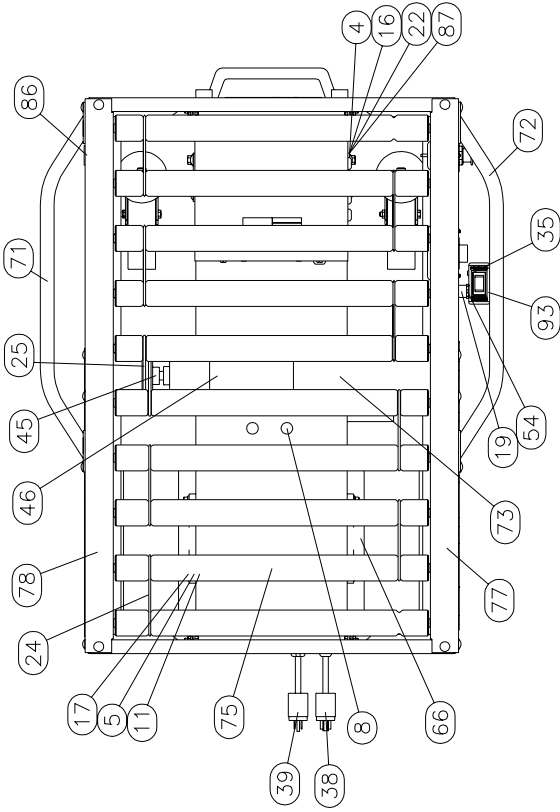

PowerTrax Parts			PowerTrax Parts		
Item	Part #	Description	Item	Part #	Description
1	10010	SCREW HHC 1/4-20X3/4	48	70242	SPRCKET 35B17 3/4 BORE
2	10011	SCREW HHC 1/4-28X1	49	99020	DECAL SHOCK HAZARD
3	10035	SCREW HHC 3/8-16X3/4	50	See Dwg	Control Enclosure
4	10042	SCREW HHC 3/8-16X1	51	400803	Control Enclosure Guard
5	10061	SCREW HHC 1/2-13X1-1/4	52	10530-2	SCREW RHM #10-32 X 3/4
6	10532	SCREW, #6X1/2 PAN HD	53	11279-1	NUT HEX #10-32
7	10580	BOLT CARR 5/16-18X1	54	15010-N	NUT CONN CABL/BOX 1/2 NPT
8	10676	BOLT CARR 3/8-16X1	55	15012-1	STRAIN RELIEF 16/3 WIRE
9	11110	LOCKNUT NYL 1/4	56	15030-3	SCREW RHM #8-32 X 3/4
10	11122	LOCKNUT NYL NTE 5/16-18	57	15036-1	HANDY BOX 1/2 KO 2 1/8 DP
11	11260	LOCKNUT T-WAY 1/2	58	15037-1	CORD ELEC 14/3 SJ 300V
12	11279	NUT #8-32	59	15037-3	CORD ELECT 16/4 SO
13	11490	NUT FLANGE 3/8-16 SERRATD	60	15045-15	FUSE 15AMP 250VOLT CERMIC
14	11999	WASHER FLAT 3/16	61	1-90057	ENCLOSURE POWER SUPPLY
15	12000	WASHER FLAT 1/4"	62	1-90065	KNOB/DIAL KIT KB CONTROL
16	12020	WASHER FLAT 3/8"	63	1-90155	SCREW #12X1/2 TYPE A
17	12030	WASHER FLAT 1/2"	64	8-14100	CAP LEG 1 1/2 X3X14GA
18	12085	WASHER FLAT 5/16"	65	8-15501	SWITCH, Eaton#8006K32N1V2
19	12107	NIPPLE GALV 1/2X1 1/2	66	8-21001	BEARING FLANGE 1-3/8 BORE
20	12120	WASHER LOCK 3/16	67	8-21003	HANDLE PULL
21	12121	WASHER LOCK 1/4"	68	8-44001	W END CAP 30"
22	12130	WASHER LOCK 3/8"	69	8-44002	W END CAP 24"
23	12185	SPAC 3/40DX13/32IDX.200	70	8-44003	W LEG CASTER
24	12460	BELT .156X11.15/16 POLYPRO	71	8-44004	W HANDLE LH
25	12466	BELT .210X13 3/16 DRIVE	72	8-44005	W HANDLE RH
26	12549	RESIST/FUS KT .05 OHM/4A	73	8-44010	W MOTOR SUPP PT 24" PF
27	12560	KEY 1/4 SQX1	74	8-44011	W MOTOR SUPP PT 30" PF
28	12589	PIN CLIP 3/8X1-3/8	75	8-51001	ROLLER 1.9X23 POP-IN
29	12590	CLIP PIN 3/8X1-3/4	76	8-51002	ROLLER 1.9X28 5/8 POP-IN
30	12749	CHAIN #35	77	85-61041	SIDE MEMBER RH
31	12750	CHAIN MASTER LINK #35	78	85-61042	SIDE MEMBER LH
32	14069	LEG CAP 1" SQ/14 GA	79	8-61005	MAIN FRAME POWER TRAX
33	15004	CYCLER VARIABLE SPEED	80	8-61009	CHANNEL ADJUSTMENT FRONT
34	15011	OLFLX COMP.FTG. 16/3	81	8-61010	CHANNEL ADJUSTMENT REAR
35	15015	TERM FORK#105TUD 16-14GAB	82	8-61020	CAP LEG 1 1/2X3X17GA
36	15016	TERM RING .25STUD 16-14GA	83	8-61021	WHEEL ASSY REWORKED
37	15017	TERM FEM DISC 16-14 .25TA	84	8-61029	MOTOR MNT. REWORKED
38	15023	PLUG M TL 15/10A 125/250V	85	8-61039	CASTER 8X2 REWORKED
39	15024	PLUG M 15A/125V 2P/3 WIRE	86	8-61044	HEYCO CAP PLUG
40	15025	CABLE TIE 7 3/8L, 3/16W	87	8-61045	FRAME STIFFENER
41	15026	WIRE NUT (YELLOW) HI-Y	88	8-70000	SPROCKET 35B42 REWORKEDR
42	15037	CORD ELECT 16/3 SO 600V	89	8-96000	AXLE POWER TRAX 24"
43	15060	RELAY #C25BMB225A SER C1	90	8-96001	AXLE POWER TRAX 30"
44	15108	TEL 90 PULL 1/2 CONDUIT	91	8-99901	DECAL POWER TRAX
45	19006	PULLEY DRIVE DBL GROOVE	92	8-99902	DECAL POWER TRAX
46	70236	MOTOR, 1/8 HP 180V DC	93	8-99903	DECAL RUN (FRWRD/RVRS)
47	70247	MOTOR 1/4 HP DC P/FLX 50			

PowerTrax Parts			PowerTrax Parts		
Item	Part #	Description	Item	Part #	Description
1	10010	SCREW HHC 1/4-20X3/4	48	70242	SPRCKET 35B17 3/4 BORE
2	10011	SCREW HHC 1/4-28X1	49	99020	DECAL SHOCK HAZARD
3	10035	SCREW HHC 3/8-16X3/4	50	See Dwg	Control Enclosure
4	10042	SCREW HHC 3/8-16X1	51	400803	Control Enclosure Guard
5	10061	SCREW HHC 1/2-13X1-1/4	52	10530-2	SCREW RHM #10-32 X 3/4
6	10532	SCREW #6X1/2 PAN HD	53	11279-1	NUT HEX #10-32
7	10580	BOLT CARR 5/16-18X1	54	15010-N	NUT CONN CABL/BOX 1/2 NPT
8	10676	BOLT CARR 3/8-16X1	55	15012-1	STRAIN RELIEF 16/3 WIRE
9	11110	LOCKNUT NYL 1/4	56	15030-3	SCREW RHM #8-32 X 3/4
10	11122	LOCKNUT NYL NTE 5/16-18	57	15036-1	HANDY BOX 1/2 KO 2 1/8 DP
11	11260	LOCKNUT T-WAY 1/2	58	15037-1	CORD ELEC 14/3 SJ 300V
12	11279	NUT #8-32	59	15037-3	CORD ELECT 16/4 SO
13	11490	NUT FLANGE 3/8-16 SERRATD	60	15045-15	FUSE 15AMP 250VOLT CERMIC
14	11999	WASHER FLAT 3/16	61	1-90057	ENCLOSURE POWER SUPPLY
15	12000	WASHER FLAT 1/4"	62	1-90065	KNOB/DIAL KIT KB CONTROL
16	12020	WASHER FLAT 3/8"	63	1-90155	SCREW #12X1/2 TYPE A
17	12030	WASHER FLAT 1/2"	64	8-14100	CAP LEG 1 1/2 X3X14GA
18	12085	WASHER FLAT 5/16"	65	8-15501	SWITCH, EATON#8006K32N1V2
19	12107	NIPPLE GALV 1/2X1 1/2	66	8-21001	BEARING FLANGE 1-3/8 BORE
20	12120	WASHER LOCK 3/16	67	8-21003	HANDLE PULL
21	12121	WASHER LOCK 1/4"	68	8-44001	W END CAP 30"
22	12130	WASHER LOCK 3/8"	69	8-44002	W END CAP 24"
23	12185	SPAC 3/4ODX1.3/32IDX.200	70	8-44003	W LEG CASTER
24	12460	BELT .156X1.1 15/16 POLYPRO	71	8-44004	W HANDLE LH
25	12466	BELT .210X1.3 3/16 DRIVE	72	8-44005	W HANDLE RH
26	12549	RESIST/FUS KT .05 OHM/4A	73	8-44010	W MOTOR SUPP PT 24" PF
27	12560	KEY 1/4 SQX1	74	8-44011	W MOTOR SUPP PT 30" PF
28	12589	PIN CLIP 3/8X1-3/8	75	8-51001	ROLLER 1.9X23 POP-IN
29	12590	CLIP PIN 3/8X1-3/4	76	8-51002	ROLLER 1.9X28 5/8 POP-IN
30	12749	CHAIN #35	77	85-61041	SIDE MEMBER RH
31	12750	CHAIN MASTER LINK #35	78	85-61042	SIDE MEMBER LH
32	14069	LEG CAP 1" SQR/14 GA	79	8-61005	MAIN FRAME POWER TRAX
33	15004	CYCLER VARIABLE SPEED	80	8-61009	CHANNEL ADJUSTMENT FRONT
34	15011	OLIFLEX COMP.FTG. 16/3	81	8-61010	CHANNEL ADJUSTMENT REAR
35	15015	TERM FORK#10STUD 16-14GAB	82	8-61020	CAP LEG 1 1/2X3X17GA
36	15016	TERM RING .25STUD 16-14GA	83	8-61021	WHEEL ASSY REWORKED
37	15017	TERM FEM DISC 16-14 .25TA	84	8-61029	MOTOR MNT. REWORKED
38	15023	PLUG M TL 15/10A 125/250V	85	8-61039	CASTER 8X2 REWORKED
39	15024	PLUG M 15A/125V 2P/3 WIRE	86	8-61044	HEYCO CAP PLUG
40	15025	CABLE TIE 7 3/8L 3/16W	87	8-61045	FRAME STIFFENER
41	15026	WIRE NUT (YELLOW) HI-Y	88	8-70000	SPROCKET 35B42 REWORKEDR
42	15037	CORD ELECT 16/3 SO 600V	89	8-96000	AXLE POWER TRAX 24"
43	15060	RELAY #C25BMB25A SER C1	90	8-96001	AXLE POWER TRAX 30"
44	15108	EL 90 PULL 1/2 CONDUIT	91	8-99901	DECAL POWER TRAX
45	19006	PULLEY DRIVE DBL GROOVE	92	8-99902	DECAL POWER TRAX
46	70236	MOTOR, 1/8 HP 180V DC	93	8-99903	DECAL RUN (FRWRD/RVRS)
47	70247	MOTOR, 1/4 HP DC P/FLX 50			

Accumulation Photo Eye Kit, 24"

Photo Eye Kit Parts			Quantity
Item	Part #	Description	24" Photo Eye Kit 8-06103
1	10010	SCREW HHC 1/4-20X3/4	4
2	10532	SCREW, #6X1/2 PAN HD	0
3	10576	BOLT CAR 1/4-20X 3/4"	4
4	11110	LOCKNUT NYL 1/4"	8
5	11278	NUT MACH SCREW #12-24	0
6	12000	WASHER FLAT 1/4"	4
7	15016	TERM RING .25STUD 16-14GA	1
8	15017	TERM FEM DISC 16-14 .25TA	6
9	15025	CABLE TIE 7 3/8L, 3/16W	4
10	15026	WIRE NUT (YELLOW) HI-Y	3
11	15037-5	CORD ELECT 16/5 SO	6
12	15048	ENCLOSE 6X4X4 SCREW W/CVR	1
13	15050-2	PHOTO-EYE DEFUSED 18MM	3
14	15054	COMP FIT C&I#SLRN-3/4 NPT	3
15	15055	NUT COMP FIT 3/4" NPT	3
16	15062	TW LK MA 5 PR (#2021P)	1
17	15063	TW LK FM 5 PR (#2021C)	1
18	1-90024	22AWG/3C CABLE	3
19	8-61024	CHANNEL PHOTO-EYES 24"	1
20	8-61025	CHANNEL PHOTO-EYES 30"	0
21	8-61030	ANGLE CHANNEL MT	2

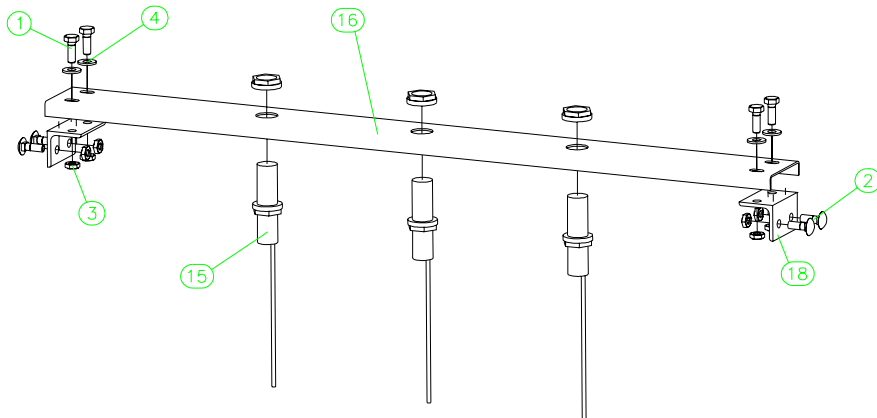

Located in PowerTrax Electrical Enclosure

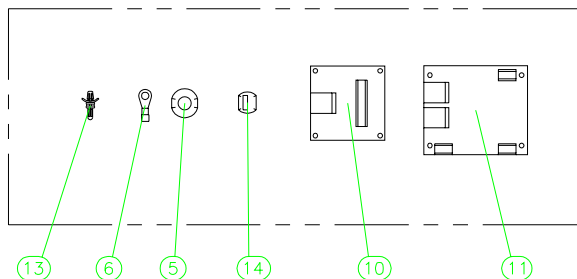

Accumulation Photo Eye Kit, 30"

Photo Eye Kit Parts			Quantity
Item	Part #	Description	30" Photo Eye Kit 8-06102
1	10010	SCREW HHC 1/4-20X3/4	4
2	10532	SCREW, #6X1/2 PAN HD	2
3	10576	BOLT CAR 1/4-20X 3/4"	4
4	11110	LOCKNUT NYL 1/4"	8
5	11278	NUT MACH SCREW #12-24	2
6	12000	WASHER FLAT 1/4"	4
7	15016	TERM RING .25STUD 16-14GA	1
8	15017	TERM FEM DISC 16-14 .25TA	6
9	15025	CABLE TIE 7 3/8L, 3/16W	4
10	15026	WIRE NUT (YELLOW) HI-Y	3
11	15037-5	CORD ELECT 16/5 SO	0
12	15048	ENCLOSE 6X4X4 SCREW W/CVR	1
13	15050-2	PHOTO-EYE DEFUSED 18MM	4
14	15054	COMP FIT C&I#SLRN-3/4 NPT	3
15	15055	NUT COMP FIT 3/4" NPT	3
16	15062	TW LK MA 5 PR (#2021P)	1
17	15063	TW LK FM 5 PR (#2021C)	1
18	1-90024	22AWG/3C CABLE	4
19	8-61024	CHANNEL PHOTO-EYES 24"	0
20	8-61025	CHANNEL PHOTO-EYES 30"	1
21	8-61030	ANGLE CHANNEL MT	2

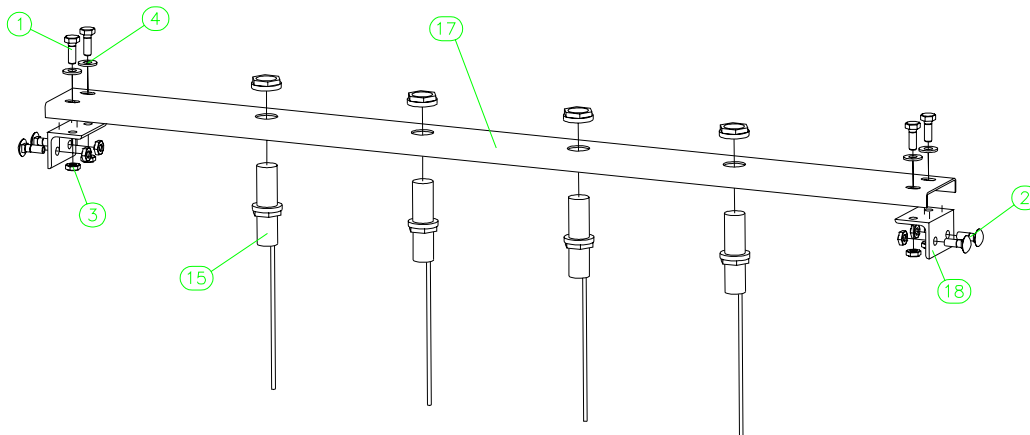

Located in PowerTrax Electrical Enclosure

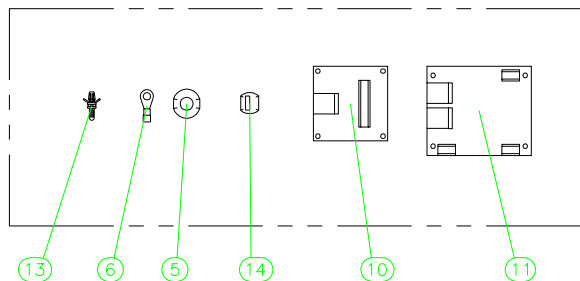
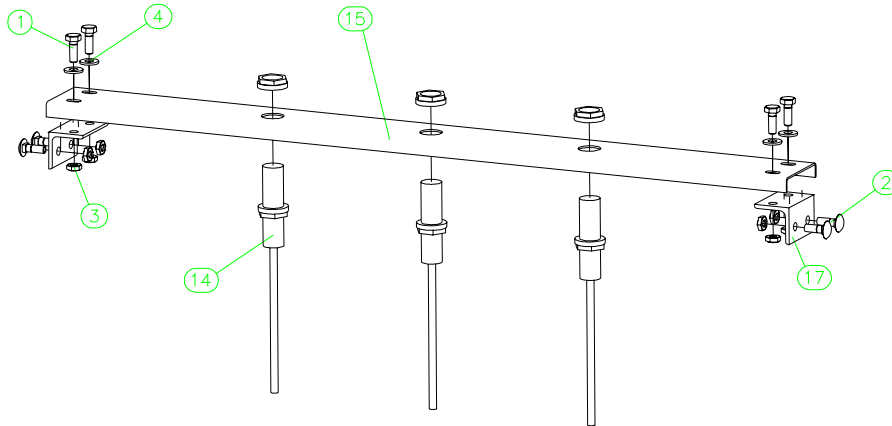

Photo Eye Package Stop Kit, 24"

Photo Eye Kit Parts			Quantity
Item	Part #	Description	24" Photo Eye Kit 8-06103
1	10010	SCREW HHC 1/4-20X3/4	4
2	10532	SCREW, #6X1/2 PAN HD	0
3	10576	BOLT CAR 1/4-20X 3/4"	4
4	11110	LOCKNUT NYL 1/4"	8
5	11278	NUT MACH SCREW #12-24	0
6	12000	WASHER FLAT 1/4"	4
7	15016	TERM RING .25STUD 16-14GA	1
8	15017	TERM FEM DISC 16-14 .25TA	6
9	15025	CABLE TIE 7 3/8L, 3/16W	4
10	15026	WIRE NUT (YELLOW) HI-Y	3
11	15037-5	CORD ELECT 16/5 SO	6
12	15048	ENCLOSE 6X4X4 SCREW W/CVR	1
13	15050-2	PHOTO-EYE DEFUSED 18MM	3
14	15054	COMP FIT C&I#SLRN-3/4 NPT	3
15	15055	NUT COMP FIT 3/4" NPT	3
16	15062	TW LK MA 5 PR (#2021P)	1
17	15063	TW LK FM 5 PR (#2021C)	1
18	1-90024	22AWG/3C CABLE	3
19	8-61024	CHANNEL PHOTO-EYES 24"	1
20	8-61025	CHANNEL PHOTO-EYES 30"	0
21	8-61030	ANGLE CHANNEL MT	2



Located in PowerTrax Electrical Enclosure

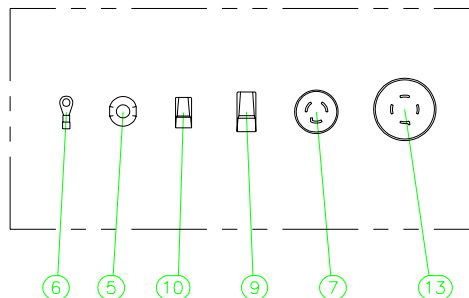
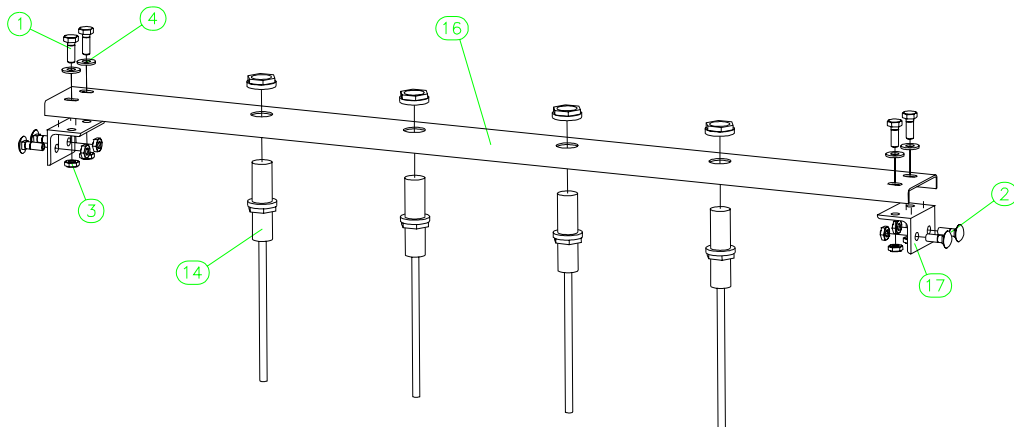
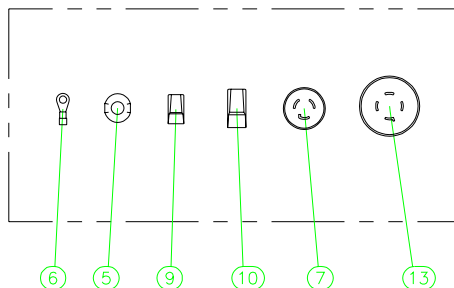

Photo Eye Package Stop Kit, 30"

Photo Eye Kit Parts			Quantity
Item	Part #	Description	30" Photo Eye Kit 8- 06102
1	10010	SCREW HHC 1/4-20X3/4	4
2	10532	SCREW, #6X1/2 PAN HD	2
3	10576	BOLT CAR 1/4-20X 3/4"	4
4	11110	LOCKNUT NYL 1/4	8
5	11278	NUT MACH SCREW #12-24	2
6	12000	WASHER FLAT 1/4"	4
7	15016	TERM RING .25STUD 16-14GA	1
8	15017	TERM FEM DISC 16-14 .25TA	6
9	15025	CABLE TIE 7 3/8L, 3/16W	4
10	15026	WIRE NUT (YELLOW) HI-Y	3
11	15037-5	CORD ELECT 16/5 SO	0
12	15048	ENCLOSE 6X4X4 SCREW W/CVR	1
13	15050-2	PHOTO-EYE DEFUSED 18MM	4
14	15054	COMP FIT C&I#SLRN-3/4 NPT	3
15	15055	NUT COMP FIT 3/4" NPT	3
16	15062	TW LK MA 5 PR (#2021P)	1
17	15063	TW LK FM 5 PR (#2021C)	1
18	1-90024	22AWG/3C CABLE	4
19	8-61024	CHANNEL PHOTO-EYES 24"	0
20	8-61025	CHANNEL PHOTO-EYES 30"	1
21	8-61030	ANGLE CHANNEL MT	2



Located in PowerTrax Electrical Enclosure



Wiring Diagram, Gravity Bed PowerTrax

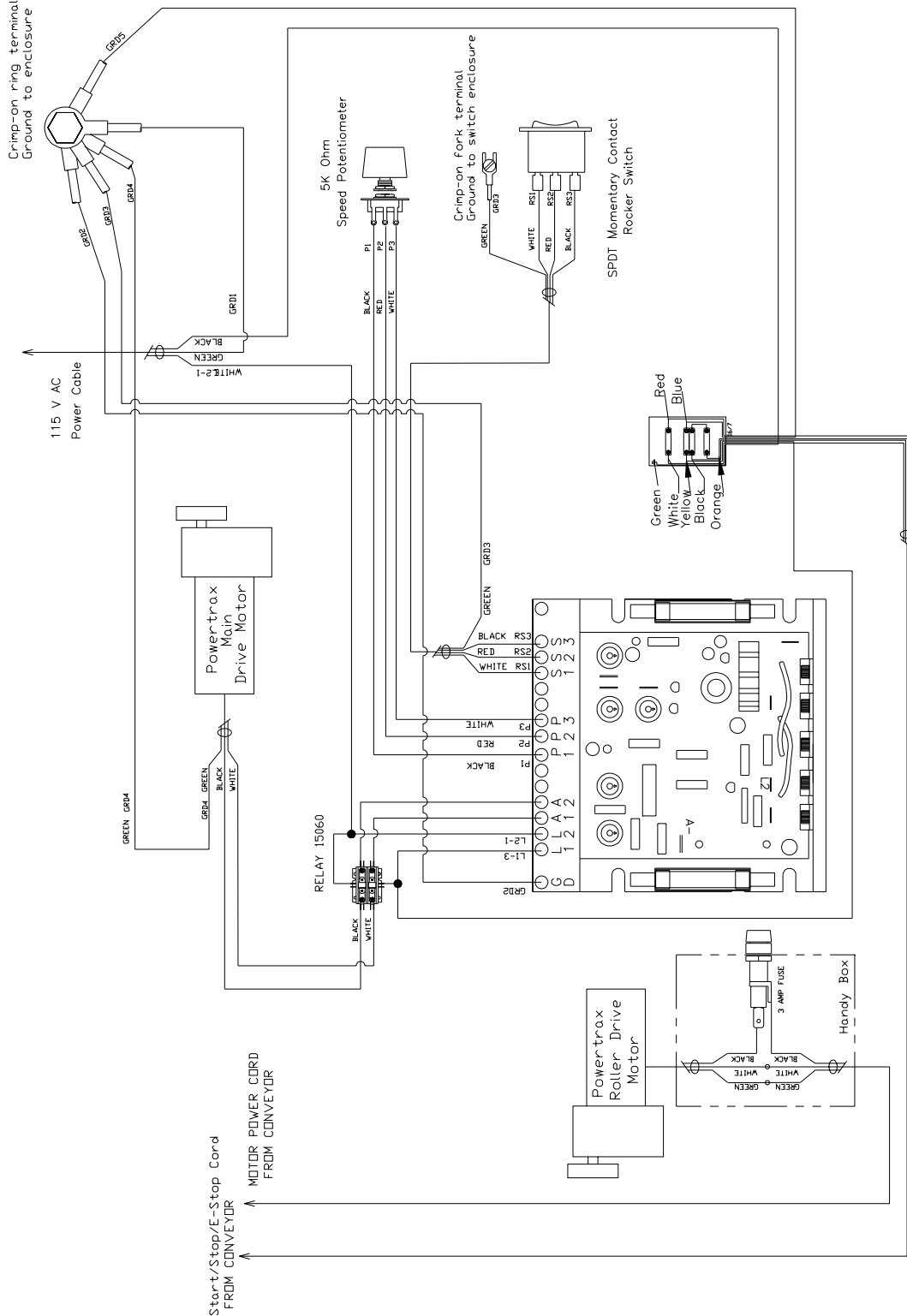

Wiring Diagram, Power Bed PowerTrax

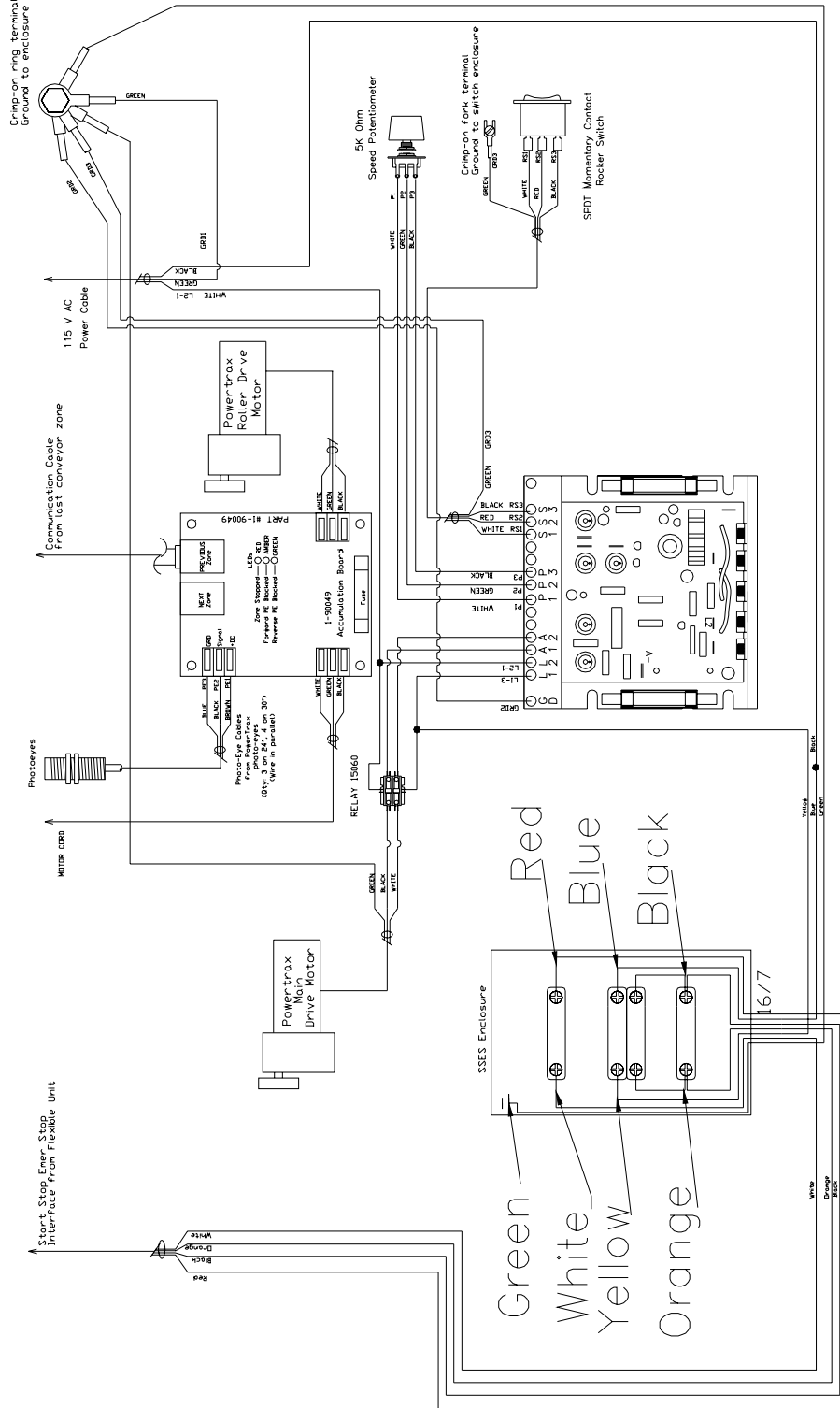

Wiring Diagram, Photo Eye Package Stop

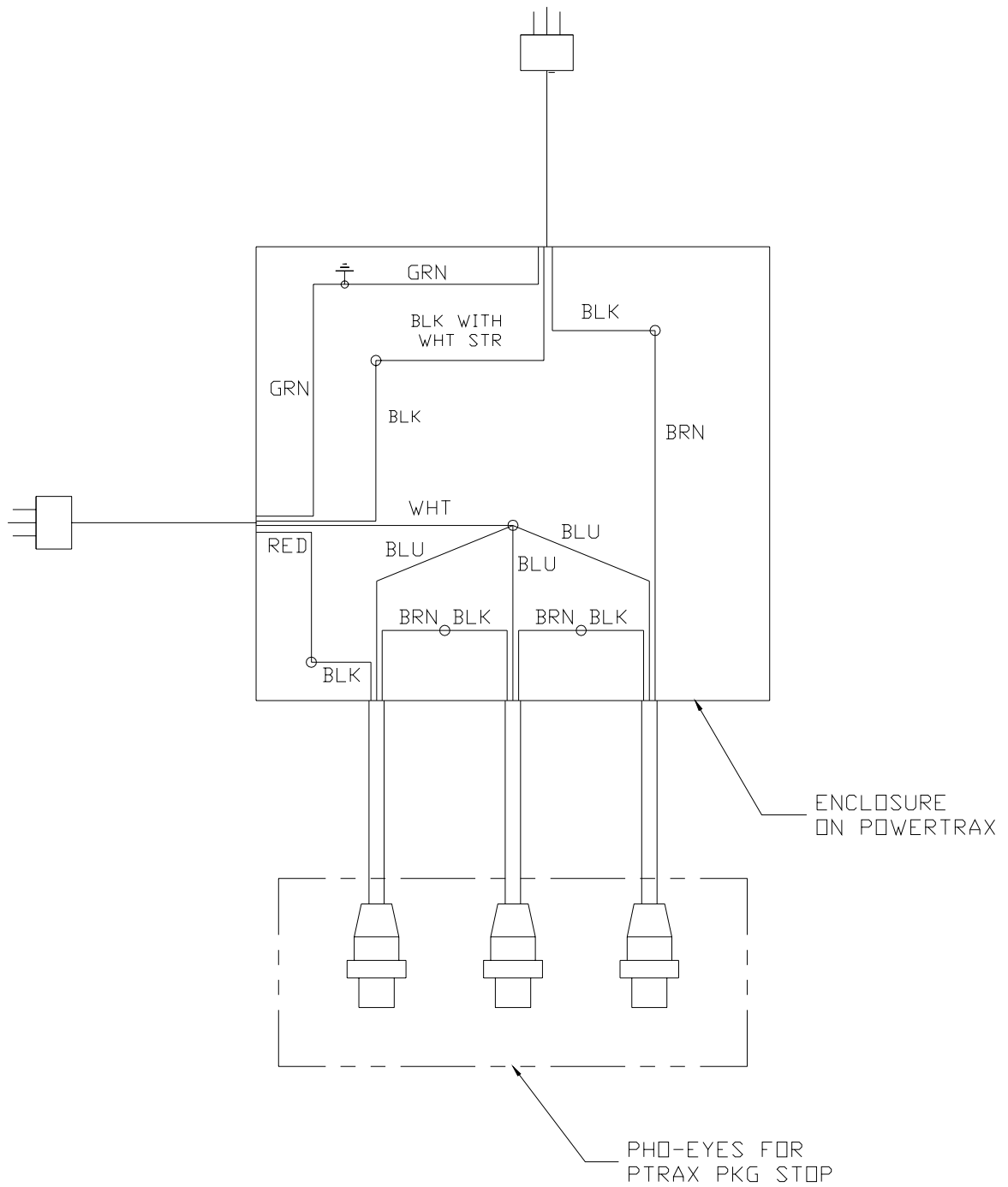

Control Enclosure

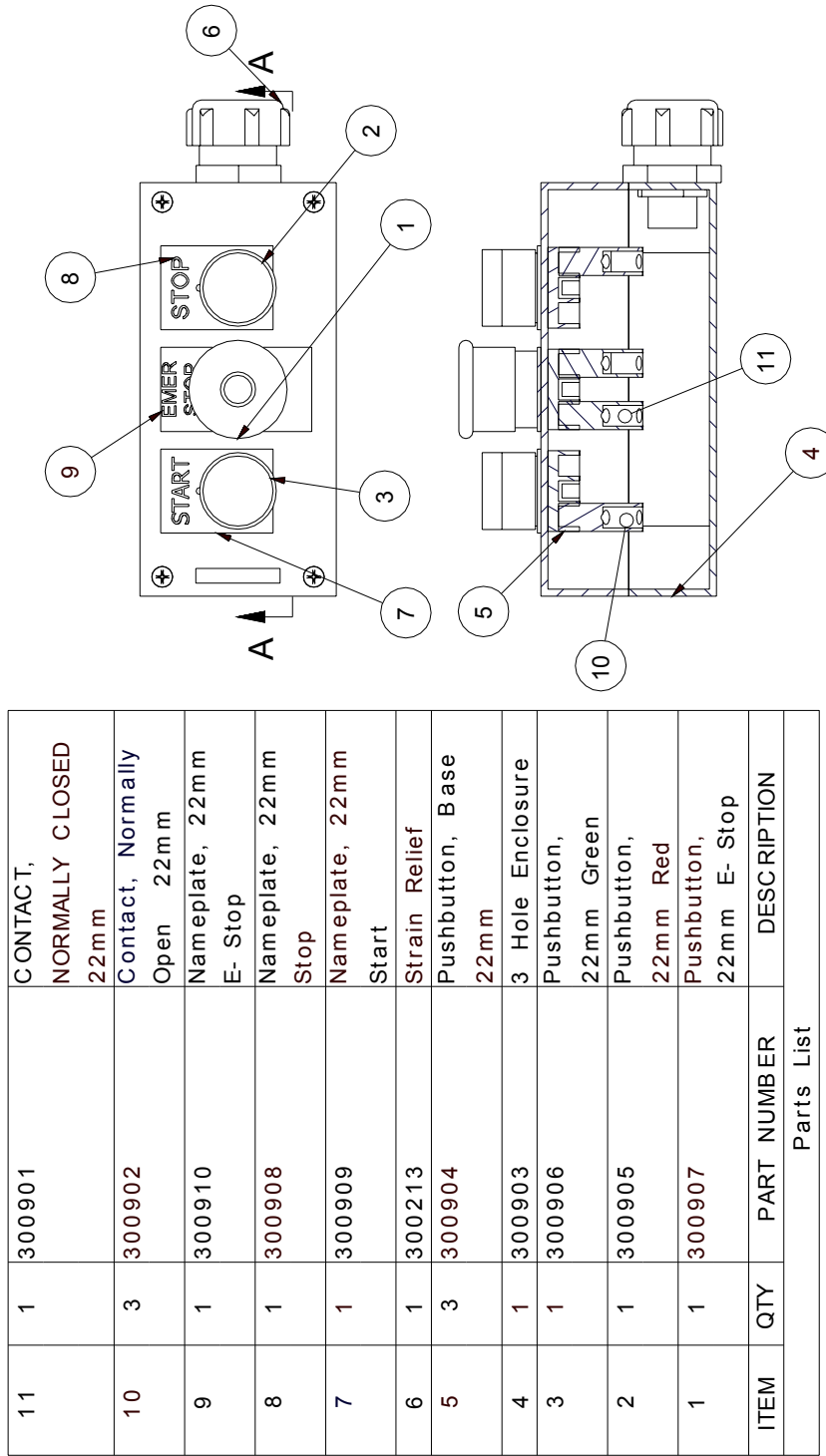

Notes

Best Diversified Products, Inc.

107 Flint St.

Jonesboro, Arkansas 72401

Phone: 870-935-0970

Toll Free: 800-327-9209

Fax: 870-935-3661

Call Best Customer Service

99053