



**Installation and Safety Instructions:**

Conveyor Guard

Model Numbers: 4100019, 4100020

***INSTALLATION & SAFETY INSTRUCTIONS***

***CONVEYOR GUARD  
NETTING SYSTEM***

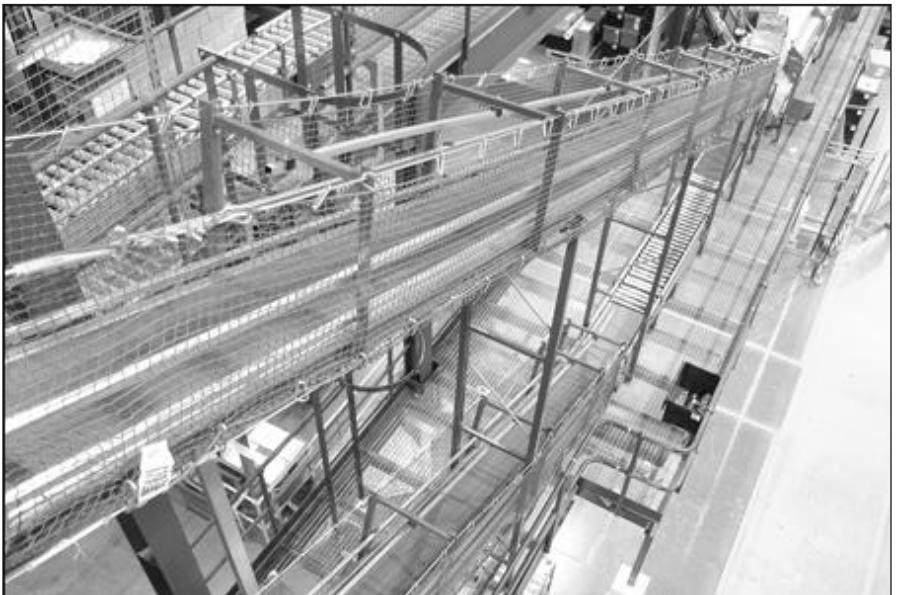

## **SAFETY INSTRUCTIONS**

WITHIN THESE INSTRUCTIONS YOU WILL FIND VARIOUS WARNINGS, CAUTIONS AND NOTES. EACH HAS ITS OWN MEANING.

### ● **DEFINITIONS** ●

**WARNING:** AN OPERATIONAL PROCEDURE OR SAFETY INSTRUCTION WHICH, IF NOT FOLLOWED, COULD RESULT IN INJURY OR LOSS OF LIFE.

**CAUTION:** AN OPERATIONAL PROCEDURE OR SAFETY INSTRUCTION WHICH, IF NOT FOLLOWED, COULD RESULT IN SIGNIFICANT DAMAGE TO EQUIPMENT.

**NOTE:** AN OPERATIONAL OR MAINTENANCE POINT REQUIRING SPECIAL EMPHASIS OR ATTENTION.

### **WARNING**

THESE INSTRUCTIONS CONSTITUTE AN INSTALLATION PROCEDURE THAT MUST BE SUPERVISED. DURING THE INSTALLATION, USE PROPER SAFETY PRECAUTIONS AND PERSONAL PROTECTIVE EQUIPMENT AS DESIGNATED BY YOUR EMPLOYER.

THE ENTIRE CONVEYOR SYSTEM MUST BE INSPECTED PERIODICALLY BY A SUPERVISOR TO ENSURE THAT:

- SNAP HOOKS OR NYLON TIES ARE ATTACHED TO THE BORDER ROPE AND/OR CONVEYOR AT A MINIMUM OF EVERY 12 INCHES.
- NYLON MESH PANEL IS NOT DAMAGED.
- ALL DAMAGED PANELS ARE REPLACED.
- THE CONVEYOR IS NOT DAMAGED.

ALL OPENINGS BETWEEN THE CONVEYOR PANELS AND THE CONVEYOR MUST BE SMALL ENOUGH TO PREVENT GOODS FROM FALLING THROUGH THE OPENINGS.

CHECK ALL ATTACHING POINTS TO ASSURE THEY ARE PROPERLY POSITIONED AND TIGHTENED AS REQUIRED.

**NOTE:** BEFORE CUTTING CABLE MAKE SURE YOU LEAVE ENOUGH CABLE TO FORM END LOOPS WITH WIRE ROPE CLIPS ( ABOUT 1 FOOT FOR EACH END ).

**NOTE:** MAXIMUM SINGLE CABLE RUNS SHOULD NOT EXCEED 200 FT., WHEN CABLE RUNS ARE GREATER THAN THIS, THEY SHOULD BE BROKEN DOWN INTO SECTIONS LESS THAN 200 FT.

**WARNING**

**DO NOT OVER TIGHTEN THE CABLES TO THE POINT WHERE DAMAGE MAY BE CAUSED TO THE CONVEYOR FRAME !**

INSTRUCTIONS FOR CORRECT PLACEMENT OF THE TURNBUCKLES

**NOTE:** TURNBUCKLES ARE ONLY USED ON *HORIZONTAL* RUNS OF CABLE.

- A** CABLE RUNS LESS THAN 30 FT. DO NOT REQUIRE TURNBUCKLES.
- B** CABLE RUNS OF 30 FT. UP TO 70 FT. REQUIRE ONLY ONE SINGLE TURNBUCKLE AT THE START OF THE RUN.
- C** CABLE RUNS GREATER THAN 70 FT. UP TO 200 FT. REQUIRE A SINGLE TURNBUCKLE AT THE START AND AT THE TERMINATION OF EACH RUN.

**WARNING**

**BEFORE MODIFYING ANY CONVEYOR, THE INSTALLER SHOULD CONTACT THE CONVEYOR MANUFACTURER, AN ENGINEER, OR OTHER PERSON QUALIFIED TO DETERMINE IF THE CONVEYOR WILL BE ADVERSELY AFFECTED BY THE INSTALLATION !**

## WARNING

CABLE CLAMPS *MUST* BE INSTALLED CORRECTLY. FAILURE TO MAKE A TERMINATION IN ACCORDANCE WITH THESE INSTRUCTIONS AND FAILURE TO PERIODICALLY INSPECT AND RETIGHTEN TO THE MINIMUM TORQUE WILL CAUSE A REDUCTION IN HOLDING POWER.

- *U-BOLT SECTION* OF THE CLAMP *MUST* BE INSTALLED ON THE DEAD (SHORT) END OF THE CABLE, AND THE *SADDLE* ON THE LIVE (LONG) END.
- REVERSAL OF EVEN ONE CLAMP WILL REDUCE THE HOLDING POWER BY UP TO 40 PERCENT.
- *NEVER* USE CLAMPS TO CONNECT TWO STRAIGHT LENGTHS OF CABLE.

NOTE: FOR MAXIMUM CABLE STRENGTH:

- 1 WRAP THE DEAD END OF THE CABLE AROUND THE THIMBLE TO GIVE THE MINIMUM LENGTH OF 6 1/2". APPLY THE FIRST CLAMP AT 1 5/8" FROM THE DEAD END OF THE CABLE ( AS SHOWN IN THE ILLUSTRATION ). TIGHTEN THE NUTS EVENLY TO THE MINIMUM TORQUE OF 25 FT. LBS.
- 2 APPLY THE NEXT CLAMP AS NEAR THE THIMBLE AS POSSIBLE. TIGHTEN THE NUTS FINGER TIGHT.
- 3 HOLD THE LIVE END AND PULL THE THIMBLE SO THAT THE CABLE FITS TIGHTLY AROUND THE THIMBLE. TIGHTEN *ALL* NUTS EVENLY ON *ALL* CLAMPS TO THE MINIMUM TORQUE.
- 4 AFTER THE CABLE HAS BEEN INSTALLED AND THE NET ATTACHED, RETIGHTEN THE NUTS TO THE MINIMUM TORQUE.
- 5 CABLE WILL STRETCH AND SHRINK IN DIAMETER WHEN NETS ARE ATTACHED. INSPECT PERIODICALLY AND RETIGHTEN ALL NUTS TO THE MINIMUM TORQUE.

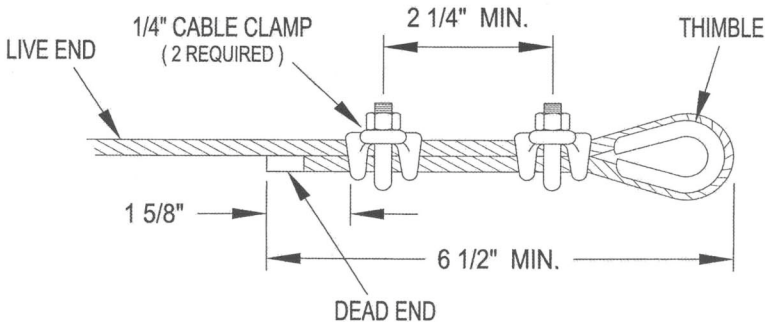

## CONVEYOR GUARD INSTALLATION AND HARDWARE

### WARNING

ALL OPENINGS BETWEEN THE CONVEYOR NET PANELS AND THE CABLES MUST BE KEPT TO A MINIMUM TO PREVENT GOODS FROM FALLING THROUGH AN OPENING !

- STEP 1** READ SAFETY INSTRUCTIONS STARTING ON PAGE 2.
- STEP 2** LAY OUT MATERIALS AND NET PANELS TO BE USED IN THE INSTALLATION.
- STEP 3** READ BELOW INSTALLATION INSTRUCTIONS.
- STEP 4** REFER TO PAGE 10 IF YOU HAVE PURCHASED SINCO'S ADJUSTABLE KITS.

BELOW ARE GUIDELINES FOR THE THREADED ROD VS. STEEL ANGLE INSTALLATION. REFER TO ENCLOSED SKETCHES.

### THREADED ROD INSTALLATION

1. LOCATE SUITABLE STARTING AND TERMINATION POINTS IN CONVEYOR FRAME FOR EYEBOLTS.
2. INSERT EYEBOLTS INTO EXISTING HOLES OR DRILL NEW HOLES FOR EYEBOLT.
3. CONNECT TURNBUCKLE ( IF APPLICABLE REFER TO PAGE 3 ) OR THIMBLE TO EYEBOLT.
4. CONNECT CABLE TO TURNBUCKLE WITH THIMBLES AND CABLE CLAMPS OR TO THIMBLE IF NO TURNBUCKLE REQUIRED ( REFER TO PAGE 8 ).
5. RUN CABLE BY ATTACHING TO THREADED RODS AND TERMINATE OTHER END, FOLLOWING THE INSTALLATION POINTS #3 AND #4 ABOVE.

OPTION: SINCO CAN SUPPLY "J-GUIDES" TO ATTACH TO 1/2" OR 5/8" THREADED RODS TO GUIDE CABLE, QUANTITIES VARY BY JOB. CALL SINCO FOR PRICING; NOT SUPPLIED WITH STANDARD HARDWARE.

6. FOR BOX SHAPE GUARD, RUN ( 4 ) LENGTHS OF CABLE TO FORM YOUR NET PANEL. HOOK ( 1 ) LENGTH OF NET PANEL TO ONE OF THE TOP CABLES WITH SNAP HOOKS AT A MINIMUM OF EVERY 12". BRING GUARD PANEL UNDER CONVEYOR AND UNDER BOTTOM TWO CABLE RUNS AND THEN UP TO TOP CABLE ON OPPOSITE SIDE AND ATTACH WITH SNAP HOOKS AT A MINIMUM OF EVERY 12" ALONG LENGTH OF THE GUARD PANEL. ( SIDE GUARD PANELS ARE HUNG ON ( 2 ) CABLE RUNS WITH SNAP HOOKS AT A MINIMUM OF EVERY 12" ).

NOTE: WHEN GOING AROUND CORNERS, HOOK NET PANEL TO CABLE ON OUTSIDE OF CORNER FIRST, THEN INSTALL NET TO CABLE ON INSIDE OF CORNER, BUNCHING IT UP AS NECESSARY AROUND CORNER.

7. INSTALL NEXT NET PANEL, AND SEAM NETS TOGETHER WITH CABLE TIES AT A MINIMUM OF EVERY 12".

### **STEEL ANGLE INSTALLATION**

1. LOCATE SUITABLE STARTING AND TERMINATION POINT IN ANGLE AND DRILL HOLES FOR EYEBOLTS.
2. INSERT EYEBOLTS INTO EXISTING HOLES OR THE DRILLED HOLES.
3. CONNECT TURNBUCKLE ( IF APPLICABLE REFER TO PAGE 3 ) OR THIMBLE TO EYEBOLT.
4. CONNECT CABLE TO TURNBUCKLE WITH THIMBLES AND CABLE CLAMPS OR TO THIMBLE IF NO TURNBUCKLE REQUIRED ( REFER TO PAGE 8 ).
5. DRILL HOLES INTO ANGLE AND PASS CABLE THRU THE HOLES AND TERMINATE OTHER END FOLLOWING THE INSTALLATION POINTS #3 AND #4 ABOVE.
6. FOR BOX SHAPE GUARD, RUN ( 4 ) LENGTHS OF CABLE TO FORM YOUR NET PANEL. HOOK ( 1 ) LENGTH OF NET PANEL TO ONE OF THE TOP CABLES WITH SNAP HOOKS AT A MINIMUM OF EVERY 12". BRING GUARD PANEL UNDER CONVEYOR AND UNDER BOTTOM TWO CABLE RUNS AND THEN UP TO TOP CABLE ON OPPOSITE SIDE AND ATTACH WITH SNAP HOOKS AT A MINIMUM OF EVERY 12" ALONG LENGTH OF THE GUARD PANEL. ( SIDE GUARD PANELS ARE HUNG ON ( 2 ) CABLE RUNS WITH SNAP HOOKS AT A MINIMUM OF EVERY 12" ).

NOTE: WHEN GOING AROUND CORNERS, HOOK NET PANEL TO CABLE ON OUTSIDE OF CORNER FIRST, THEN INSTALL NET TO CABLE ON INSIDE OF CORNER, BUNCHING IT UP AS NECESSARY AROUND CORNER.



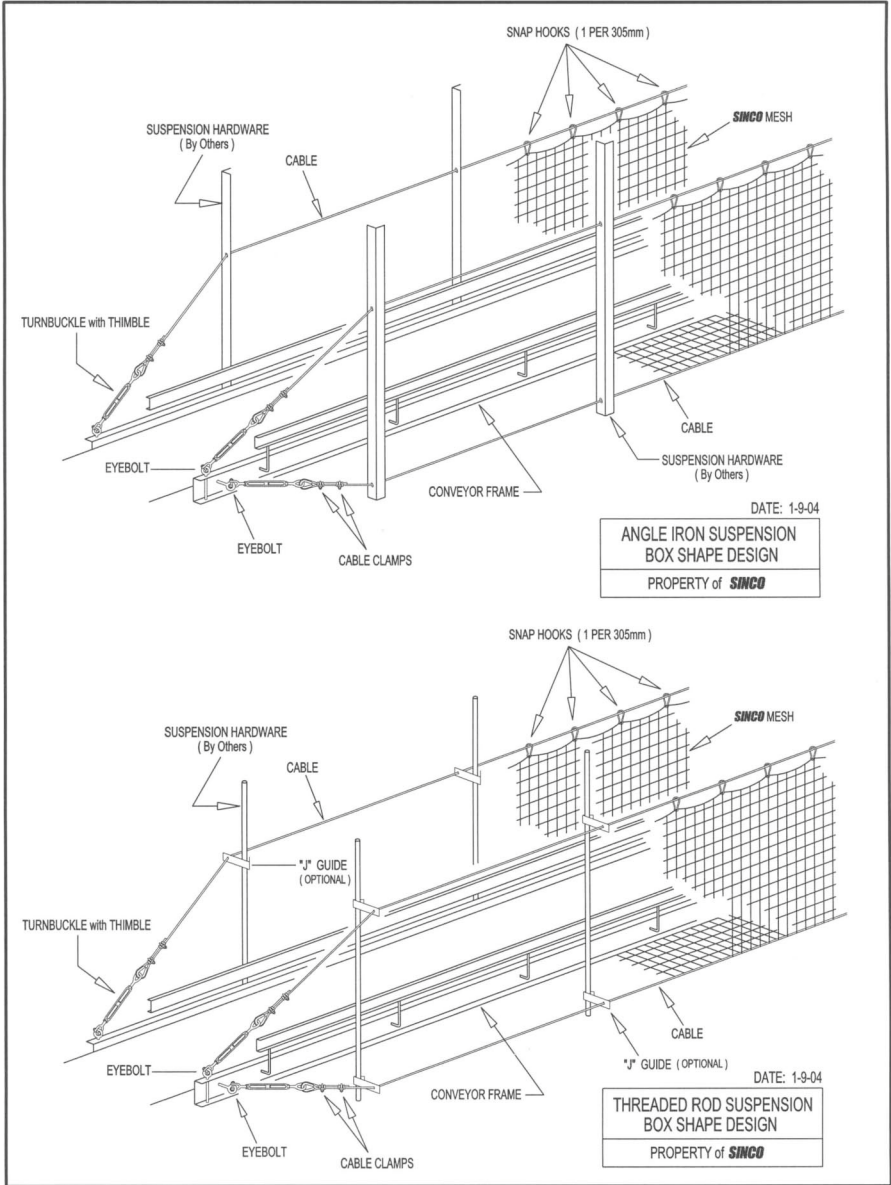

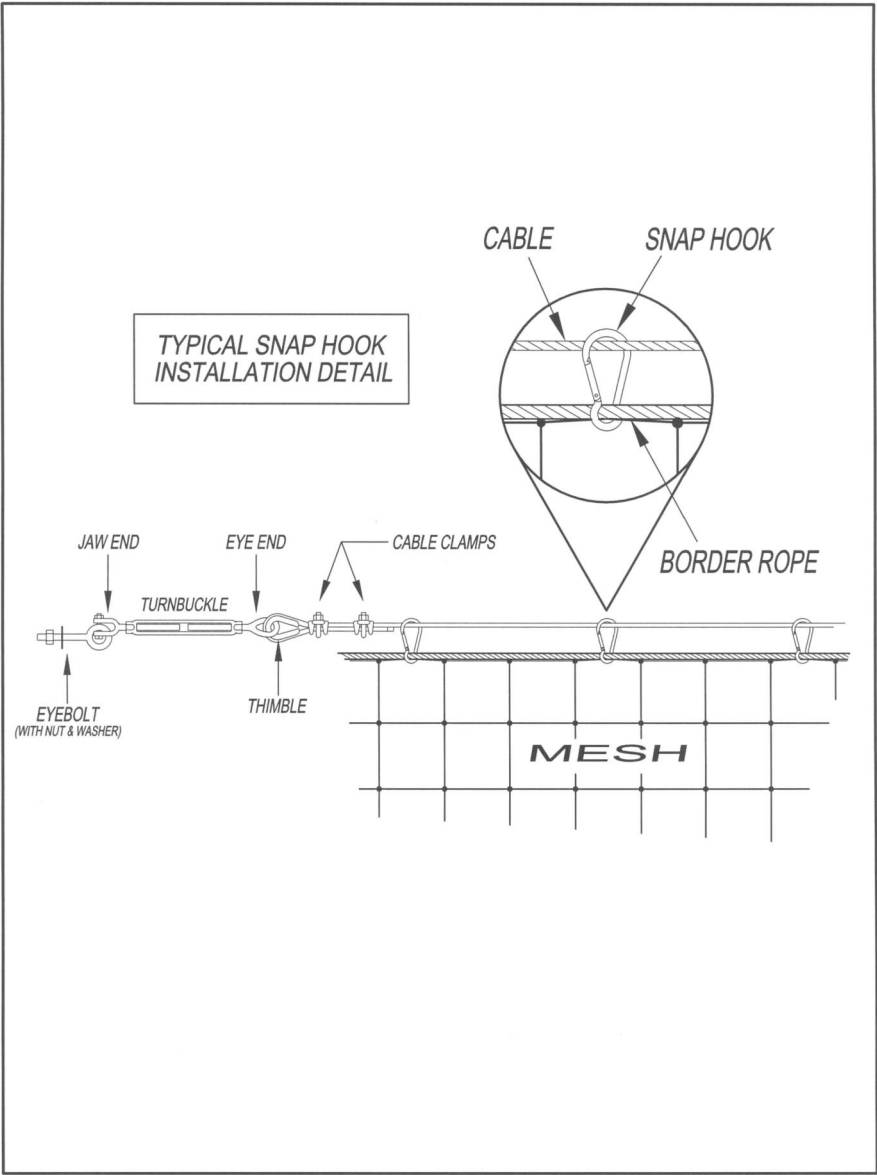
7. INSTALL NEXT NET PANEL, AND SEAM TOGETHER WITH CABLE TIES AT A MINIMUM OF EVERY 12".





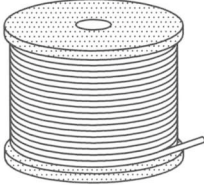
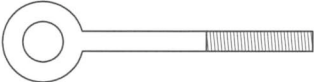
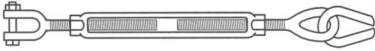
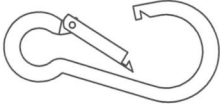

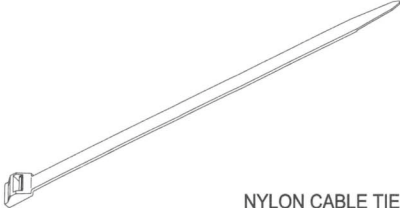
# CONVEYOR GUARD HARDWARE IDENTIFICATION CHART

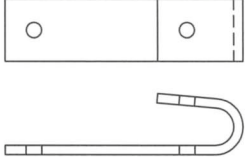
 <p>CABLE ( GALVANIZED ) 1/4"</p>	 <p>EYEBOLT 3/8"-16 x 4 1/4"</p>
 <p>TURNBUCKLE 3/8"</p>	 <p>SNAP HOOK 5/16"</p>
 <p>THIMBLE 1/4"</p>	 <p>NYLON CABLE TIE 9"</p>
 <p>CABLE CLAMP 1/4"</p>	 <p>J-GUIDE ( OPTIONAL ) FOR 1/2" OR 5/8" THREADED ROD</p>

**NETWORKS™ INDUSTRIAL  
ADJUST-A-NET™ (PATENT #6,068,085) PANELS  
AND HARDWARE KITS FOR CONVEYORS**

- STEP 1**      READ SAFETY INSTRUCTIONS STARTING ON PAGE 2.
- STEP 2**      READ BASIC CONVEYOR GUARD INSTALLATION INSTRUCTIONS STARTING ON PAGE 5.
- STEP 3**      READ BELOW KIT INSTRUCTIONS.

**CONVEYOR GUARD:** ENCLOSED ARE YOUR KIT(S) WHICH INCLUDES NETTING AND HARDWARE. CABLE RUNS ARE TERMINATED FOR EACH NET. A TURNBUCKLE IS INCLUDED FOR 50' LONG NETS ONLY. THE DESIGN ALLOWS THE NET TO ADJUST TO DIFFERENT SIZES. ONCE YOUR FIRST NET PANEL IS HUNG, CONTINUE WITH ADDITIONAL NETS AS NEEDED HANGING EACH ONE ON ITS OWN CABLE AND SEAM TOGETHER WITH CABLE TIES.

BOX-SHAPE NETTING – THERE IS ENOUGH CABLE PER HARDWARE KIT FOR (4) RUNS TO FORM THE "BOX-SHAPE". THE NET IS ATTACHED TO THE TOP (2) CABLE RUNS WITH SNAP HOOKS AT A MINIMUM OF EVERY 12". TO ADJUST THE WIDTH ONCE INSTALLED, GATHER THE EXCESS MESH ON ONE OF THE TOP LONG LENGTHS WITH THE BORDER ROPE AND THEN TO THE CABLE WITH SNAP HOOKS AT A MINIMUM OF EVERY 12".

SIDE NETTING – THERE IS ENOUGH CABLE FOR (2) RUNS. THE NET IS ATTACHED TO BOTH RUNS WITH SNAP HOOKS AT A MINIMUM OF EVERY 12". TO ADJUST THE WIDTH ONCE INSTALLED, GATHER THE EXCESS MESH ON ONE OF THE LONG LENGTHS WITH THE BORDER ROPE AND THEN TO THE CABLE WITH SNAP HOOKS AT A MINIMUM OF EVERY 12".

TO SHORTEN LENGTH OF NET, CUT TO SIZE AND SECURE UNFINISHED EDGES BY GATHERING A MINIMUM OF 3 MESH BARS WITH NYLON TIES TO TERMINATION POINT.

**NOTE:** NOT ALL PARTS MAY BE NEEDED FOR YOUR SPECIFIC CONVEYOR RUNS. YOU HAVE PURCHASED A KIT FOR VARIOUS APPLICATIONS AND THEREFORE THERE MAY BE EXTRA PARTS INCLUDED. INDIVIDUAL PARTS ARE NON-RETURNABLE.

BOX SHAPED GUARD KIT

KIT CONTAINS:

- (220') 1/4" wire cable
- (8) 3/8" eyebolts
- (4) 3/8" turnbuckles
- (8) 1/4" thimbles
- (16) 1/4" cable clamps
- (100) 5/16" snap hooks
- (1 pack) 9" ties

SIDE GUARD KIT

KIT CONTAINS:

- (110') 1/4" wire cable
- (4) 3/8" eyebolts
- (2) 3/8" turnbuckles
- (2) 1/4" thimbles
- (8) 1/4" cable clamps
- (100) 5/16" snap hooks
- (1 pack) 9" ties

TO ADJUST NET WIDTH, GATHER EXCESS MESH TO BORDER ROPE WITH SNAP HOOKS ON ONE LENGTH.

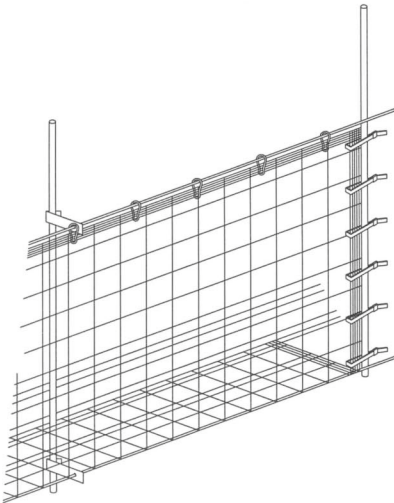
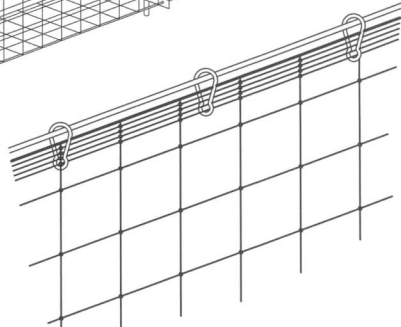
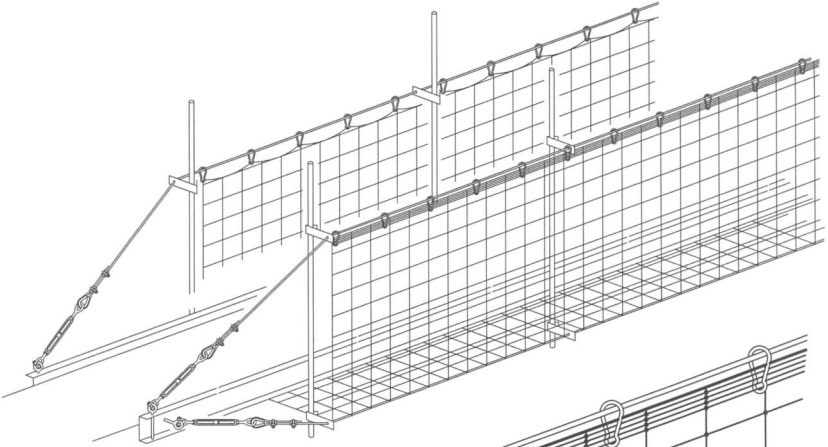

TO ADJUST NET LENGTH, GATHER A MINIMUM OF 3 MESH BARS TO TERMINATION POINT.

## **WARRANTY**

Equipment offered by DBI-SALA is warranted against factory defects in workmanship and materials for a period of two years from date of installation or use by the owner, provided that this period shall not exceed two years from date of shipment. Upon notice in writing, DBI-SALA will promptly repair or replace all defective items. DBI-SALA reserves the right to elect to have any defective item returned to its plant for inspection before making a repair or replacement. This warranty does not cover equipment damages resulting from abuse, damage in transit, or other damage beyond the control of DBI-SALA. This warranty applies only to the original purchaser and is the only one applicable to our products, and is in lieu of all other warranties, expressed or implied.



A CAPITAL SAFETY COMPANY

USA  
3833 SALA Way  
Red Wing, MN 55066-1837  
Toll Free: 800-328-6146  
Phone: (651) 388-8282  
Fax: (651) 388-5065  
[www.capitalsafety.com](http://www.capitalsafety.com)

Canada  
260 Export Boulevard  
Mississauga, Ontario L5S 1Y9  
Toll Free: 800-387-7484  
Phone: (905) 795-9333  
Fax: (905) 795-8777  
[www.capitalsafety.com](http://www.capitalsafety.com)

This manual is available for download at [www.capitalsafety.com](http://www.capitalsafety.com).