

# Manual

*Assembly, Maintenance & Operating Manual*

**PATTERSON**™

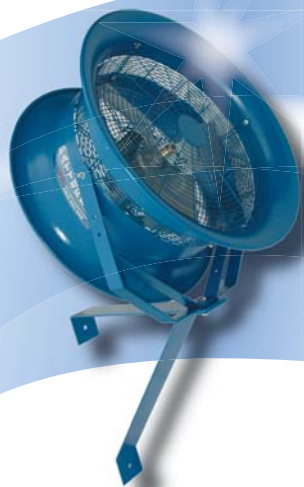

Patterson Fan Company, Inc.  
Blythewood, SC 29016  
[www.pattersonfan.com](http://www.pattersonfan.com)  
800.768.3985

**PATTERSON**™





## Yoke Mount Assembly Instructions

Note: There are many acceptable methods for hanging a Patterson Yoke Mount fan. The most important things to remember are that the yoke must be securely connected to a solid structure and that all materials used to hang the yoke and fan must be rated for this type of rigging and workload. Below is what we consider to be the simplest method of fan suspension. Feel free to improvise, but please use caution and good judgment.

1. Secure the "U" Shaped Yoke to the object from which you intend to mount the fan. Use a 5/8" bolt, a 5/8" nut and (2) 5/8" washers. Tighten the nut onto the bolt using a 5/16" bolt end wrench and ratchet with 5/16" socket.
2. The factory assembled fan head fits inside of the "U" shaped yoke, the threaded studs on each side of the fan fit through the predrilled holes on the "U" shaped yoke. Secure the factory assembled fan head to the "U" shaped yoke with the supplied nuts. Mount the factory assembled fan head so that the motor mount is below the motor.
3. If safety cable installation is desired (recommended), use a length of chain or cable to secure the fan to a solid surface and attach to the fan. Make sure cable or chain is rated for the weight and purpose of securing the fan.



Patterson Fan Company, Inc  
Blythewood, SC 29016  
[www.pattersonfan.com](http://www.pattersonfan.com)  
800.768.3985



# TC Truck Cooler Assembly Instructions

Note: Important things to remember are that the wall mount should be a solid structure able to support the weight of the fan safely and that the fan should not be at a height that will cause employees to bump their heads. Ideally, the fan should be mounted to blow into the back of the truck down the top corner of either side of the trailer.

1. Secure the wall bracket and arm to the solid surface where you will hang the fan. A structurally secure solid wall or beam is best.
2. Secure the "U" shaped yoke to the arm of the wall bracket. Use the 5/8" bolt and 5/8" nut supplied. Tighten the nut onto the bolt using a 5/16" box end wrench and ratchet with a 5/16" socket. *For clearance reasons, the "U" shaped yoke must open down.*
3. The fan head fits inside the "U" shaped yoke, the threaded studs on each side of the fan fits through the predrilled holes on the "U" shaped yoke. Secure the fan head to the "U" shaped yoke with the supplied nuts. Mount the fan head so that the motor mount is below the motor.

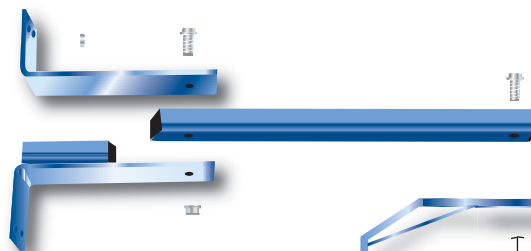

Patterson Fan Company, Inc  
Blythewood, SC 29016  
[www.pattersonfan.com](http://www.pattersonfan.com)  
800.768.3985



Note: Due to continual product improvement, items are subject to change without notice.



# CW Column Wall Mount Assembly Instructions

Note: The most important thing to remember is that if the fan is at a level near people, it should be equipped with OSHA approved Patterson finger guards. Please contact your factory sales representative to order.

1. Secure Part A of the wall bracket to the solid surface from which you will hang the fan. There is a single mounting hole on the short end of the part. Secure part A using a wall anchor, etc. (Wall anchor not included.) Place a level on the part.
2. Position part B under part A as shown and situate part B in such a way so that part A becomes level. Mark part B for the hole. Attach part B using the appropriate wall anchor, (not included).
3. Secure the "U" shaped yoke to the wall bracket using the supplied 5/8" bolt and nut. The "U" shaped yoke may open up or down, depending on whether the wall bracket is thick side up or down. If you plan to add an oscillator, mount the yoke so that it opens up. The bolt must go through all three pieces. Check for level and stability.
4. The factory assembled fan head fits inside of the "U" shaped yoke. Secure the fan head to the yoke with the supplied nuts. Mount the fan head so the motor mount is below the motor.



Note: Due to continual product improvement, items are subject to change without notice.

Patterson Fan Company, Inc  
Blythewood, SC 29016  
[www.pattersonfan.com](http://www.pattersonfan.com)  
800.768.3985



# HV Ceiling Suspended Assembly Instructions

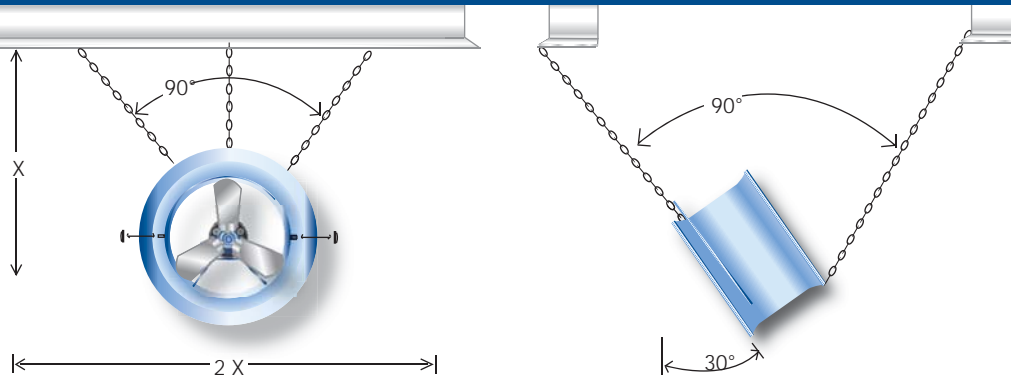

1. Attach two eyebolts to holes in top front of fan. Attach third eyebolt to back rear hole in fan.
2. By means of a mechanical lift (cherry picker, scissor lift, etc.) get the factory assembled fan head to the point where you plan to suspend it. You will need three lengths of chain, three connectors, hardware for chains and bolt cutters.
3. Secure two lengths of chain to the beam or girder number 1 about two times the distance apart that the fan will hang down (see diagram). The third length of chain should be centered between the two front lengths of chain and attached to beam number 2. Attach the chains to the beams using your preferred method.
4. Connect the lengths of chain to the eyebolts on the factory assembled fan head using the chain connectors.
5. Rough focus the fan on your target while on the mechanical lift.
6. Get a co-worker to stand at the target mark. Make sure the power is turned off. Have someone plug the fan in. Let the fan run for approximately 30 seconds (to get up to speed and settle itself down). With someone on the floor, someone at the fan, and someone at the power, focus the fan. **DO NOT ATTEMPT TO ADJUST THE FAN WHILE IT IS RUNNING!**
7. Remove excess chain with bolt cutters.

Note: Due to continual product improvement, items are subject to change without notice.

Patterson Fan Company, Inc  
Blythewood, SC 29016  
[www.pattersonfan.com](http://www.pattersonfan.com)  
800.768.3985



# RM Rack Mount Fan Assembly Instructions

Note: Important things to remember are that the wall mount should be a solid structure able to support the weight of the fan safely and that the fan should not be at a height that will cause employees to bump their heads. Ideally, the fan should be mounted to blow into the back of the truck down the top corner of either side of the trailer.

1. Secure the wall bracket and arm to the solid surface where you will hang the fan. A structurally secure solid wall or beam is best.
2. Secure the "U" shaped yoke to the arm of the wall bracket. Use the 5/8" bolt and 5/8" nut supplied. Tighten the nut onto the bolt using a 5/16" box end wrench and ratchet with a 5/16" socket. *For clearance reasons, the "U" shaped yoke must open down.*
3. The fan head fits inside the "U" shaped yoke, the threaded studs on each side of the fan fits through the predrilled holes on the "U" shaped yoke. Secure the fan head to the "U" shaped yoke with the supplied nuts. Mount the fan head so that the motor mount is below the motor.



Note: Due to continual product improvement, items are subject to change without notice.

Patterson Fan Company, Inc  
Blythewood, SC 29016  
[www.pattersonfan.com](http://www.pattersonfan.com)  
800.768.3985



# Maintenance Instructions



1. All Patterson Fans are designed to be virtually maintenance free. Routine cleaning and inspection are recommended. On an as need basis, clean the fan of all dust, dirt and grease. Regular cleaning will keep your fan operating at optimal performance levels.
2. On an annual basis, we recommend you inspect the following: tightness of the blades, integrity of the motor welds, tightness of the safety guards, tightness of 5/8" bolt and washer and the security of the safety chain.
3. If you find any areas of concern as a result of your routine inspection, or have any questions about the assembly or operation instruction, please call your factory sales representative at 800-768-3985.

Please read carefully before assemble, install, operate or maintain any Patterson Fan Product. Protect yourself and others by observing all safety information. Failure to comply with instructions could result in personal injury and/or property damage. Retain instructions for future reference.

Disconnect power source before installing or servicing. Failure to disconnect power source can result in fire, shock or serious injury.

1. Patterson products should be installed and serviced by qualified technicians only.
2. Follow all local electrical and safety codes, as well as the National Electric Code (NEC) and the Occupational Safety and Health Act (OSHA) in the United States.
3. The unit should be installed, protected and fused in accordance with latest issue of the National Electrical Code, MEMA Standard Publication No. MG2 and local codes.
4. Motor must be securely and adequately grounded. This can be accomplished by wiring with a ground, metal-clad raceway system, using a separate ground wire connected to the bare metal of the motor frame, or other suitable means.
5. Always disconnect power source before working on or near a motor or its connected load. Lock open position and tag to prevent unexpected application of power.
6. In accordance with OSHA requirements. Guarding is required if unit is mounted less than 7 feet above floor or where workers have access.
7. Keep hands and clothing away from moving parts.
8. Be careful when touching the exterior of an operating motor; it may be hot enough to cause injury. This condition is normal if operated at a rated load and voltage and built to operate at higher temperatures.
9. Protect power cable from coming into contact with sharp objects.
10. Do not tangle power cable and never allow cable to come in contact with oil, grease, hot surfaces or chemicals.
11. Make certain that the power source confirms to requirements of your equipment.

### Single Phase Motors

The factory assembled fan head is equipped with a 12 foot long cord and connector. To turn on fan, plug it in; to turn off fan, unplug it.

### Three Phase Motors

A cord and connector is not supplied with three phase motors. These fans will need to be fitted with an appropriate cord and connector or hard wired directly to a power source. If the fan is supplied with finger guards, the rear finger guard will need to be partially removed to access the motors internal wiring. Remove all but one of the self-tapping screws and place them in a safe place. You will use them again. Rotate the guards around on the single self-tapping screw. Wire the fan. Replace the guard using the saved self tapping screws.

When looking at the front of the fan, the blade should be turning clockwise. If it does not, the electrical connection wires may need to be reversed. If reversing the wires does not work, contact your factory representative.