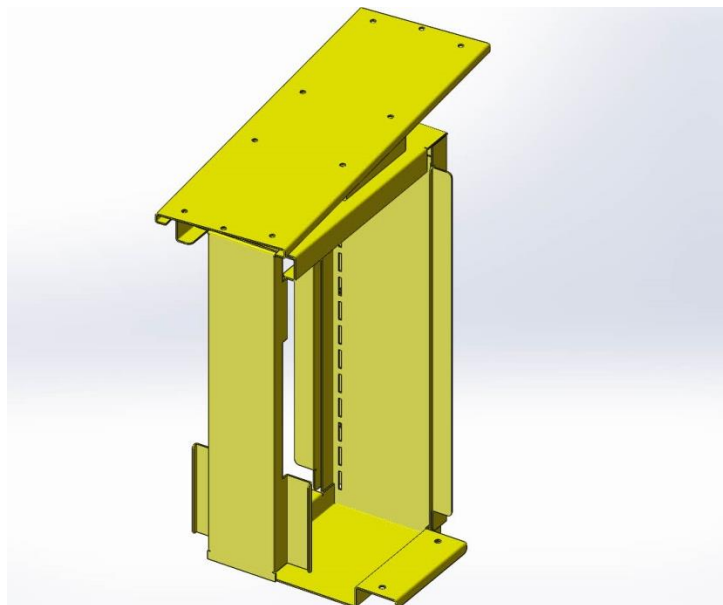

Holder**Hardware List**

- 4 - M6-1.0 x 15mm Socket Head Countersunk Screw
- 2 - Handled Bolt
- 6 - #10 x 1/2" Phillips Head Pan Screw
- 2 - #10 x 3/4" Phillips Head Pan Screw
- 16 - Rubber Button Bumper
- 2 - Nylon Stops

**Assembly**

After removing CPU02 from the box, check all components for any damage and check that all hardware items are included.

Follow assembly instructions included in the box of the CPU Holder for mounting to the bottom surface of the work surface.

Install the rear nylon stop in the center hole at rear of mounting channel. Insert CPU02 assembly into mounting channel and install the front nylon stop. Refer to the CPU assembly sheet. The CPU02 is now ready for the installation of the computer.