



**READ THIS MANUAL CAREFULLY.
OBSERVE WARNINGS AND PRACTICE
CAUTION WHEN INSTALLING,
OPERATING, OR MAINTAINING YOUR
GOFF'S PRODUCT.**

Side-Seal Bug Blocking Curtain Assembly Instructions

1. Fasten the track splices to the underside of your door frame header using fasteners suited for your building material. One track splice is typically mounted in the center of the door opening and the other two are mounted approximately 4" (four inches) from either end. Wide door openings may require additional splices and different spacing. Doors narrower than 8' (eight feet) typically do not require a center splice. Make sure that the splices are all in a straight line across the underside of the header and that there is a splice located at all track junctions.

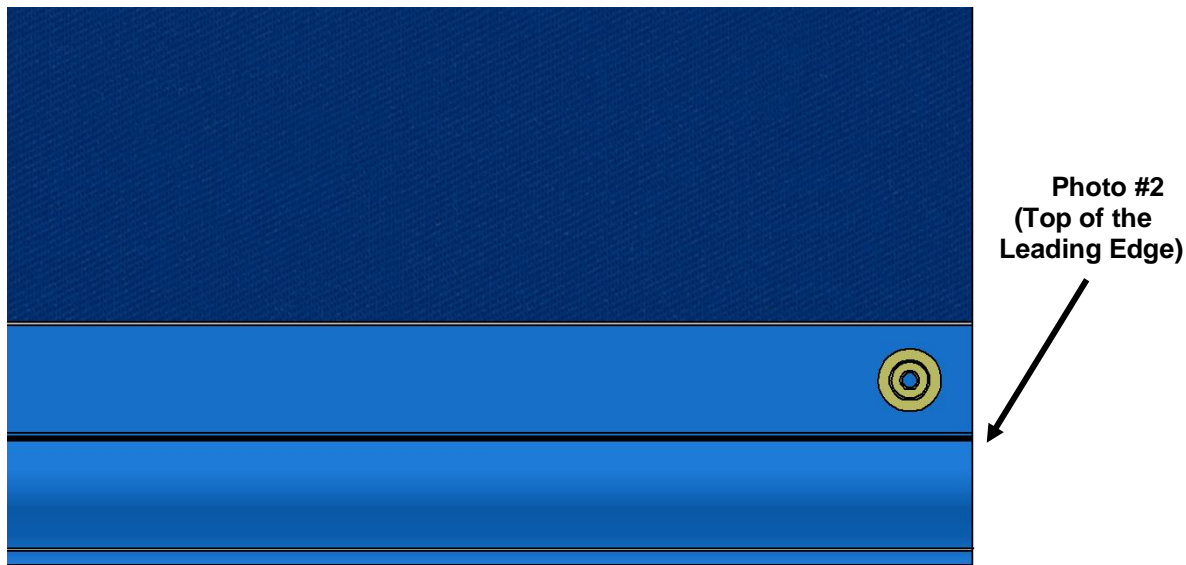
****NOTE: INSTALL ROLLERS INTO TRACK BEFORE MOUNTING IN OPENING****

2. Loosen and/or remove the nuts from one half of the track splices and install one track section. Make sure that the track sits squarely in the splices and that the end of the track sections is butted firmly against the inside door jamb. Reinstall and tighten the splice clamp nuts. Your track and splice installation should resemble the following photo (Photo 1):

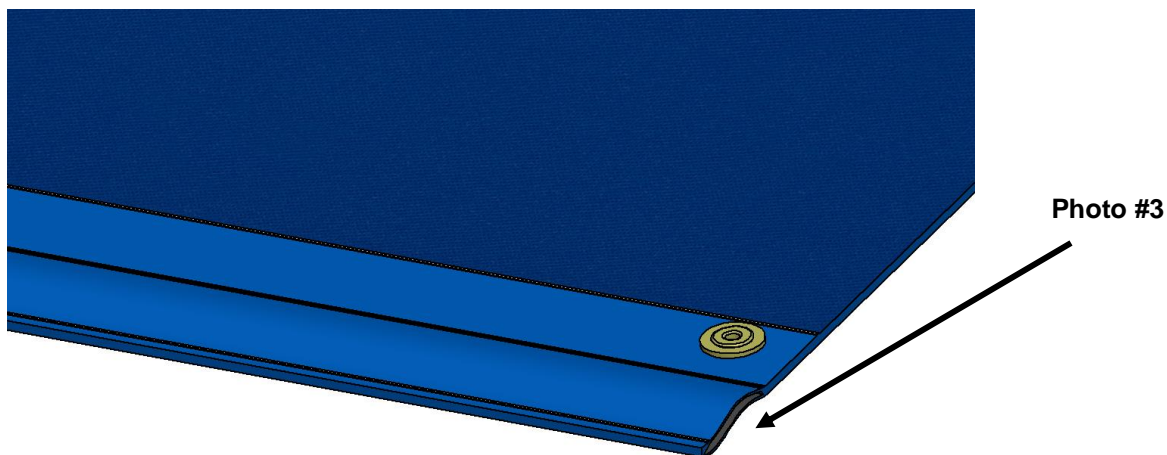


Photo #1 (Track and Splice Mounting)

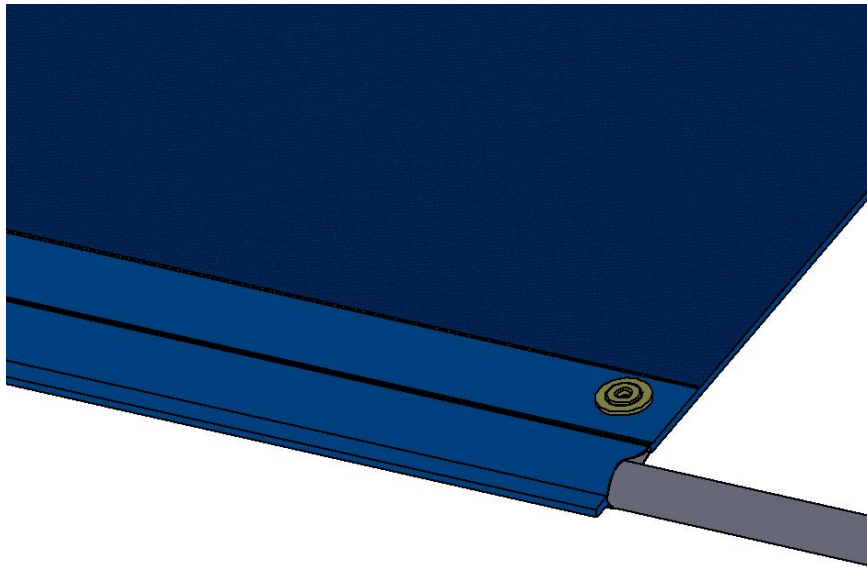
3. Mount the remaining track sections using the same method as the first. *If your doorframe is not exactly the specified dimension you may have too much or too little track. If you have too much it will be necessary to cut some length from one end of one track section. If you have too little, make sure that adjacent track sections are butted against each other and split the gap at each jamb. Ensure that there is no more than a 1" gap between a track end and the jamb of your door opening.* Unfold the mesh screen curtain and lay it on a clean flat surface. One fiberglass stiffener section, the door handles, and the "Slot Lock Stud" have already been installed. If your door opening is greater than 8' (eight feet) tall, additional fiberglass stiffener sections will need to be installed. If not, please skip to Section 9.
4. Locate the opening at the top of the leading edge as shown in photo 2:



5. Lift the solid vinyl, exposing the mesh material within the pocket (between vinyl layers) as shown in the following photo (Photo 3):

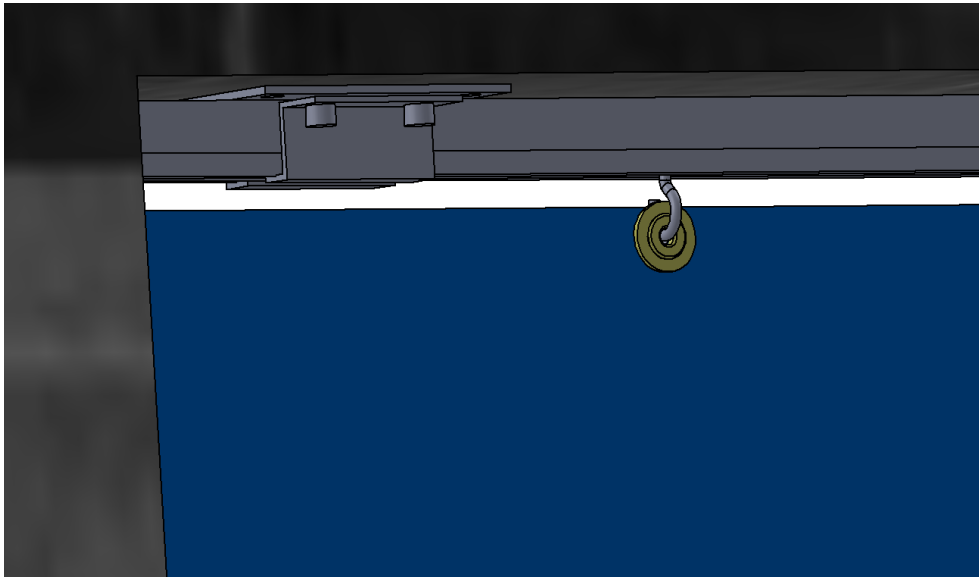


6. Locate the fiberglass stiffener extension tube and slide it into the pocket between the vinyl and mesh material as shown in the following photo (Photo 4). Tall doors will have multiple extension tubes. Install these tubes “blunt end first” (6” splice section pointing “up”).



**Photo #4
(Fiberglass Stiffener
Insertion)**

7. Continue to push the stiffener down into the pocket until it engages the splice section of the adjacent (lower) tube. A slight twisting motion may be required in order to get the splice to properly and fully engage the stiffener extension tube. Repeat the process as required until all stiffener extensions have been installed. When you are finished, the top of the uppermost extension tube should be approximately 3” below the top of the pocket.
8. Hang the mesh curtain by installing the roller hooks through the grommets at the top of the curtain. Using a pair of pliers, crimp the hook at the top of the fiberglass stiffener pocket to ensure that wheel assembly does not become unhooked from the curtain (optional). See the following photo (Photo 5):



**Photo #5
(Crimped Hanger
Hook)**

9. With the curtain hanging freely from the track and hooks, mount the “Slot Lock Bracket” to the inside of the door jamb so that the Slot Lock Stud is in alignment with the bottom of the slot in the bracket as shown in the following photo (Photo 6). *For concrete or block jambs, be sure to use the plastic anchors and screws provided. For wooden jambs discard the anchors and just use the screws.*



**Photo #6 (Slot Lock Bracket
Mounting Alignment)**

10. Fasten the fixed side of the screen to the opposite door jamb using the appropriate fasteners. Be sure to install the tie-back strap at a convenient height using one of the grommet hole locations in the curtain. The tie-back strap will be “sandwiched” between the curtain and the door jamb.

11. Using scissors, trim the door sweep at the bottom of the curtain to conform to the pitch, height, and/or imperfections in the floor.
12. Attach the valence panel to the building fascia using the self-tapping screws with rubber washers provided. Slide the fasteners through the grommet holes at the top of the valence and secure the valence 2"-4" (two to four inches) above the top of the door opening header. Center the valence in the opening which should provide approximately a 3" (three inch) overlap on both sides. If the building fascia is bricking, the blue plastic anchors can be used in conjunction with the self-tapping screws.

