

## 6.0 Warranty

All products sold by Harrington Hoists, Inc. are warranted to be free from defects in material and workmanship from date of shipment by Harrington for the following periods:

**Manual Hoists & Trolleys - 2 years**  
**Air and Electric Powered Hoists, Trolleys, and Crane Components - 1 year**  
**Spare / Replacement Parts - 1 year**

The product must be used in accordance with manufacturer's recommendations and must not have been subject to abuse, lack of maintenance, misuse, negligence, or unauthorized repairs or alterations.

Should any defect in material or workmanship occur during the above time period in any product, as determined by Harrington Hoist's inspection of the product, Harrington Hoists, Inc. agrees, at its discretion, either to replace (not including installation) or repair the part or product free of charge and deliver said item F.O.B. Harrington Hoists, Inc. place of business to customer.

Customer must obtain a Return Goods Authorization as directed by Harrington or Harrington's published repair center prior to shipping product for warranty evaluation. An explanation of the complaint must accompany the product. Product must be returned freight prepaid. Upon repair, the product will be covered for the remainder of the original warranty period. If it is determined there is no defect, or that the defect resulted from causes not within the scope of Harrington's warranty, the customer will be responsible for the costs of returning the product.

Harrington Hoists, Inc. disclaims any and all other warranties of any kind expressed or implied as to the product's merchantability or fitness for a particular application. Harrington will not be liable for death, injuries to persons or property or for incidental, contingent, special or consequential damages, loss or expense arising in connection with the use or inability whatever, regardless of whether damage, loss or expense results from any act or failure to act by Harrington, whether negligent or willful, or from any other reason.

## 7.0 Parts List

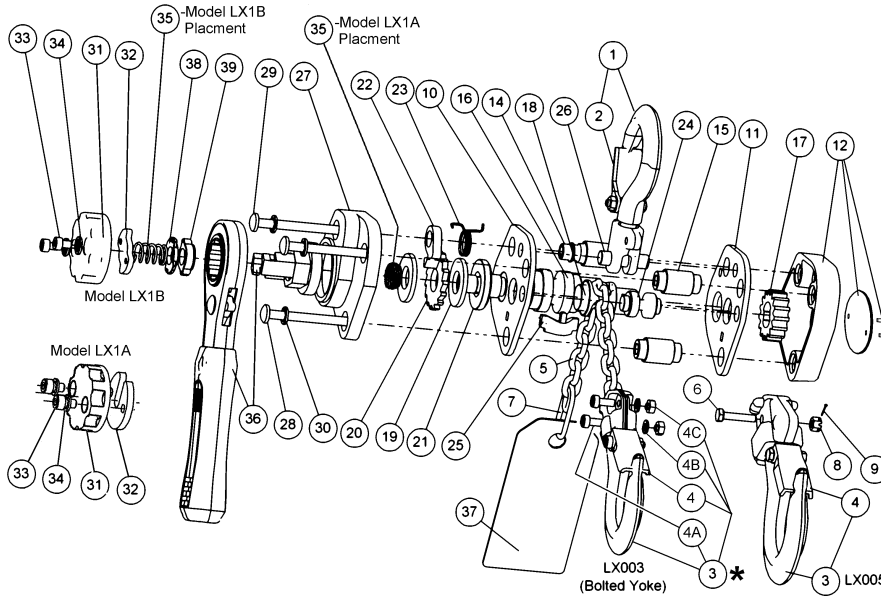

- \* LX003 Bottom Hook:
- Refer to section 2.2.2 For technical information.
  - Fastener Assembly:
    - Torque to 40 – 48 lb<sub>f</sub>-in.
    - Use Loctite® Threadlocker 241 or 242.

Figure No.	Part Name	Model	Parts Per Hoist	LX003 1/4 Ton	LX005 1/2 Ton
1	Top Hook Assembly		1	L1XA0031001	L1XA0051001
2	Latch Assembly		1	L1XA0031071	L1XA0051071
3 *	Bottom Hook Assembly		1	L1XA0031021	L1XA0051021
4	Latch Assembly		1	L1XA0031071	L1XA0051071
4a	Spring Washer		2	9012707	
4b	Hex Nut		2	9093414	
4c	Socket Head Cap Screw		2	9091203	
5	Load Chain		FT	LCLX003NP	LCLX005NP
6	Chain Pin		1	L1LA0059041	
7	Chain Stopper Link		1	L1XA0039045	L1LA0059045
8	Slotted Nut		1	L1LA0059049	
9	Split Pin		1	9009401	
10	Frame A		1	L1XA0039101	L1XA0059101
11	Frame B		1	L1XA0039102	L1XA0059102
12	Gear Case with Nameplate		1	L1XA0035103	L1XA0055103
14	Stud A		2	L1XA0039104	L1XA0059104
15	Stud B		1	L1XA0039105	L1XA0059105
16	Pinion	LX1A	1	L1XA0039111	L1XA0059111
		L1XB	1	L1XA0039111R3	L1XA0059111R2
17	Load Gear		1	L1XA0039114	L1XA0059114
18	Load Sheave		1	L1XA0039116	L1XA0059116
19	Friction Plate		2	L1XA0039151	L1XA0059151
20	Ratchet Disc		1	L1XA0039152	L1XA0059152
21	Friction Disc		1	L1XA0039153	L1XA0059153

Figure No.	Part Name	Model	Parts Per Hoist	LX003 1/4 Ton	LX005 1/2 Ton
22	Pawl		1		L1XA0039155
23	Pawl Spring		1		L1XA0039158
24	Guide Roller		1	L1XA0039161	L1XA0059161
25	Stripper		1	L1XA0039162	L1XA0059162
26	Top Pin		1	L1XA0039163	L1XA0059163
27	Brake Cover		1	L1XA0039172	L1XA0059172
28	Button Head Socket Screw		2	L1XA0039173	L1XA0039174
29	Button Head Socket Screw		1	L1XA0039174	L1XA0059174
30	Internal Tooth Lock Washer		3		96797J09
31	Chain Knob	LX1A	1	L1XA0039201R1	L1XA0059201R1
		LX1B	1		L1XA0039201R2
32	Lever Clamping Plate	LX1A	1	L1XA0039202R1	L1XA0059202R1
		LX1B	1	L1XA0039202R2	L1XA0059202R2
33	Socket Bolt	LX1A	2	9091224	9091225
		LX1B	1		9091201
34	Conical Lock Washer	LX1A	2		L1XA0039204R1
		LX1B	1		L1XA0039204R2
35	Free Chain Spring	LX1A	1	L1XA0039205	L1XA0059205
		LX1B	1		L1XA0039205R3
36	Lever Assembly	LX1A	1	L1XA0034211	L1XA0054211
		LX1B	1	L1XA0034211R2	L1XA0054211R2
37	Warning Tag		1		WTAG9
38	Free Chain Plate	LX1B	1		L1XA0039209
39	Cam Guide	LX1B	1		L1XA0039203

Harrington Hoists, Inc.  
 401 West End Avenue  
 Manheim, PA 17545  
 Phone: 717-665-2000  
 Toll Free: 800-233-3010  
 Fax: 717-665-2861



www.harringtonhoists.com

Harrington Hoists - Western Division  
 2341 Pomona Rincon Rd. #103  
 Corona, CA 91720  
 Phone: 951-279-7100  
 Toll Free: 800-317-7111  
 Fax: 951-279-7500

LXOM