

# Flexworks™ Swing Arm Assembly Instructions

Addendum to Flexworks Accessory Instruction MD001A3 (page 3\_4)

These instructions are to be used in conjunction with the Flexworks Accessory Instructions, and are for the following swing arm products: Monitor Shelf, Accessory Shelf, and Document Holders

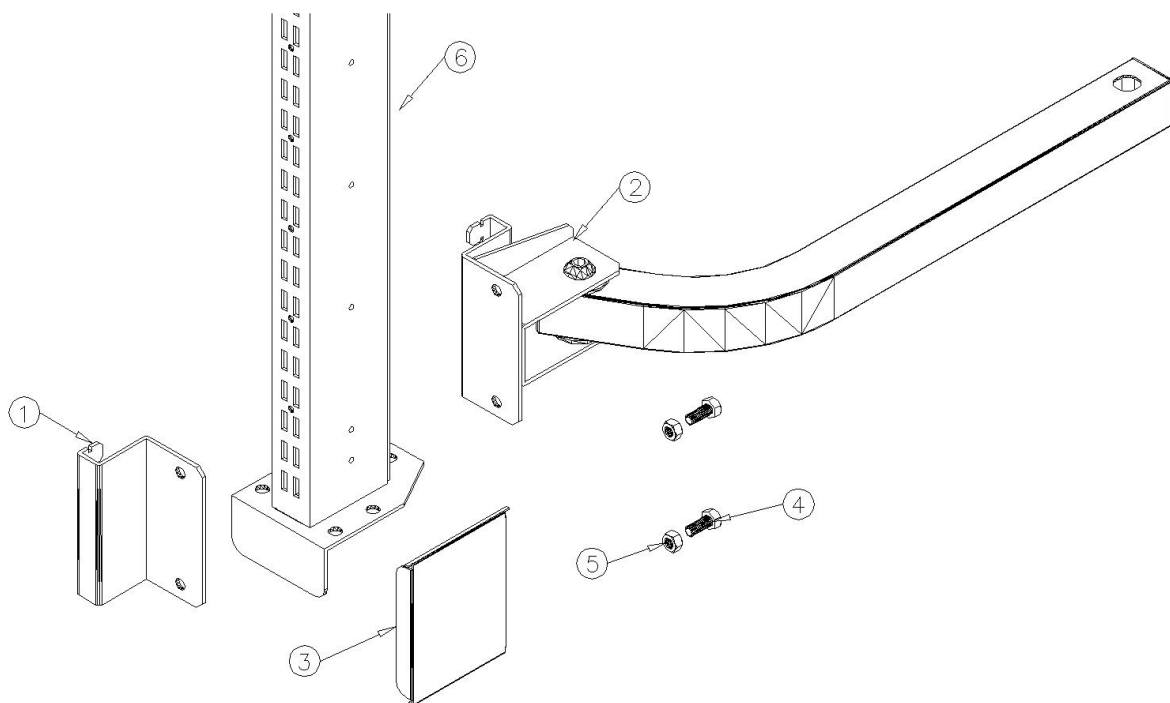

Figure 1 – exploded view of completed assembly

Part	Description	Quantity
1	Rear clamp bracket	1
2	Front Swing Arm Assembly (Complete)	1
3	FlexworksShim	1*
4	5/16-18 Hex Head Bolt (A100312)	2
5	5/16-18 Kep Nut (A100308)	2
6	Flexworks Post (without cover)	(not included)

\*Note: Not required if flexworks were ordered with covers. Covers are ordered separately.

#### Tools required:

- Rubber Mallet
- Socket set with extension
- Crescent Wrench

Step	Procedure (refer to Figure 1 for part identification)
1	(Figure 2) Insert rear bracket (#1) into rear of flexworks upright at desired height. To install, insert the tabs into the outer holes at the rear of the Flexworks post. Gently tap the bracket into place
2*	(Figure 3) Slide shim (#3) between flexworks post (#6) and rear bracket (#1) so that it rests on top of the rear bracket.*
3	(Figure 4) Insert front swing arm assembly (#2) into front of Flexworks post so that the two holes on the front bracket line up with the holes on the rear bracket. To install, insert the tabs into the outer holes at the front of the Flexworks upright. Gently tap the bracket into place.
4	Insert two 5/16-18 x 3/4" (#4) hex head bolts into the bracket to and secure with two 5/16-18 kep nuts (#5)
5	Ensure nut and bolts are tight and secure

\*Note: Shim is not required if Flexworks covers are used over the Posts.



106 Lowland St  
Holliston, MA 01746  
E-mail: sales @ listaintl.com  
<http://www.listaintl.com/>  
For Technical Support, please call 800-423-1350  
MD001A3 addm Rev 0, 11/2001  
©2001 Lista International Corp. All rights reserved

ISO 9001 Certified

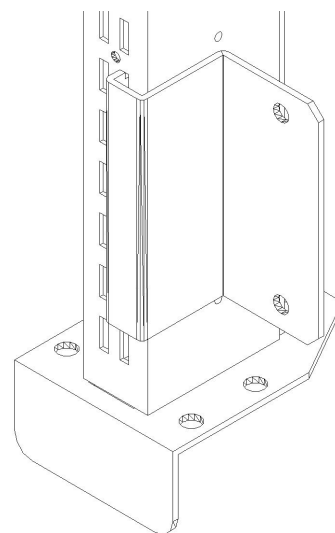

Figure 2 – Install rear bracket

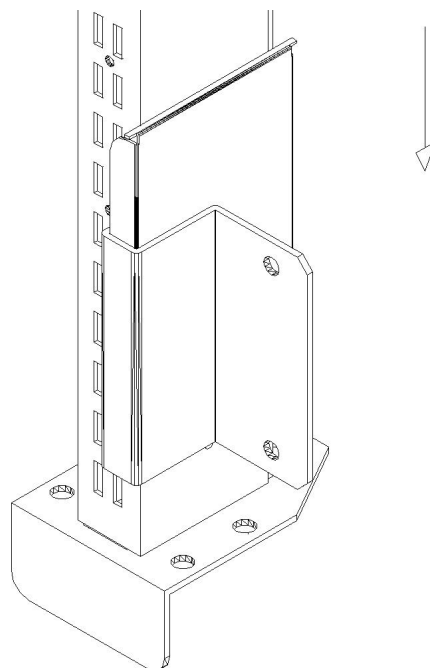

Figure 3 – Install Shim

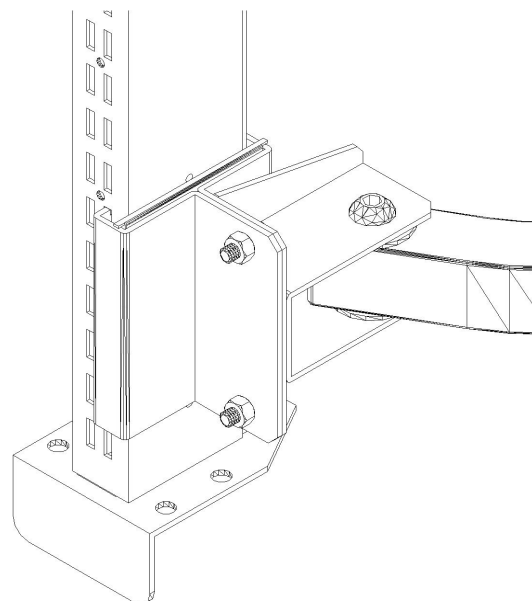

Figure 4 – Install front assembly and hardware