

# SafeStop Bollard 15

## INSTALLATION INSTRUCTIONS

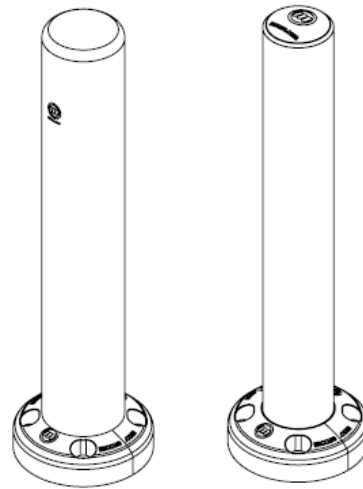

Components (components vary by install)

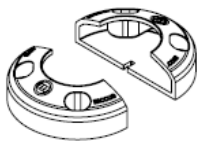

Shock Absorbers

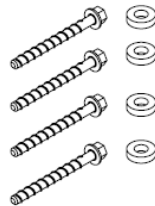

Washers &  
Anchors

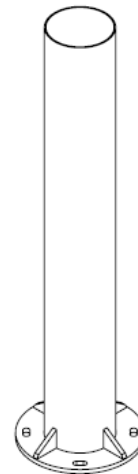

Bollard Post



Cap or Post Cover

Tools Required

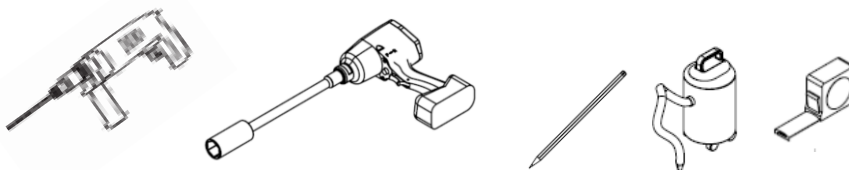

- ☐ Hammer Drill with ½" [12mm] Concrete/Masonry Drill Bit
- ☐ Impact Driver with ¾" [19mm] Socket
- ☐ Pencil/Marker
- ☐ Vacuum
- ☐ Tape Measure
- ☐ PPE



Questions

McCue Corporation  
Danvers, Massachusetts, USA  
+1 (800) 800 8503  
customer@mc cue.com

Distributed by Cisco-Eagle  
www.cisco-eagle.com  
888-877-3861



- PPE recommended: High visibility vest, Steel Toe Boots, Work Gloves, Ear Protection, Dust Mask, Eye Protection.
- Clean concrete dust by running the vacuum during drilling.

---

These instructions are for multiple versions of the SafeStop bollard. For simplicity only one version will be shown in each step.

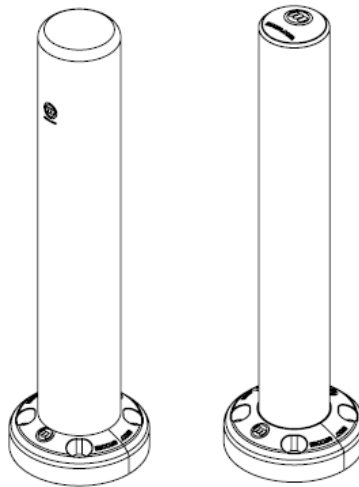

---

**1**

Select bollard location. Use Shock Absorber pieces to mark holes.

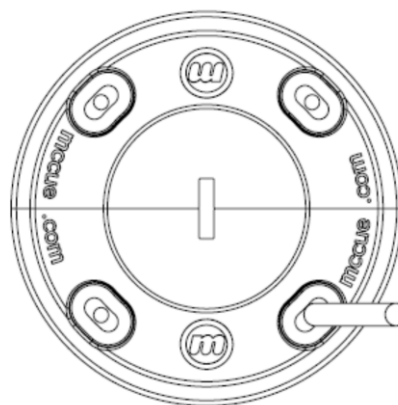
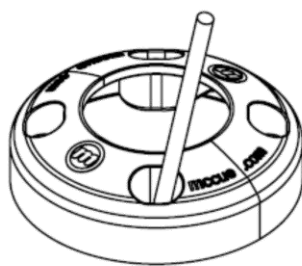

2

Drill 4 holes using ½" drill bit, 4-5/8" minimum depth.

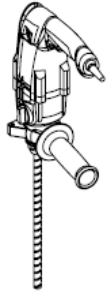

½" bit

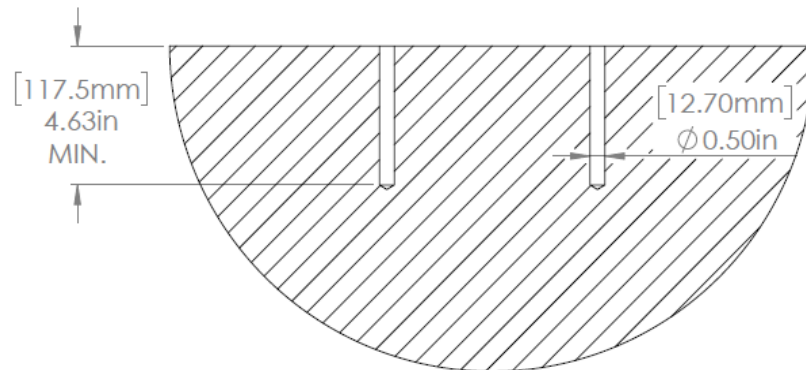

*HOLE DETAIL*

3

Install shock absorbers over baseplate.

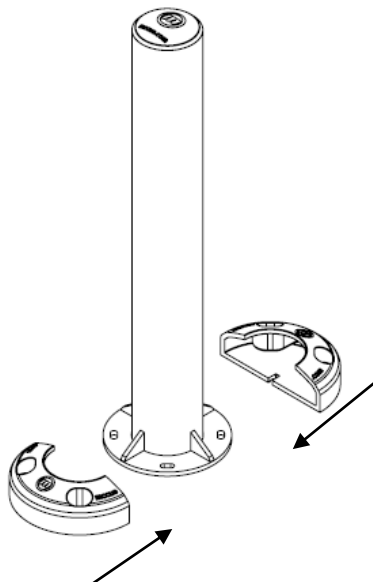

4

Move bollard post into place. Fasten to floor using  $\frac{1}{2}$ " concrete anchors through washers.

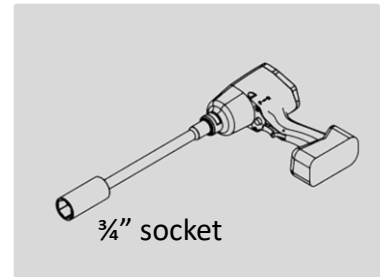
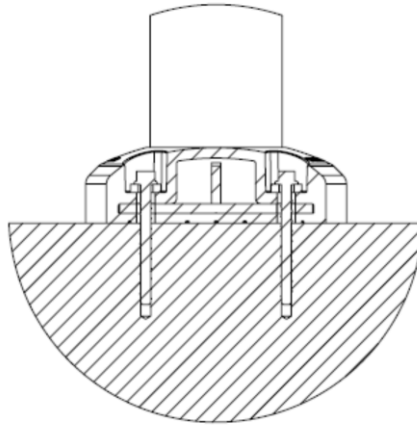
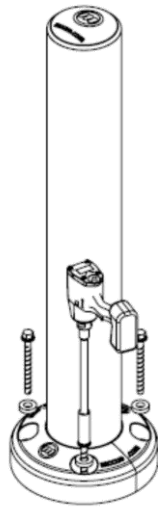

5

Install post cover (if applicable).

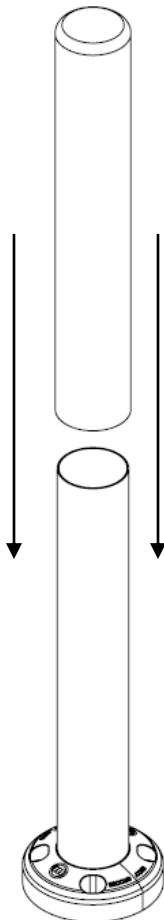

6

Installation complete.

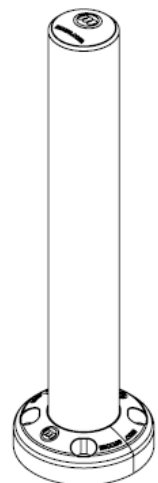

# SafeStop Pedestrian Swing Gate Add On Kit

## INSTALLATION INSTRUCTIONS

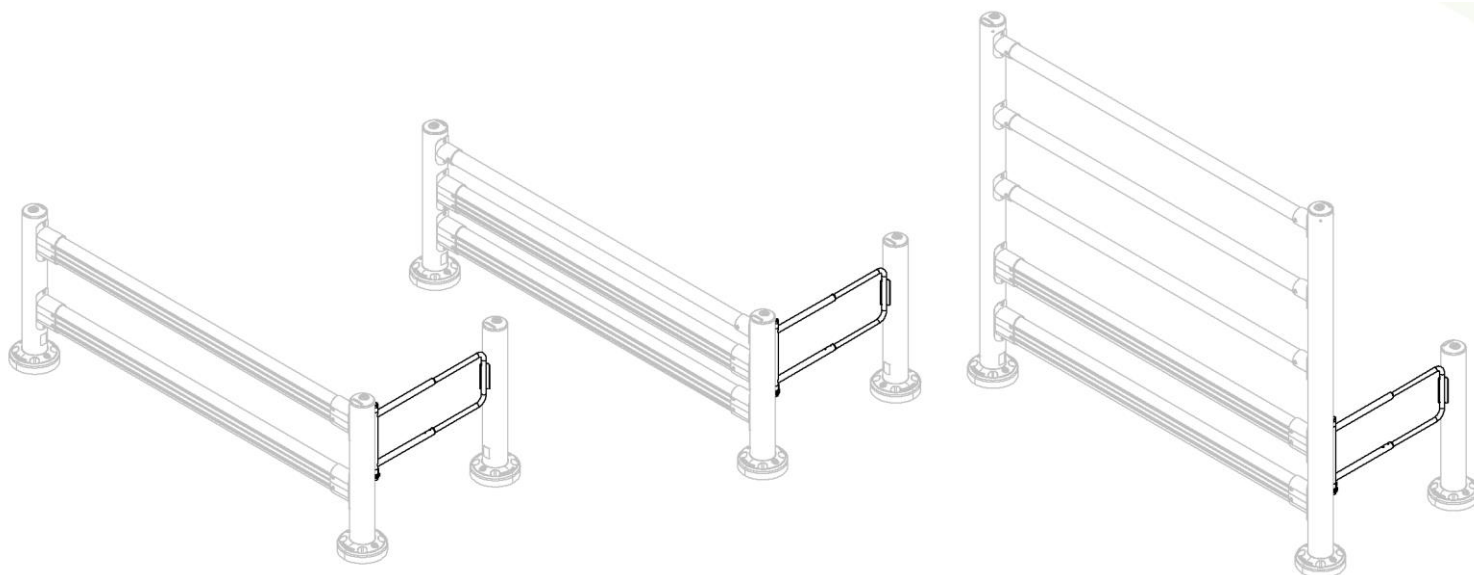

### Components

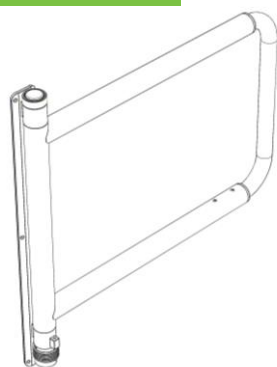

GATE



#12 X 1" HEX HEAD  
SELF DRILLING SCREWS

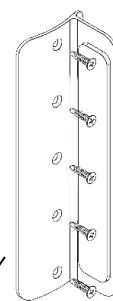

STOPPER

#8 X 3/4" PHILLIPS HEAD  
SELF DRILLING SCREWS

### Required Tools



#14(0.1820")  
Drill Bit



#29(0.1360")  
Drill Bit



5/32"  
Allen Key



Pencil



Razor  
Knife

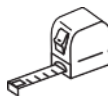

Tape  
Measure



Phillips  
Bit No.2

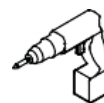

Drill or  
Impact

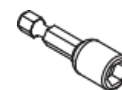

Nut Driver  
With 5/16" Bit



Questions

**McCue Corporation**  
Danvers, Massachusetts, USA  
+1 (800) 800 8503  
[customercare@mccue.com](mailto:customercare@mccue.com)

Distributed by Cisco-Eagle  
[www.cisco-eagle.com](http://www.cisco-eagle.com)  
888-877-3861

## Step 1

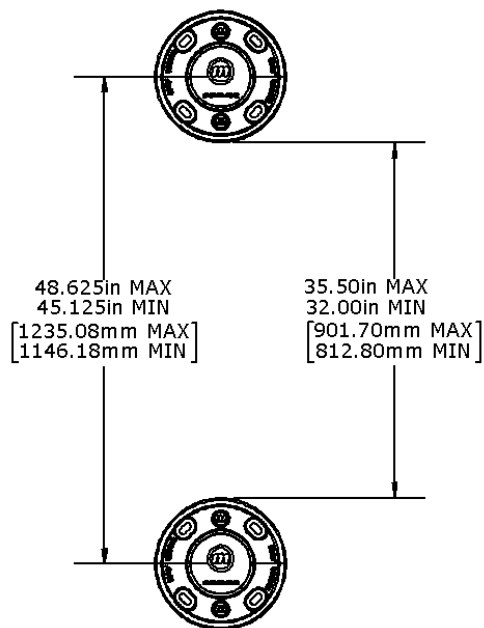

Install SafeStop Products with acceptable spacing as shown above. Refer to product specific installation instructions for Installation procedures.

## Step 2

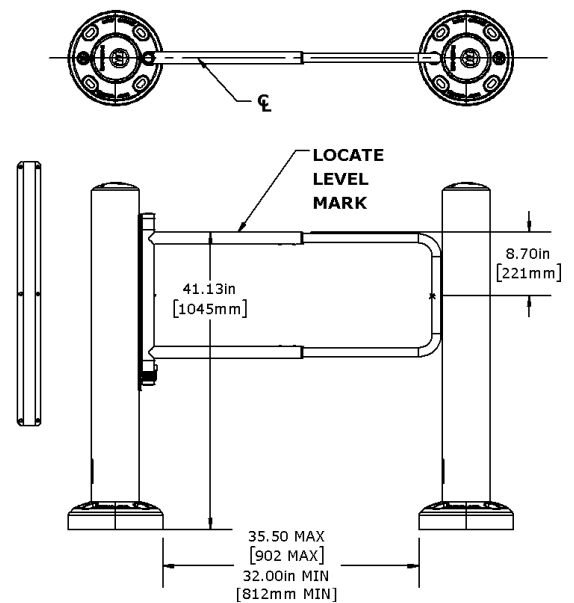

Locate gate on center and mark all the mounting hole locations.

## Step 3

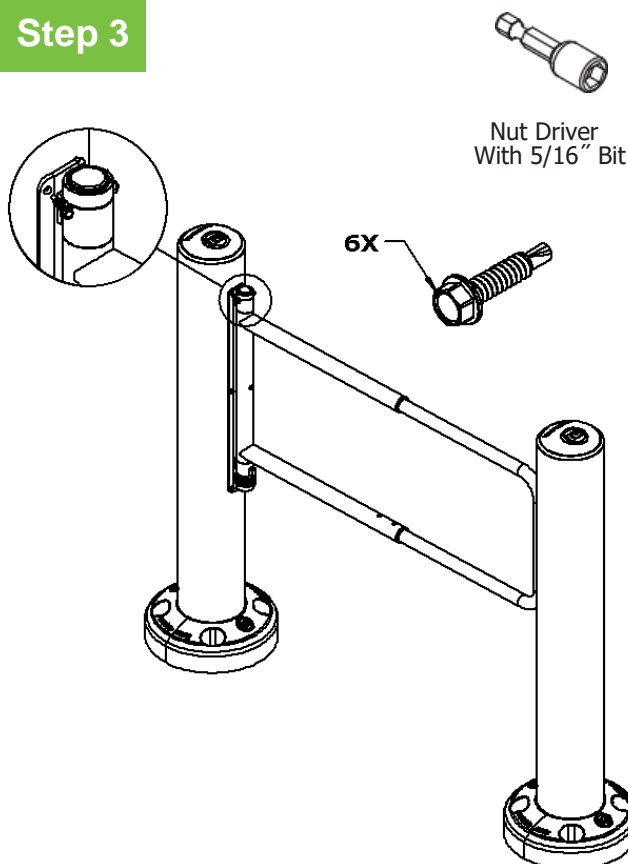

Secure using 5/16" Nut driver bit until flush.  
Do not over torque.

## Step 4

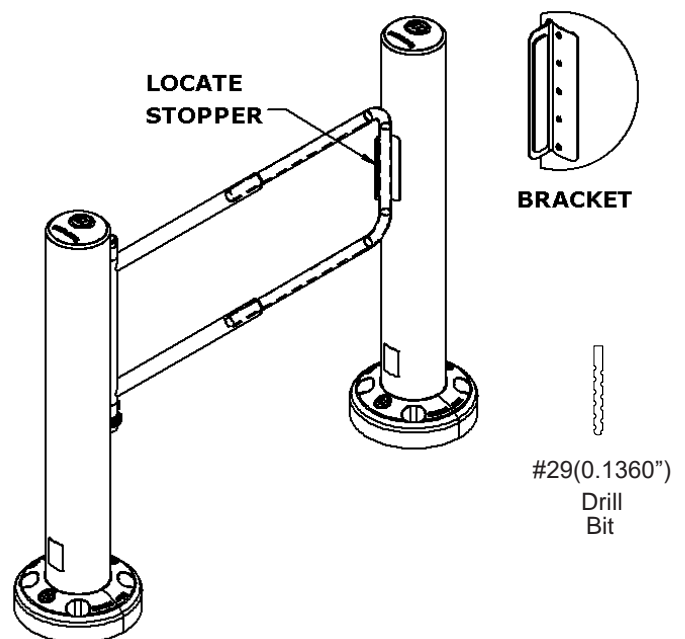

Mark hole locations and drill pilot holes using #29 drill bit.

## Step 5

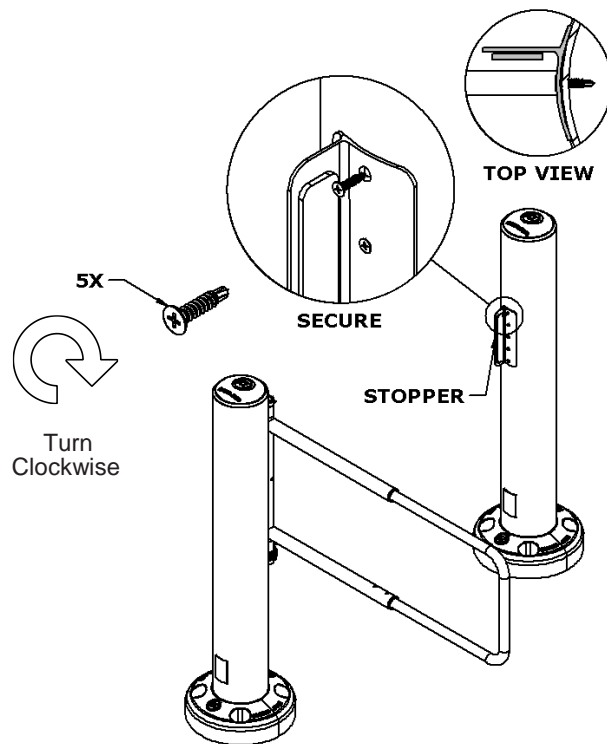

Secure using a drill with a Phillips bit until all screws are flush. Do not over torque.

## Step 6

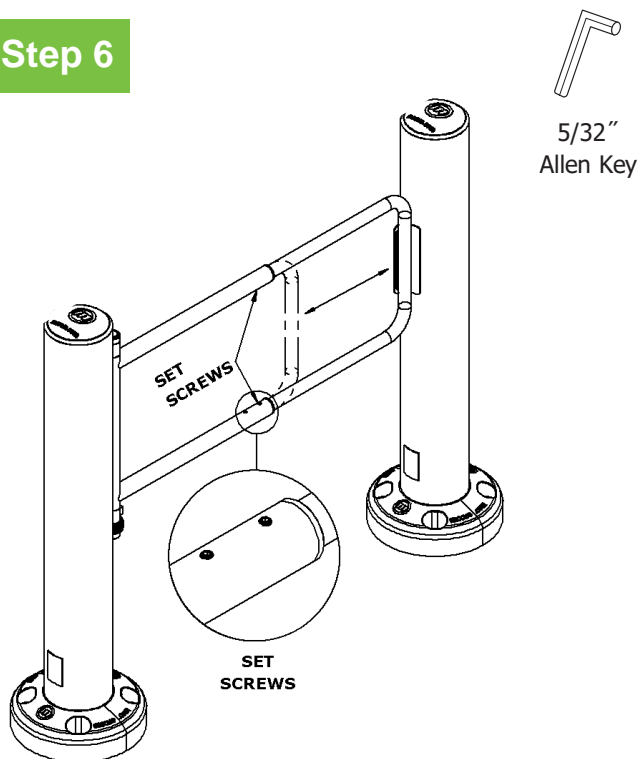

Telescoping arm can be adjusted by loosening set screws. Secure arm by tightening all set screws.

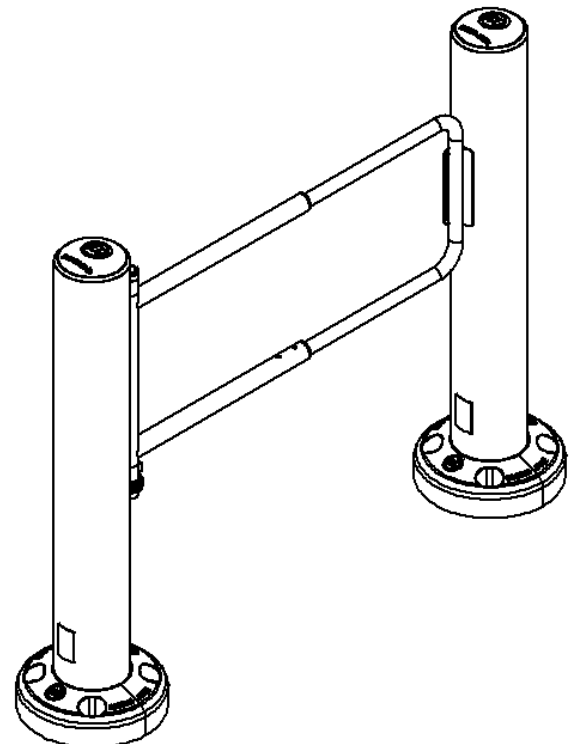

# SafeStop Spinner Add On

## INSTALLATION INSTRUCTIONS

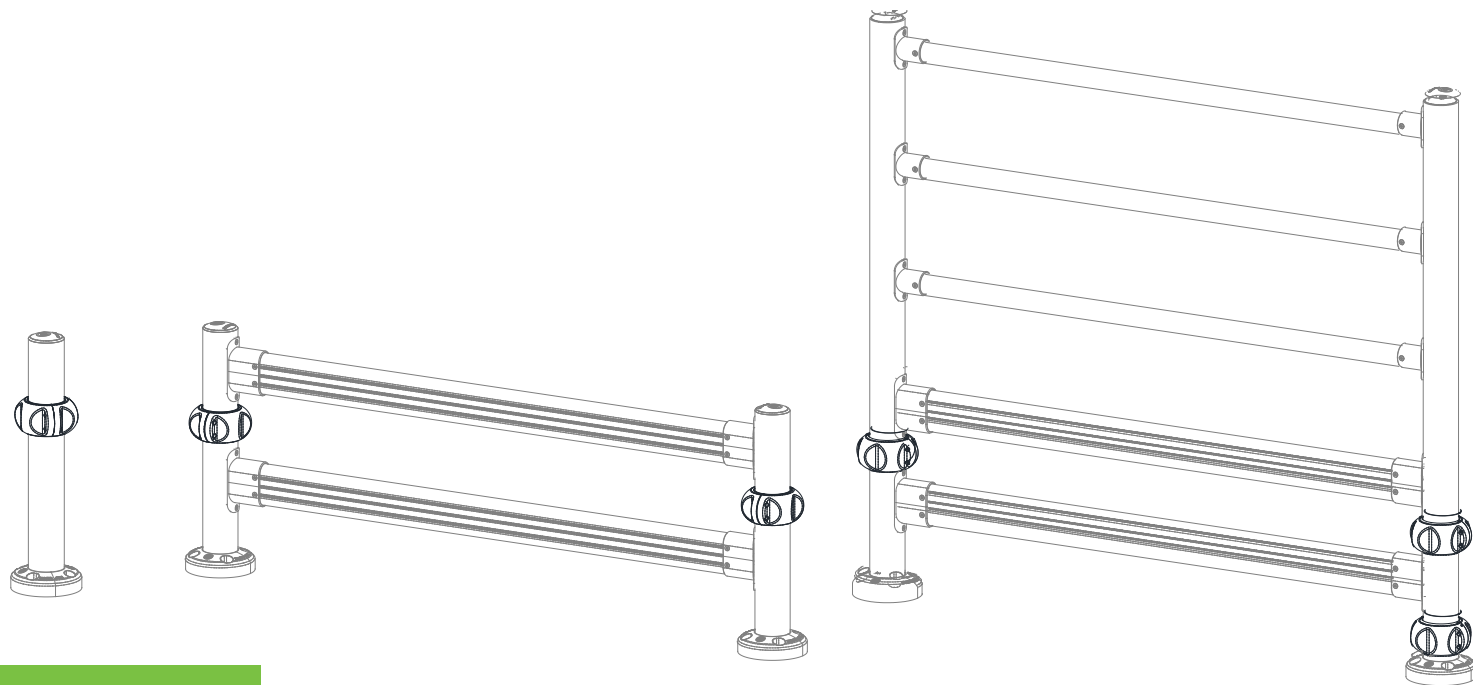

### Components

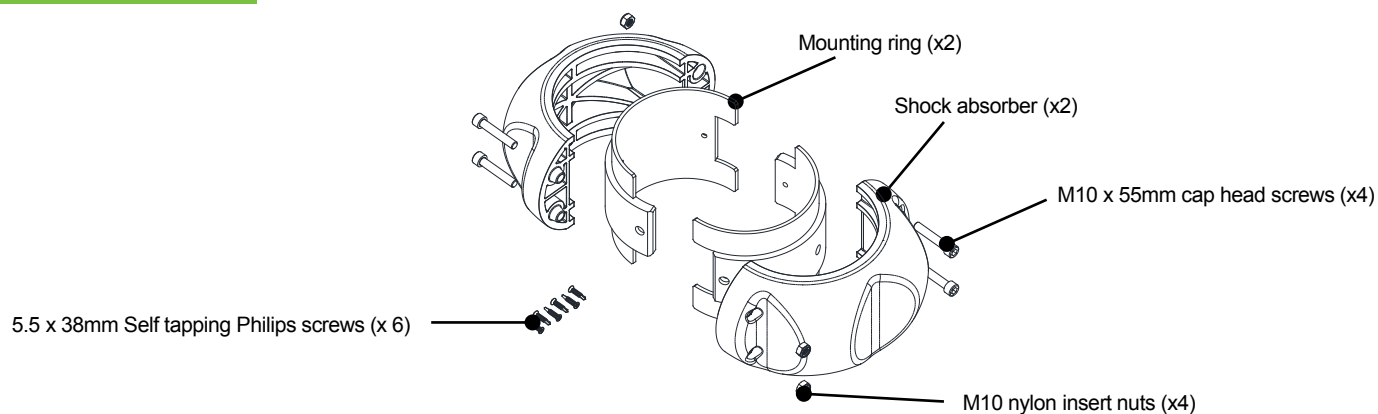

Kit: SSA-K-SPN

### Required Tools



Pencil/  
marker



Tape  
Measure



Drill



4mm [5/32"]  
HSS Drill Bit



Phillip's  
Screwdriver/drill bit



8mm  
Allen Key



**McCue Corporation**  
Danvers, Massachusetts, USA  
+1 (800) 800 8503  
[customercare@mccue.com](mailto:customercare@mccue.com)

Distributed by Cisco-Eagle  
[www.cisco-eagle.com](http://www.cisco-eagle.com)  
888-877-3861



# Recommended Install Heights

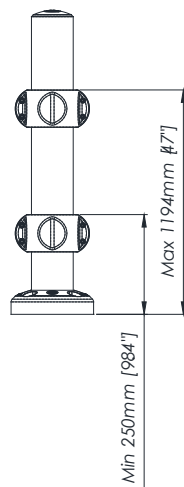

**SafeStop Bollard**

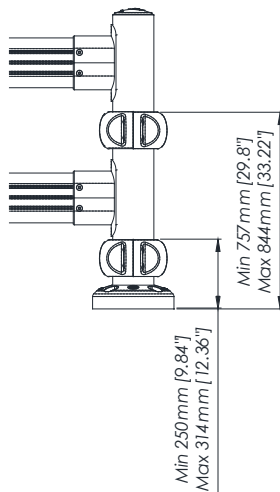

**SafeStop GuardRail**

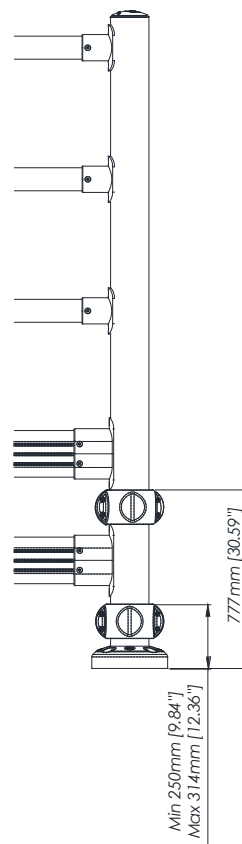

**SafeStop Topple Barrier**

## Step 1

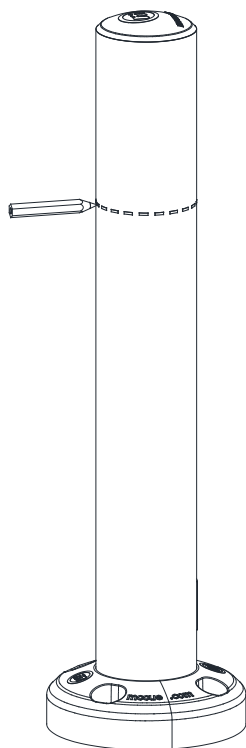

**Measure and mark out the top height required for the Spinner**

## Step 2

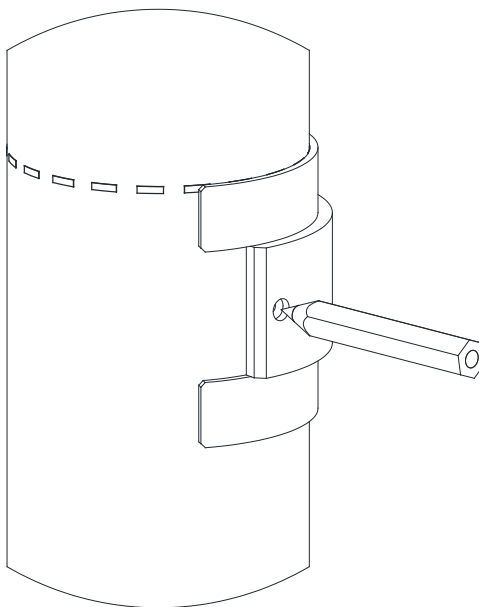

**Position the 1<sup>st</sup> half of the mounting ring ensuring it is straight marking the 3-hole locations**

## Step 3

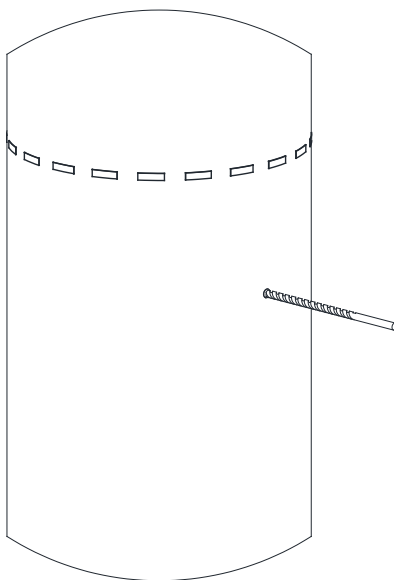

**Using a drill and 4mm [5/32"] HSS drill bit pilot hole the 3 marked hole locations**

## Step 4

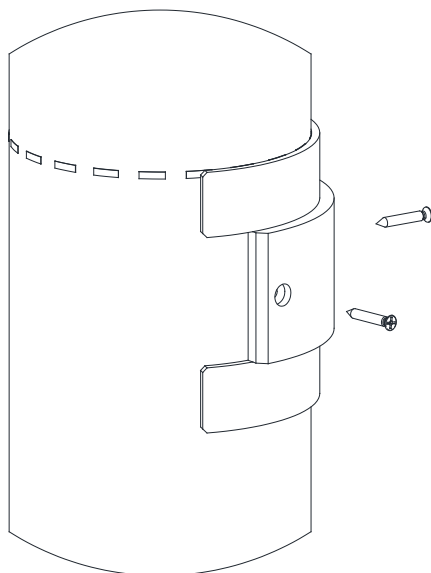

**Using the self tapping screws supplied reposition and secure the 1<sup>st</sup> half of the mounting ring**

---

## Step 5

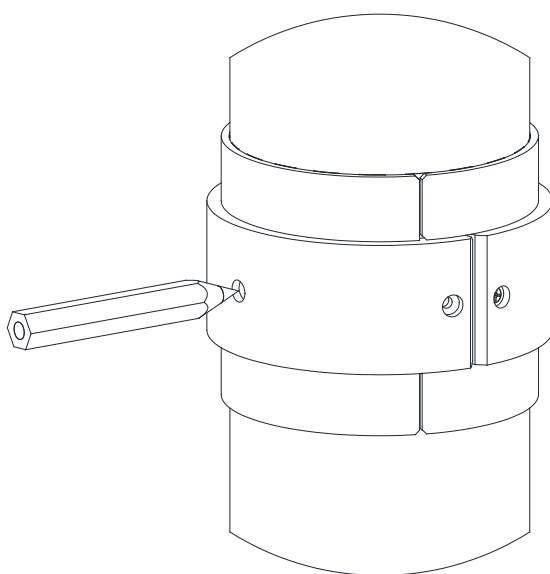

**Position the 2<sup>nd</sup> half of the mounting ring and mark the 3-hole locations**

## Step 6

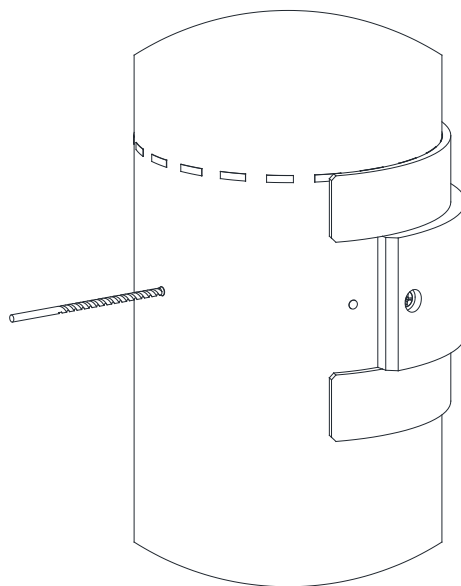

**Using a drill and 4mm [5/32"] HSS drill bit pilot hole the 3 marked hole locations for the 1st half of the mounting ring**

## Step 7

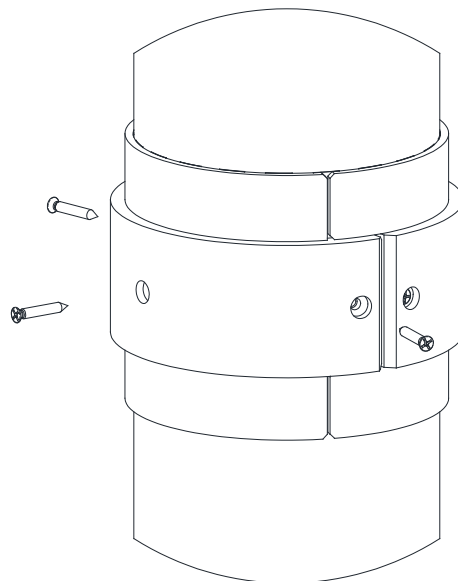

**Using the self tapping screws supplied reposition and secure the 2<sup>nd</sup> half of the mounting ring**

## Step 8

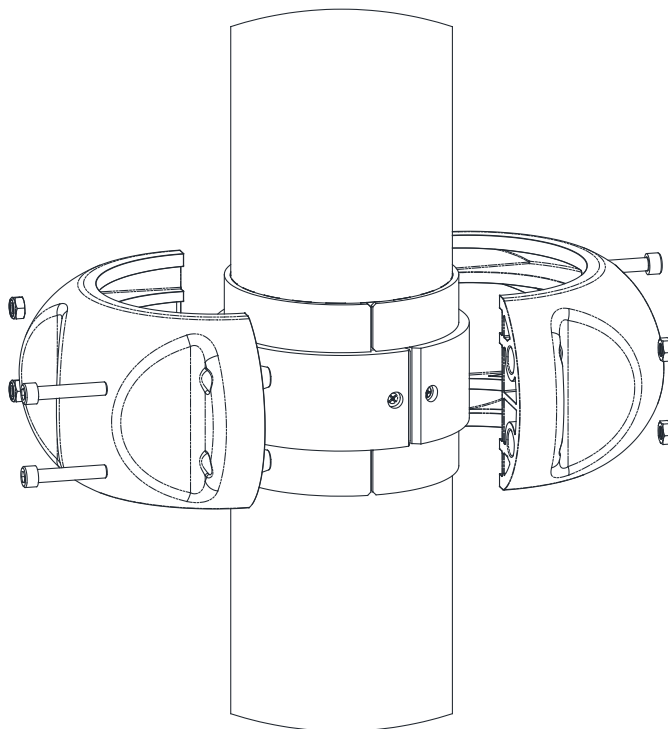

**Using the M10 cap head screws and nuts supplied secure the shock absorber around the fixed mounting ring**

## Step 9

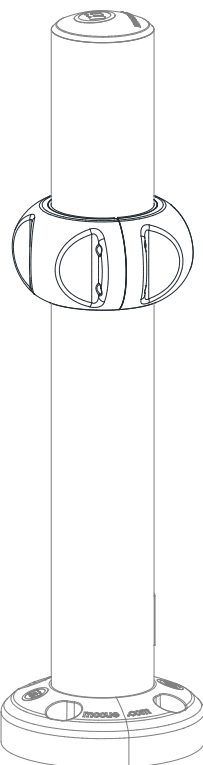

**Installation Complete**