



# Quick Start Guide

Bulletin #: V021516-01

Issue Date: February 15, 2016

## Thank You for Purchasing an Orion HPS/ LPS Flex Stretch Wrapper!

Your new FLEX stretchwrapper was designed to get up and running quickly upon delivery. This guide will help you begin using your machine effectively by providing step by step instructions in the basic operations of the machine. More advanced capabilities are described in the manual. For your convenience, there is an interactive on-screen troubleshooting guide under the Diagnostics screen. You can download the complete manual, electrical prints, and mechanical drawings at this location:

<http://www.orionpackaging.com/landing/flex-manual-download-S/>



## Unpacking

- Remove skidding/ packaging materials.
- Please inspect the machine for any fasteners that may have loosened in shipping. Although this is highly unlikely, long delivery distances may have an effect on fastener torque.
- Inspect for any obvious shipping damage and report to your machine provider.

Orion Packaging Systems \* A division of Pro Mach  
4750 County Road 13 NE Alexandria, MN 56308  
(800) 333-6556

<http://www.orionpackaging.com/landing/flex-manual-download-S/>



# Quick Start Guide

**Bulletin #: V021516-01**

**Issue Date: February 15, 2016**

## Positioning

- Move the machine by the integrated forklift tubes only.
- Picking up the machine at any other location can damage the equipment.
- Don't slide the equipment, lift and place only.
- Place the machine on level surfaces only. Un-level surfaces can cause excessive vibration. Shim if needed.
- Move the wrapper into its final position. If the turntable machine must be secured to the floor, we recommend that the wrapper base section be bolted to the floor by the 1/2" concrete floor anchors (leg & shield or expandable type-Red Heads).

## Connect Power

- Make sure the MAIN POWER switch on the wrapper's panel is set to the OFF position.
- Orion Packaging insists that a dedicated circuit is used for this wrapper. Extension cords are not allowed and can void your warranty.
- Plug the machine into the 115 VAC/ 60 Hz/ 1 Phase / 15 Amp outlet.

## Power Up / Boot Up

- After verifying that the area around the machine is safe, you may apply power to the machine by turning the MAIN POWER switch to the ON position.
- Please allow 30 seconds before pressing any buttons to allow the program to boot up.
- Release the E-stop button.
- Press and release the Start button once to gain Control Power.
- Initializing will display in the information banner momentarily.
- See jogging on the next page to begin testing your machine.

Orion Packaging Systems \* A division of Pro Mach  
4750 County Road 13 NE Alexandria, MN 56308  
(800) 333-6556

<http://www.orionpackaging.com/landing/flex-manual-download-S/>

## Jogging

- Go to the Menu Screen. Choose Jogging.
- It's advisable to jog the machine prior to wrapping your first load to ensure components run smoothly and there are no mechanical binds caused by shipping.
  - Press and hold the Main Drive button to jog the turntable. Allow it to travel about one full revolution, then release the button.
  - Press and hold the Carriage Up button. Allow it to travel to the adjustable top stop on the mast, then release the button.
  - Press the Home Machine button to bring the Turntable and Carriage back to the Home position.

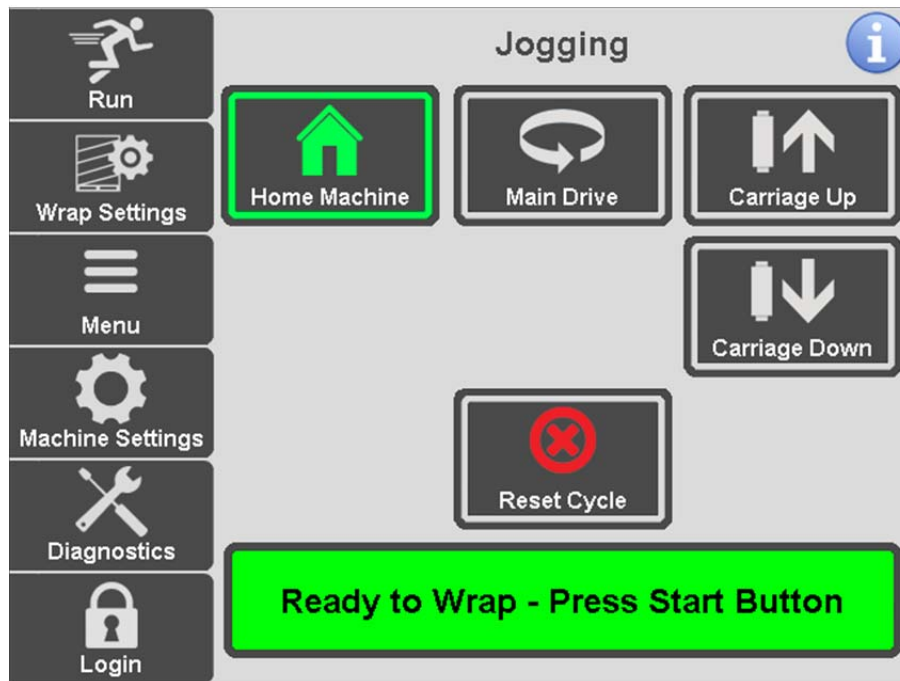



# Quick Start Guide

Bulletin #: V021516-01

Issue Date: February 15, 2016

## Set Up Load

- Carefully place the load to be wrapped on the turntable. Be sure the load is centered and stable.

## Load the Film

- The film roll can be loaded on the carriage mandrel from either end of the roll. When using tacky film, please verify that the tacky surface of the film is inward on the load.
- Press in the E-stop.
- Swing up the top mandrel spool.
- Put the roll of film on the bottom mandrel.
- Install the top mandrel on top of the roll to prevent upward movement.
- Press the latch down and pull out on the carriage door to open the carriage. The film carriage is equipped with a magnetic switch that detects when the carriage threading door is open. When opened, it will set off an alarm on the HMI and prevent the carriage from moving.
- Pass the roped tail of the film through opening.
- Close the carriage door. Ensure the latch clicks shut properly.
- When the film feeding is completed, release the E-stop.
- For machines without a fence, press the Start button once to reset control power. If your machine has a fence, the multistretch will reset as soon as the E-stop is released.
- Peel off the first few winds of the film (multistretch will run due to displacement of the dancer roller) and fix the film end onto the load-or film clamp if so equipped.
- The system is now ready to begin the first wrapping cycle.



Orion Packaging Systems \* A division of Pro Mach  
4750 County Road 13 NE Alexandria, MN 56308  
(800) 333-6556

<http://www.orionpackaging.com/landing/flex-manual-download-S/>



# Quick Start Guide

Bulletin #: V021516-01

Issue Date: February 15, 2016

## Running a Test Load

Now that you have the machine unloaded, unpacked, the film is loaded, you've jogged all components, and a load is ready to wrap, let's run a test wrap.

- Go to the Run Screen.
- Attach the film tail to the load.
- Release the E-stop button.
- Press the Start button once to reset control power.
- Toggle to Low Speed Mode on the Run Screen.
- If everything is clear and you are ready to run, press and hold the Start button for the amount of time set in the machine settings to start the machine.
- Allow the load to wrap.
- Since you still have control power present, you may toggle to high speed mode, then press Start Cycle on the HMI to wrap the load again in high speed mode.
- When the carriage is half way up the load, press Reinforce. The number of reinforce wraps set on the HMI will be applied then the load will continue its cycle.
- The Reset Cycle button will either stop the current wrap cycle or reset any displayed faults.



Orion Packaging Systems \* A division of Pro Mach  
4750 County Road 13 NE Alexandria, MN 56308  
(800) 333-6556

<http://www.orionpackaging.com/landing/flex-manual-download-S/>

## Adjusting Wrap Settings

- To adjust the wrap setting, you must be logged in. Press the login button in the bottom left corner of the screen
- Enter the password then press the checkmark, then X to close the keypad.
- Press the Wrap Settings button to display the Wrap Settings Screen.
- Press the Top Wraps button to set the number of top wraps applied to the load. Parameters are 1-20.
- Press the Bottom Wraps button to set the number of bottom wraps applied to the load. Parameters are 1-20.
- Press the Carriage Up Speed % button to change the speed of the carriage on the upward move, in terms of percentage. Min - 5% Max - 100% The slower the move, the more film overlap on the load.
- Press the Carriage Down Speed % button to change the speed of the carriage on the downward move, in terms of percentage. Min - 5% Max - 100% The slower the move, the more film overlap on the load.
- You may choose more advanced wrap settings for Wrap Direction, Speed Selection, and Autoheight or Film Fault Enable/ Disable. See your manual for more information on these wrap setting adjustments.

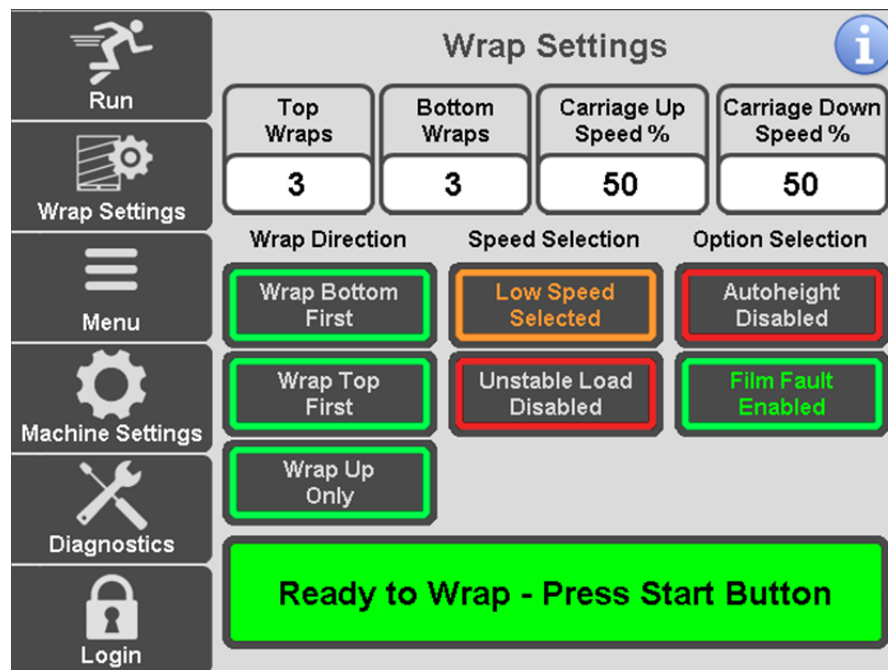

Orion Packaging Systems \* A division of Pro Mach  
4750 County Road 13 NE Alexandria, MN 56308  
(800) 333-6556

<http://www.orionpackaging.com/landing/flex-manual-download-S/>

## Wrap Recipes

- Press the Menu, then Recipes.
- The Wrap Settings parameters set on the previous page are saved to the highlighted "Running Recipe." You may set ten Wrap Recipes and name each.
- For example, if you are running a fragile light product and a heavy sturdy product, you would want to set up a recipe for each type of load. The light fragile load would have Wrap Top First and Unstable Load Selected, for instance. When you change to the sturdy load, you would want to quickly select the sturdy load on the recipe screen instead of changing the wrap parameter each time.
- Whichever Recipe you have selected on this screen is the recipe you are adjusting on the Wrap Settings, Main Drive, Reinforce, and Timer Screens.

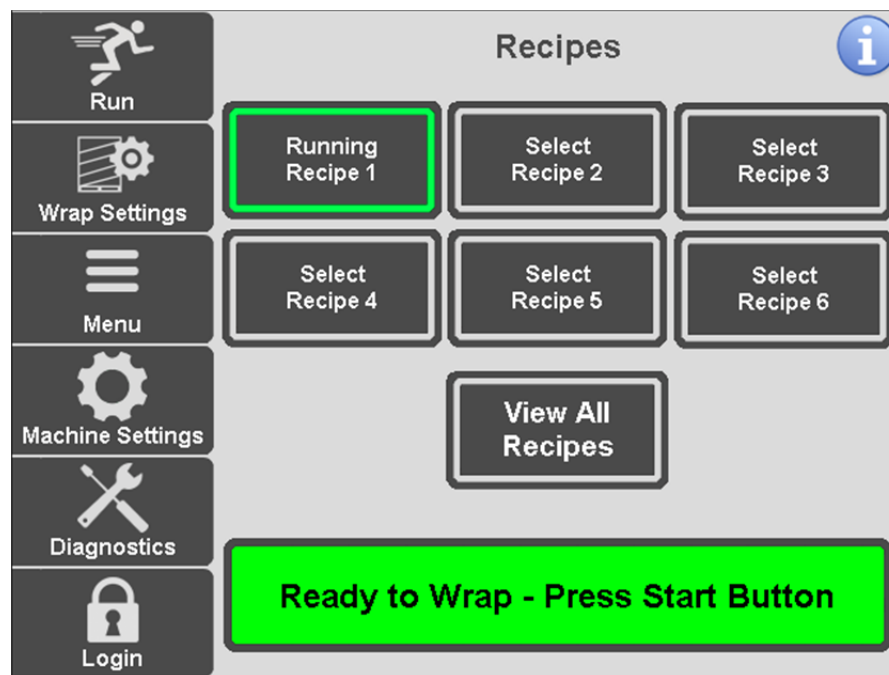

## View All Recipes

- On the Recipes Screen, press View all Recipes.
- This screen is used to view the parameters you've set up for each recipe.
- You may press Next and Previous to scroll through each recipe to view their parameters.
- On this screen, you can edit the name of each recipe. To edit the name of the recipe, press the "Recipe #" box at the top of the page. A keypad appears to rename the recipe to rename to something more intuitive. For example, you may want to rename the loads from the previous page "Fragile" and the other "Sturdy."

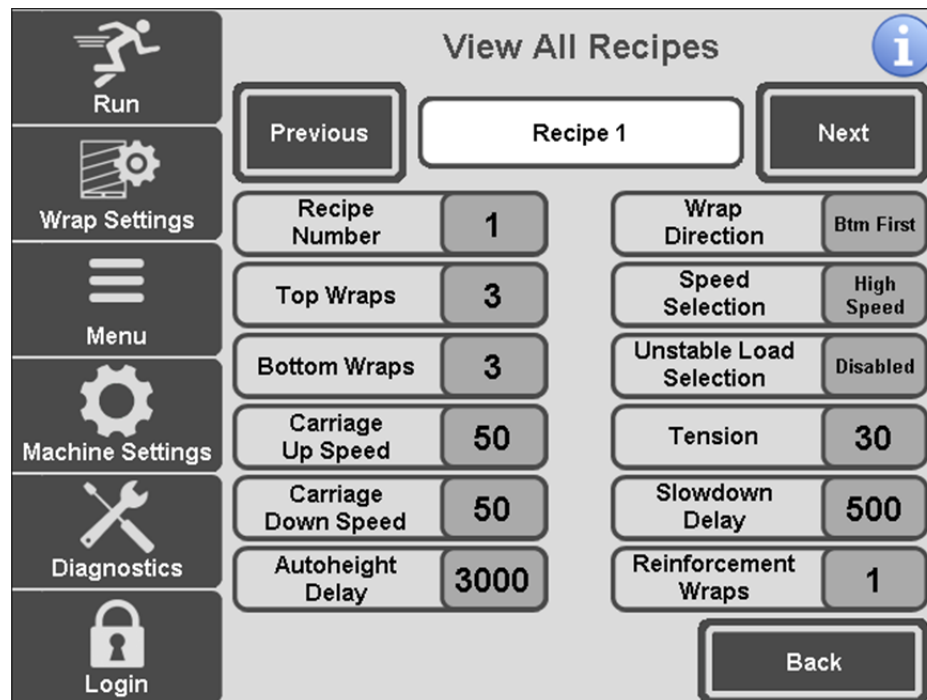





# Quick Start Guide

Bulletin #: V021516-01

Issue Date: February 15, 2016

## Reinforce Wraps

- You may set the number of reinforce wraps applied when the Reinforce button is pressed on the Run screen.
- To adjust the reinforce settings, you must be logged in. Press the login button in the bottom left corner of the screen.
- Enter the password then press the checkmark, then X to close the keypad.
- Press the Machine Settings button to display the Machine Settings Screen.
- Press Reinforce to display the Reinforce Wraps Setting Screen.
- Press the number under Reinforce to display the numeric keypad.
- Enter the number of reinforce wraps you desire to apply when the reinforce wraps button on the Run screen is pressed.
- Press Enter.

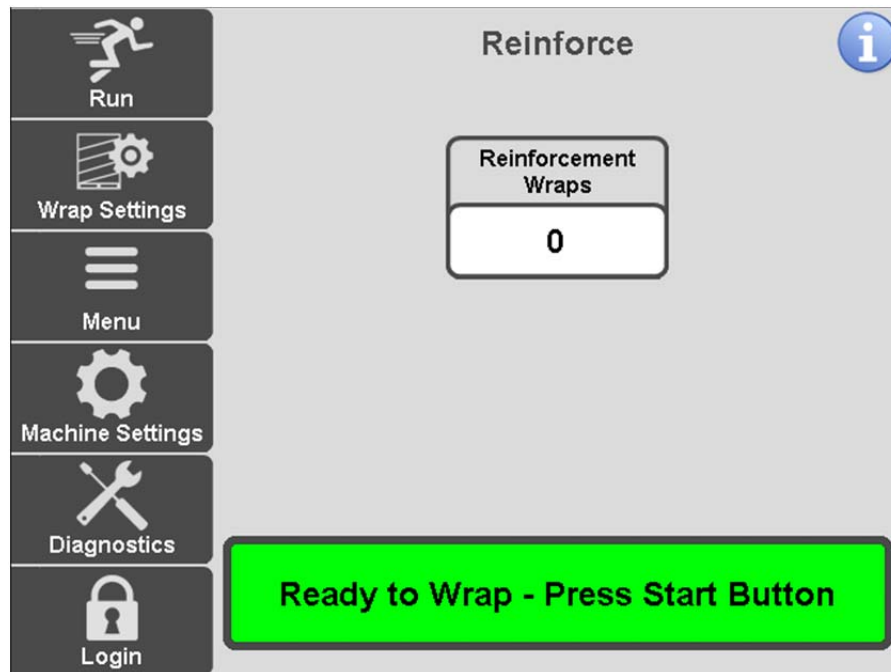

**There are additional adjustments you can make on the HMI. For complete details, see your user manual.**

Orion Packaging Systems \* A division of Pro Mach  
4750 County Road 13 NE Alexandria, MN 56308  
(800) 333-6556

<http://www.orionpackaging.com/landing/flex-manual-download-S/>