

EDGEHALT™

Adjustable Safety Gate

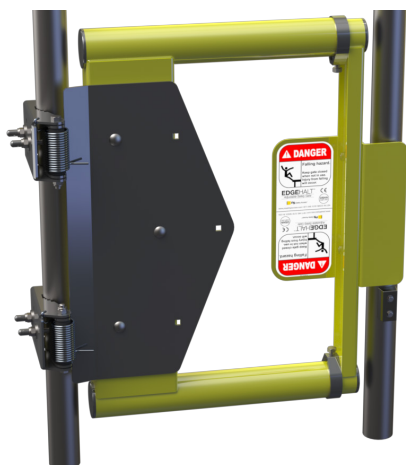

Installation Instructions/Operation and Maintenance Manual



Models:

US Model

Table of Contents:

Safety Precautions	2
Product Information	2
Operation	3
Installation	4
Replacement Parts	8
Inspection and Maintenance	10
Warranty Certificate	11

Contact Information

Mail

PS Safety Access
1150 South 48th Street
Grand Forks, ND 58201

Local Phone

701.746.4519

Toll Free Phone

877.446.1519

Hours of Operation

8 A.M. to 5 P.M. CT
Monday – Friday

IMPORTANT! Read entire Instruction and Operations Manual to become familiar with the product.

NOTICE This product is a fall protection product. The effectiveness of the product is directly related to the proper installation and operation of this product. Failure to properly maintain this product **will** affect performance.

Publication Notice

This manual has been compiled and published covering the latest product descriptions and specifications.

The contents of this manual and the specifications of this product are subject to change without notice.

PS Safety Access reserves the right to make changes without notice in the specifications and materials contained herein and shall not be responsible for any damages (including consequential) caused by reliance on the materials presented, including but not limited to typographical and other errors relating to the publication.

PS Safety Access and/or its respective suppliers may make improvements and/or changes in the product(s)/ service(s) offered and/or the program(s) at any time without notice.

Retain this manual for future reference.

If you would like to download a copy of this manual, please go to pssafetyaccess.com

Product registration is an essential step to protecting your product, register Online at psindustries.com/contact/register-your-product/



Safety Precautions

The following icons are used throughout this Manual.

- ▲ DANGER** Indicates an imminently hazardous situation which, if not avoided, will result in death or serious injury.
- ▲ WARNING** Indicates a potentially hazardous situation which, if not avoided, could result in death or serious injury.
- ▲ CAUTION** Indicates a potentially hazardous situation which, if not avoided, may result in minor or moderated injury.
- NOTICE** Indicates manufacturer's statement of additional information.
- IMPORTANT!** Indicates a required action.
- CRITICAL** Indicates a vital component to product performance.

Product Information

NOTICE Unauthorized modification of or to the product voids this Limited Warranty. Authorized modifications, received in writing from PS INDUSTRIES INCORPORATED, as long as the modification is accomplished in strict accordance with PS INDUSTRIES INCORPORATED's instructions, does not void warranty. To request product modifications contact PS INDUSTRIES INCORPORATED, 1150 S. 48th Street, Grand Forks, ND 58201, phone 877-446-1519, email: 4psinfo@psindustries.com

I. General Information

- A. This manual contains information regarding installation, operation, and maintenance of the PS Safety Access' EdgeHalt™ Adjustable Safety Gate.
- B. PS Safety Access recommends that the owner implement a regular maintenance program to inspect the Adjustable Safety Gate as necessary.

II. Operation Guidelines

- A. The Adjustable Safety Gate is designed to meet OSHA Railing Standard 1910.29(b), ANSI A1264.1-2017, ANSI-ASC A14.3-2008, Canada OHS SOR-84-304 Part II.
- B. Operation in a manner other than intended could result in damage or less than acceptable performance at time of need, for which the manufacturer will not be held responsible.
- C. The Adjustable Safety Gate shall NOT be installed in a potentially explosive atmosphere.

III. Safety Precautions

- A. Ensure opening is clear of all obstructions through the entire proposed travel of the Adjustable Safety Gate during operation.
- B. Comply with all local safety regulations and/or company safety policies when installing.

- ▲ DANGER** An unprotected opening is a fall hazard, installation personnel use proper fall protection equipment.
- ▲ DANGER** Ensure area below installation is blocked off from personnel during installation, and mounting surface is capable of supporting all loading. Structural analysis of mounting surface is the responsibility of the owner.

IV. Storage Prior to Installation of Product

- A. Store materials in a dry, ventilated location. If outdoor storage is required, block materials and tarp in a tent-like arrangement, elevated above the product with open sides to allow airflow.

V. Installation Site Preparation

NOTICE Before starting site preparation and installation of the Adjustable Safety Gate, read the entire Operation and Maintenance Manual and review all installation instructions thoroughly.

- A. Clear work area of any debris.
- B. Ensure you have the necessary tools available.
- C. Obtain all required permits.
- D. Personnel: Determine the appropriate number of personnel required to perform installation and have them readily available at the project site. (1-2 people recommended)

[illegible]

Recommended Standard Tools:

1. One (1) 1/2" Deep-well Socket and Ratchet
2. One (1) Tape Measure
3. One (1) Torque Wrench
4. One (1) Impact Drill w/ 3/8" Nut Driver

ASG Part List

(As shipped)

Hardware Bag Part List

(As shipped)

The diagram shows an exploded view of a mechanical assembly. On the left, a circular component (11.7) with a central hole is shown. Below it is a small rectangular component (11.8) with a central hole. Below that is a small rectangular component (11.9) with a central hole. On the right, a U-shaped component (11.1) is shown. Below it is a small circular component (11.2) with a central hole. Below that is a small rectangular component (11.3) with a central hole. Below that is a small rectangular component (11.4) with a central hole.

- A. When ascending a ladder/entering the elevated platform:
 1. When the gate opening is reached, obtain a firm grip on the railing or ladder.
 2. Step through gate.
 3. DO NOT USE THE ADJUSTABLE SAFETY GATE AS A GRAB SURFACE.
- B. When descending a ladder/exiting the elevated platform.
 1. Open the Adjustable Safety Gate and obtain firm grip on railing.
 2. Maneuver yourself into the proper ladder descending position. DO NOT USE THE ADJUSTABLE SAFETY GATE AS A GRAB SURFACE.
 3. Always maintain a firm grip on the railing or ladder

Installation

VII. Installation

STEP 1. Adjust bolts in hinge plate for proper opening width.

Step 1 Illustration

STANDARD RAILING MOUNT
(A) Hole Locations: (As shipped)
18" - 32" Opening Width

FLAT SURFACE MOUNT
(A) Hole Locations: (As shipped)
20 1/2" - 34 1/2" Opening Width

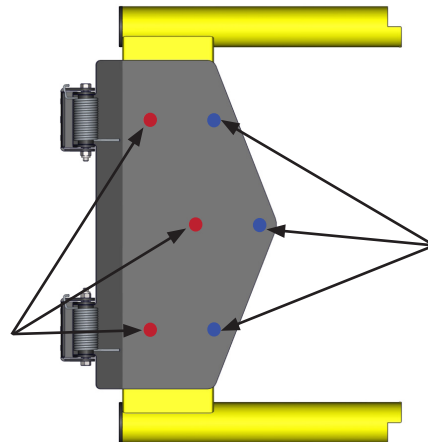

STANDARD RAILING MOUNT

(B) Hole Locations:
32" - 36" Opening Width

FLAT SURFACE MOUNT

(B) Hole Locations:
34 1/2" - 38 1/2" Opening Width

STEP 2. Orient swing direction so gate opens into platform. Align top of gate flush with top of railing or 42" above walking surface.

— If Mounting on Standard Railing up to 2" O.D. Round or 1 1/2" x 1 1/2" Square.

- Loosely attach the Adjustable Safety Gate to the railing with the 5/16" U-bolts. (See Illustration A)
- Align railing/mounting bracket to be perpendicular (90°) to Adjustable Safety Gate opening, tighten U-Bolts. (See Illustration C on page 5)

— If Mounting on Angle Iron Railing, Flat Bar, or Flat Wall Surface.

- Match drill holes into the flat wall surface (two per railing bracket). (See Illustration B)
- Insert appropriate mounting fasteners through railing brackets into flat mounting surface. (Mounting fasteners provided by others, NOT PS Safety Access). (See Illustration D on page 5)

▲ WARNING Tighten all fasteners to 140 in-lbs of torque.

Step 2 Illustration A

STANDARD RAILING MOUNT

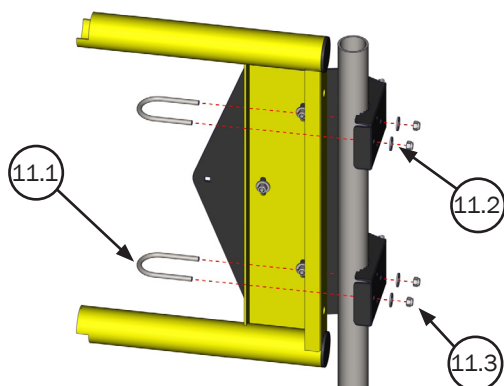

Step 2 Illustration B

FLAT SURFACE MOUNT

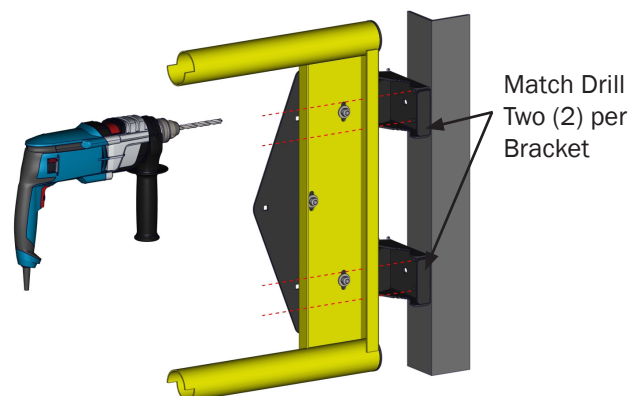

Installation

Step 2 Illustration C

STANDARD RAILING MOUNT

TOP VIEW

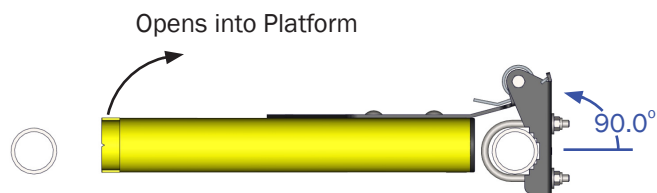

Step 2 Illustration D

FLAT SURFACE MOUNT

TOP VIEW

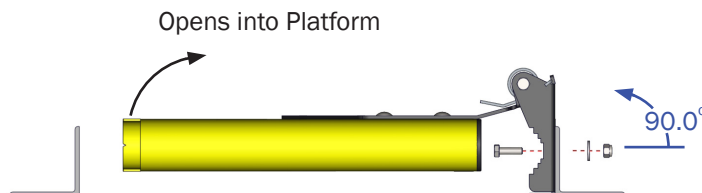

NOTICE Flat surface mounting fasteners not included.

Recommended Hardware for mounting to Angle Iron or Flat Bar Railing:

Minimum $\frac{5}{16}$ " grade 5 Hex head bolts of appropriate length with washers and self-locking nuts.

Recommended Hardware for mounting to Flat Wall Surface:

Use mechanical or chemical fastener, sized appropriate, for mounting material and loading requirements.

STEP 3. Slide provided $\frac{5}{16}$ " jam nut into black aluminum tube clamp ring and thread $\frac{5}{16}$ " hex bolt into nut.
a. Slide tube clamps onto each tube of small hoop.

Step 3 Illustration A

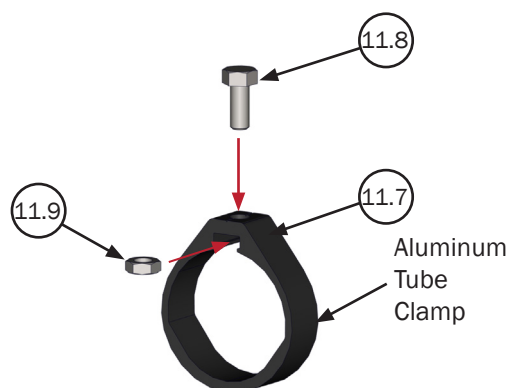

Step 3 Illustration B

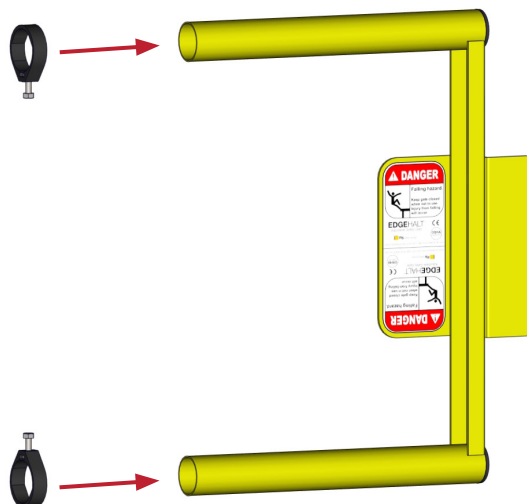

Installation

STEP 4. Insert small hoop into large hoop, slide tube clamp ring onto corresponding large hoop tube.

NOTICE To protect the finish, do NOT slide beyond desired length.

**Step 4
Illustration**

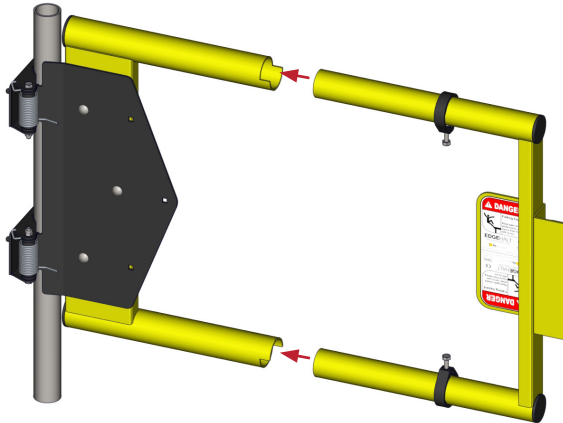

STEP 5. Adjust to proper opening width by sliding until strike overlaps railing (minimum of 1" strike overlap).

- Ensure the tube clamp is fully seated onto the large tube and the bolt is aligned with the guide arrow in the large tube. (Refer to Detail A)
- Tighten bolt in tube clamp ring to 140 in-lbs.

*Maximum allowed hoop dimension is 30" (steel tube only, not including caps) to ensure adequate overlap of telescoping tubes.

NOTICE If no stop surface is available for the strike plate to rest against, install stop surface (Provided By Others, NOT PS Safety Access), using appropriate anchoring hardware and material, to withstand all loading requirements. Align with strike and provide a minimum of 1" strike overlap.

**Step 5
Illustration A**

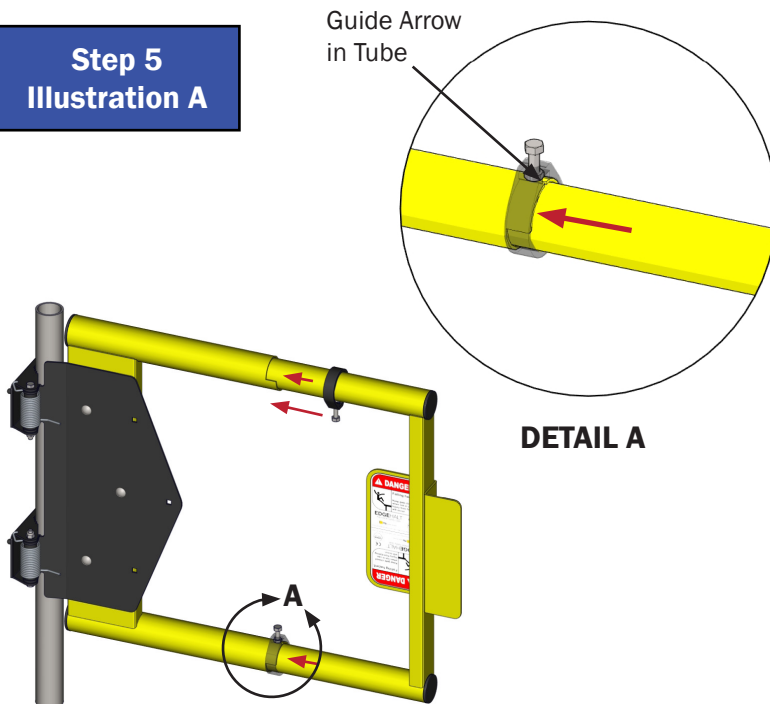

**Step 5
Illustration B**

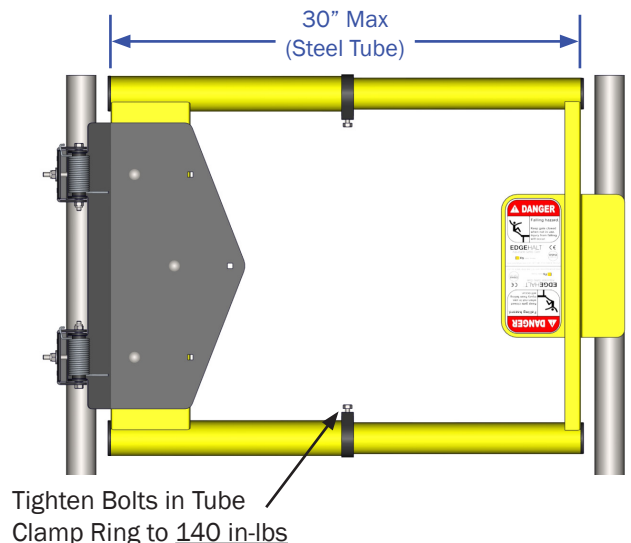

Installation

STEP 6. Operate the gates through full swing range to check for proper alignment and closing force.

STEP 7. Install plastic protective thread caps (optional).

- a. If additional vertical adjustment is required, loosen nuts on back side of large hoop with slotted adjustment holes, adjust to the appropriate height, and re-tighten.

▲ WARNING Tighten all fasteners to 140 in-lbs of torque.

**Step 6
Illustration**

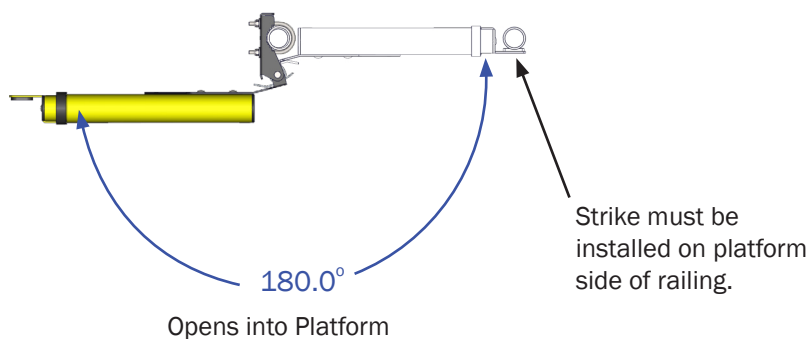

**Step 7
Illustration**

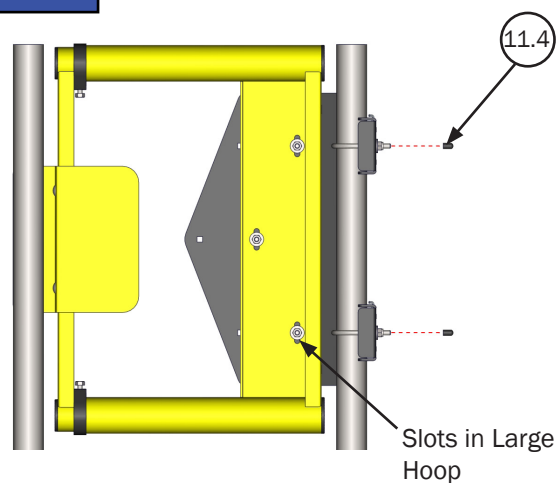

STEP 8. Utilize provided self-drilling screws, and fasten support block to railing.

CRITICAL Strike must be installed on the platform side of railing.

▲ DANGER Installation of strike support block is critical for safety loading requirements.

**Step 8
Illustration**

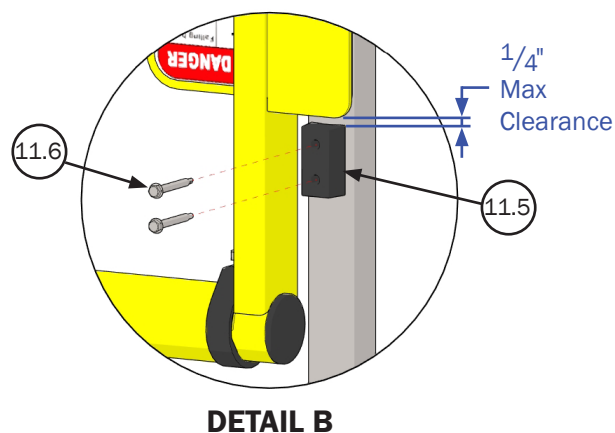
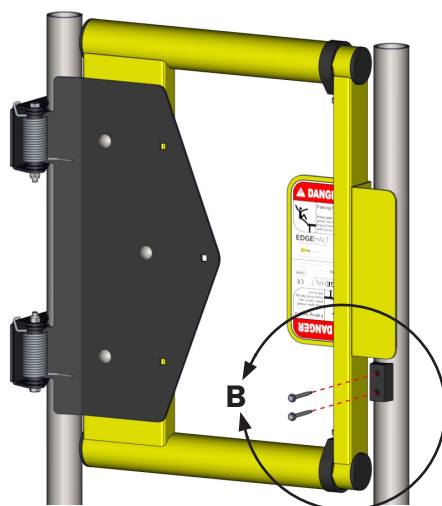

FINAL STEP. Personnel in charge of installation to verify Adjustable Safety Gate operates and closes properly.

▲ WARNING Field verify attachment of the safety gate can withstand all loads required.

Replacement Parts List

VIII. Replacement Parts List

NOTE 1. This replacement parts list is for the PCY Model.

NOTE 2. Parts diagram is located on Page 9.

TO ORDER PARTS CONTACT PS SAFETY ACCESS
877.446.1519 or
4psinfo@psindustries.com

FINISH OPTIONS	
PCY	Powder Coat Safety Yellow/Black

EdgeHalt™ Adjustable Safety Gate: PCY
 Approximate Assembled Weight: 31 lbs

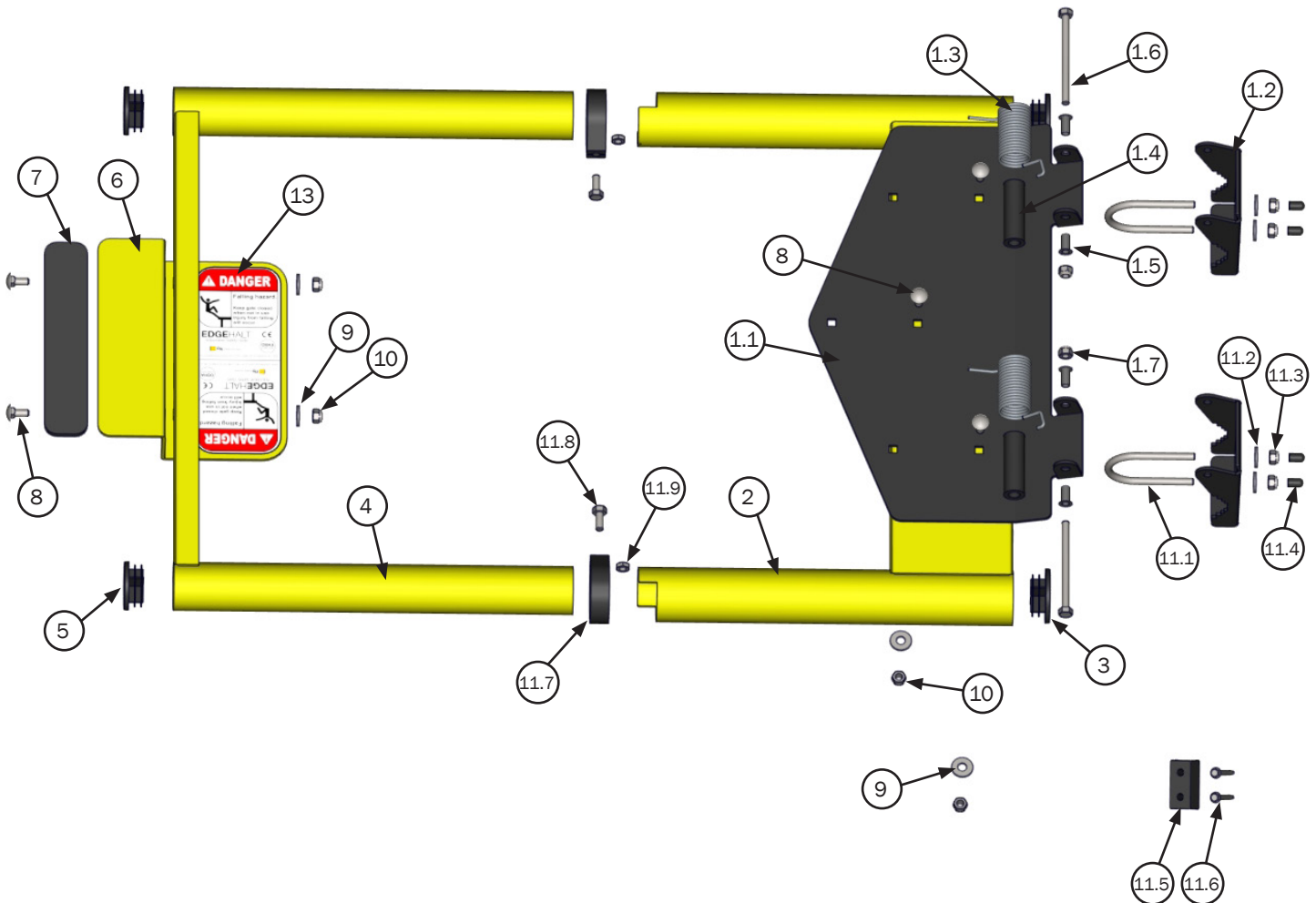

Replacement Parts List

IX. Replacement Parts Diagram

NOTE 1. This diagram is for the PCY Model.

FINISH OPTIONS	
PCY	Powder Coat Safety Yellow/Black

TO ORDER PARTS CONTACT PS SAFETY ACCESS

877.446.1519 or

4psinfo@psindustries.com

ITEM #	DESCRIPTION	QTY	PART #
1	ASG;HINGE PLATE ASM	1	514308
1.1	ASG;HINGE PLATE PCB	1	514309
1.2	ASG;HINGE BRACKET PCB	2	514312
1.3	LSG;TORSION SPRING, 17-7 SS	2	514199
1.4	ASG;SPRING SPACER	2	514442
1.5	BEARING;G300 FLANGE, .3125ID	4	509753
1.6	BOLT;HEX5/16"18X4GR5ZN	2	500434
1.7	NUT;NYLOCK 5/16"18 ZN	2	501126
2	ASG;LARGE HOOP PCY	1	514316
3	LSG;2.25" RND TUBE CAP	2	514331
4	ASG;SMALL HOOP PCY	1	514322
5	LSG;2" RND TUBE CAP	2	514332
6	ASG;STRIKE PCY	1	514327
7	ASG;BUMPER .25X1.75X8.75 PSA	1	514439
8	BOLT;CARRIAGE 5/16"X3/4"GR5	5	514333
9	WASHER;FLAT 5/16"ZN	5	501949
10	NUT;NYLOCK 5/16"18ZN	5	501126
11	ASG;HARDWARE BAG PCY/GAL/MS	1	514503
11.1	BOLT;U 5/16"18X1 1/2 PIPEZN	2	500461
11.2	WASHER;FLAT 5/16"ZN	4	501949
11.3	NUT;NYLOCK 5/16"18ZN	4	501126
11.4	LSG;CAP PLASTIC FOR 5/16 BOLT	4	500932
11.5	LSG;STRIKE SUPPORT BLOCK PC	1	514493
11.6	SCREW;HEXDRILL14X2ZN	2	506020
11.7	ASG;TUBE CLAMP RING ANO BLK	2	514455
11.8	BOLT;HEX5/16"18X3/4GR5ZN	2	500429
11.9	NUT; JAM 5/16"18 ZN	2	501108
12	ASG;INSTALLATION/O&M MANUAL US	1	514337
13	DECAL;ASG FALL HAZARD US	1	514528

Inspection and Maintenance

X. Inspection and Maintenance (Minimum Annually)

IMPORTANT! Consult parts list before replacing fasteners, as all have specific design load requirements. Only use like items for replacement.

A. Adjustable Safety Gate:

1. Inspect components for damage, deterioration, and misalignment. Adjust, repair, or replace as needed, to meet original design tolerance.
2. Check gates for proper alignment with stopping surface. Adjust as necessary to achieve proper alignment and closing force.

B. Fasteners and mechanical connections

1. All fasteners must be in place and adjusted to their original design standard. Replace any damaged components.
2. Check all mounting connections, making sure they meet original design standards (refer to instructions) and can safely withstand all required loading requirements.

C. Finishes

1. Inspect and clean finishes periodically.
2. Touch up repair finishes, or refinish as necessary to protect the structural integrity of the Adjustable Safety Gate.
3. The PCY Adjustable Safety Gate comes with a polyester powder coat finish. Use finish materials compatible with powder coat. Follow paint manufacturers' instructions for prep and touch-up.

D. Housekeeping

1. To ensure your product continues to operate and last, upon completion of proper installation, complete the following:
 - a. Clean all surfaces.
 - b. If project is ongoing, protect installed products until final completion of project.
 - c. Touch-up, repair, or replace damaged components.
2. Ensure the area is clear of debris and interferences while swinging the gates.

E. Labels and Placards:

1. Inspect all labels and placards.
2. Replace any labels and placards which are unreadable/missing.

Inspection and Maintenance Log

CRITICAL Periodic Inspection and Maintenance Required. Inspect at minimum annually.

Date Purchased: _____

Product: _____

Model Number: _____

Opening Identifier/ Number: _____

Serial Number: _____

Location: _____

DATE INSPECTED	INSPECTED BY (Print & Sign)	INSPECTION ITEMS NOTED	CORRECTIVE ACTION	CORRECTED BY (Print & Sign)

Warranty Certificate

XI. Warranty Certificate

NOTICE Consult PS Safety Access at 877.446.1519 or 4psinfo@psindustries.com for the current Warranty Certificate.

THIS PAGE LEFT BLANK INTENTIONALLY

FOR CURRENT WARRANTY CERTIFICATE:

CONTACT PS SAFETY ACCESS

877.446.1519 or

4psinfo@psindustries.com



877.446.1519

4psinfo@psindustries.com | pssafetyaccess.com
1150 South 48th Street | Grand Forks, ND 58201

Product Registration:
psindustries.com/contact/register-your-product