



COMPUTER STATION



R5JDG-5801

Rousseau offers you a range of products and accessories to complete and complement your computer station. Computers are an integral part of all services, they require constant changes and updating, and this can change from one workspace to another.

In addition to the computer cabinet, Rousseau offers supports for monitors and keyboards. These are available in a wall-mounted version and for use with the multi-purpose frame, as well as the wall-mounted smart computer cabinet. All of these products will be very useful for your workspace.

No matter what your need is, Rousseau can supply a solution that is tailored to your situation. In addition, with Rousseau products, you will see the difference in the quality and the attention to detail.

Computer Station

One Stop Solution

With our vast range of products and accessories, you can create a customized computer station that is tailored to your needs. Whether you need your computer station equipped with a worksurface, extra storage, or even a basic inquiry station, we have the solution you need!

Our products are designed for industrial use (production floor, packing, maintenance and repair, machine shop, etc.), but with their attractive design, they can also be used in office environments (laboratories, electronic and computer environments, etc.).

Index	Page(s)
Computer Station	152 - 153
Proposals	154 - 157
Components and Accessories	158 - 161

Computer Cabinet

The Rousseau computer cabinet ensures a protection of the computer. The fan with filter will promote proper air circulation.

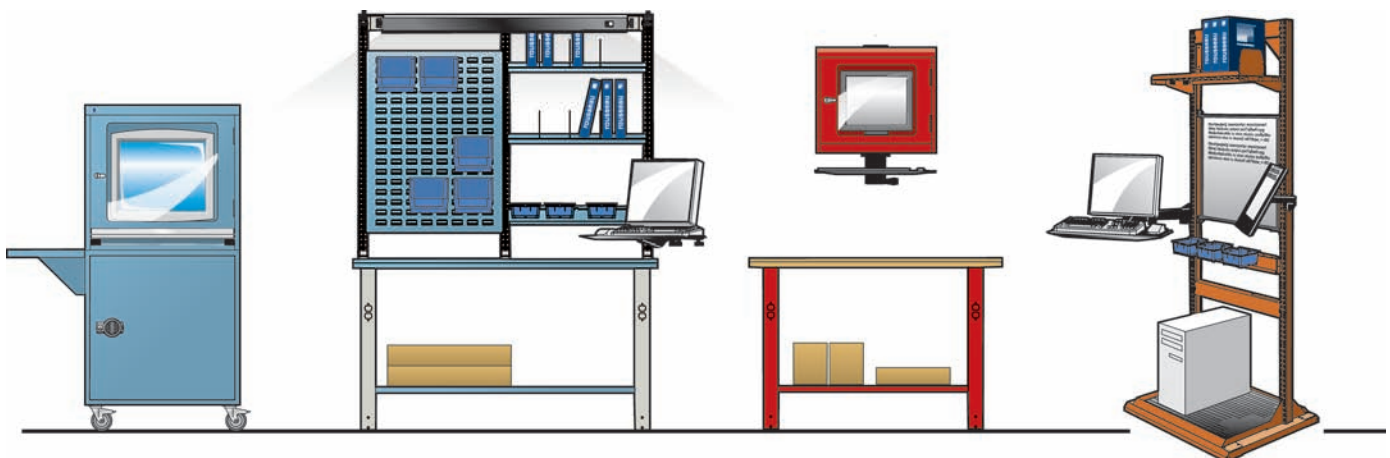
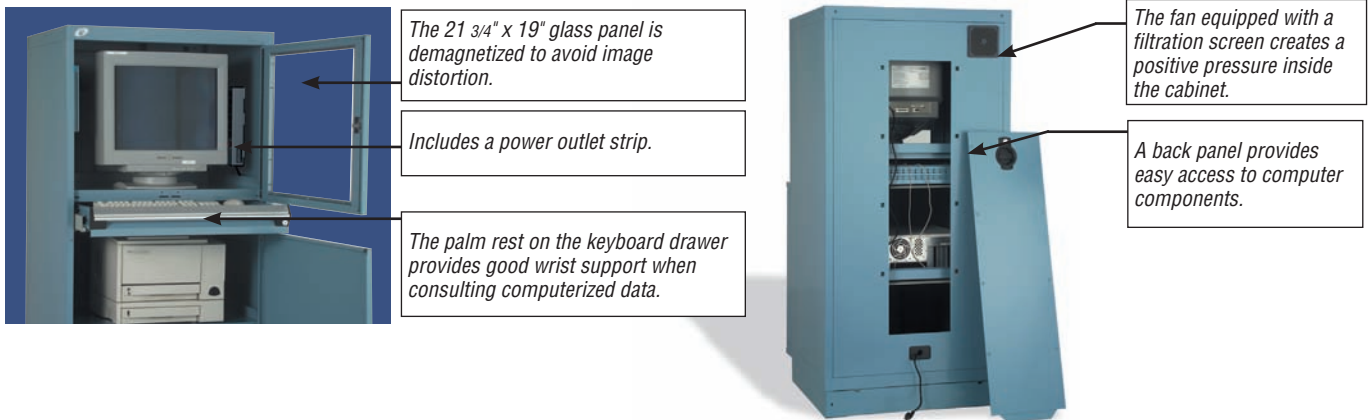

Computer Cabinet with Adjustable Shelf

Stationary



R5JDG-5801

1 computer cabinet housing with back access panel	RD31-302758L3
1 adjustable shelf (for monitor)	RB24-3027
1 keyboard drawer	RF31-302704L3
1 keyboard riser	RD40-301204
1 adjustable shelf (for printer)	RB24-3027
1 bottom shelf (for computer)	RB25-3027
1 glass door for screen	RD50-3022L3
1 single integrated door	RB30-3028L3

Stationary Cabinet Includes :

1 recessed base (front access)	RA55-302704
1 back cover plate	RA56-3004

Mobile Cabinet Includes :

2-4" rigid casters	RB80-01
2-4" swivel casters with total-lock brake system	RB80-03

Product #	W x D x H
R5JDG-5801	30" x 27" x 62"
R5JDG-5821	30" x 27" x 63 1/4"



Mobile



R5JDG-5821

Computer Cabinet with Roll-Out Shelf

Stationary



R5JDG-5815

1 computer cabinet housing with back access panel	RD31-302758L3
1 adjustable shelf (for monitor)	RB24-3027
1 keyboard drawer	RF31-302704L3
1 keyboard riser	RD40-301204
1 front access roll-out shelf (for printer)	RF50-3027
1 bottom shelf (for computer)	RB25-3027
1 glass door for screen	RD50-3022L3
1 single integrated door	RB30-3028L3

Stationary Model Includes :

1 recessed base (front access)	RA55-302704
1 back cover plate	RA56-3004

Mobile Model Includes :

2-4" rigid casters	RB80-01
2-4" swivel casters with total-lock brake system	RB80-03

Product #	W x D x H
R5JDG-5815	30" x 27" x 62"
R5JDG-5837	30" x 27" x 63 1/4"



Mobile



R5JDG-5837

Proposals

Computer Cabinet with Two Roll-Out Shelves

Stationary



R5JDG-5819

1 computer cabinet housing with back access panel	RD31-302758L3
1 adjustable shelf (for monitor)	RB24-3027
1 keyboard drawer	RF31-302704L3
1 keyboard riser	RD40-301204
1 front access roll-out shelf (for printer)	RF50-3027
1 front access roll-out shelf (for computer)	RF50-3027
1 glass door for screen	RD50-3022L3
1 single integrated door	RB30-3028L3

Stationary Cabinet Includes :

1 recessed base (front access)	RA55-302704
--------------------------------	-------------

1 back cover plate	RA56-3004
--------------------	-----------

Mobile Cabinet Includes :

2-4" rigid casters	RB80-01
--------------------	---------

2-4" swivel casters with total- lock brake system	RB80-03
---	---------

Product #	W x D x H
R5JDG-5819	30" x 27" x 62"
R5JDG-5839	30" x 27" x 63 1/4"

Mobile



R5JDG-5839



Workstation

Here are some of our different workstation options. Please see the «work center» section for the different accessories and configurations offered.

SEE PAGES 82-119

Computer Workstation with Light-Duty Cabinet



WSC2107

1 WM double unit frame	WM11-5636
1 LCD monitor and keyboard holder	WM65-01B
1 tiltable shelf	WM20-2808
3 partial dividers	SH52-1206
1 plastic bin rail	WM28-2801
1 power outlet channel	WM40-2801
1 tackboard and marker panel	WM54-2424
1 panel bracket kit	WM50-01
4 plastic bins	RG20-040303
1 laminated wood top	WS14-6030A
1 open leg	WS20-2732
1-light-duty cabinet	WS30-2357
1 cabinet base	WS31-182104

Product #	W x D x H
WSC2107	60" x 30" x 68"

Computer Workstation with CPU Support



WSC2108

1 CPU support	WS92-01	1 tiltable shelf	WM20-2808
1 laminated wood top	WS14-6030A	2 plastic bin rails	WM28-2801
1 open leg	WS20-2732	2 partial dividers	SH52-1206
1 light-duty cabinet	WSC0173	5 plastic bins	RG20-040303
3 multi-purpose uprights	WM10-24	3 plastic bins	RG20-060303
2 upright cross members	WM15-28	Product #	W x D x H
1 adjustable keyboard tray	WS90-02	WSC2108	60" x 30" x 58"
1 LCD monitor holder	WM65-02A		
1 power outlet channel	WM40-2801		

Multi-Purpose Stand

Here are some of our different multi-purpose stand options. Please see the «work center» section for the different accessories and configurations offered.

SEE PAGES 82-119

Off-Centered Model

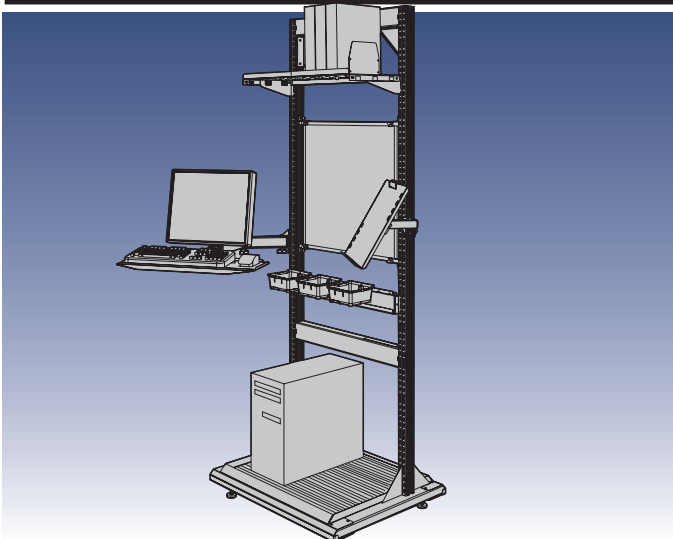

1 - 84" high off-center WM stand	WMA4001
1 LCD monitor and keyboard holder	WM65-02B
1 document holder with arm	WM70-01
1 tackboard and marker panel	WM54-2424
1 panel bracket kit	WM50-01
1 tiltable shelf	WM20-2812
2 partial dividers	SH52-1206
1 plastic bin rail	WM28-2801
4 plastic bins	RG20-060603
1 bottom shelf with rubber mat	WM83-282702
Product #	W x D x H
WMA4061	32" x 27" x 85"

Centered Model

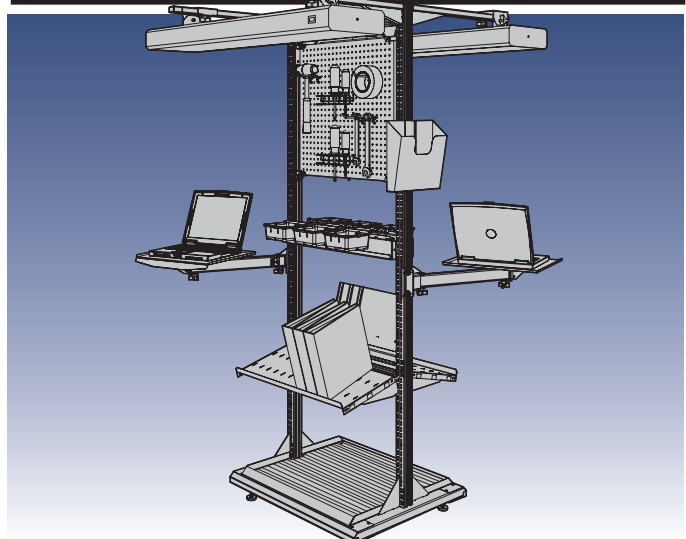

1 - 84" high centered WM stand	WMA3001
2 monitor trays	WM62-01A
2 perforated panels	WM53-2424
1 panel bracket kit	WM50-01
1 document holder	WM90-01
2 plastic bin rails	WM28-2801
6 plastic bins	RG20-060603
2 tiltable shelves	WM20-2812
2 screwdriver holders	WM95-01
1 pack of 10 hooks for perforated panel	WM98-03
2 pairs of cantilever overhead supports	WM18-26
2 overhead workstation lights	WM45-48T8
1 bottom shelf with rubber mat	WM83-282701
Product #	W x D x H
WMA3051	32" x 27" x 85"

Proposals

Smart Computer Cabinet

Our smart computer cabinet offers an alternative to conventional computer cabinets. You have the choice of a cabinet with or without doors, and with or without a keyboard tray.

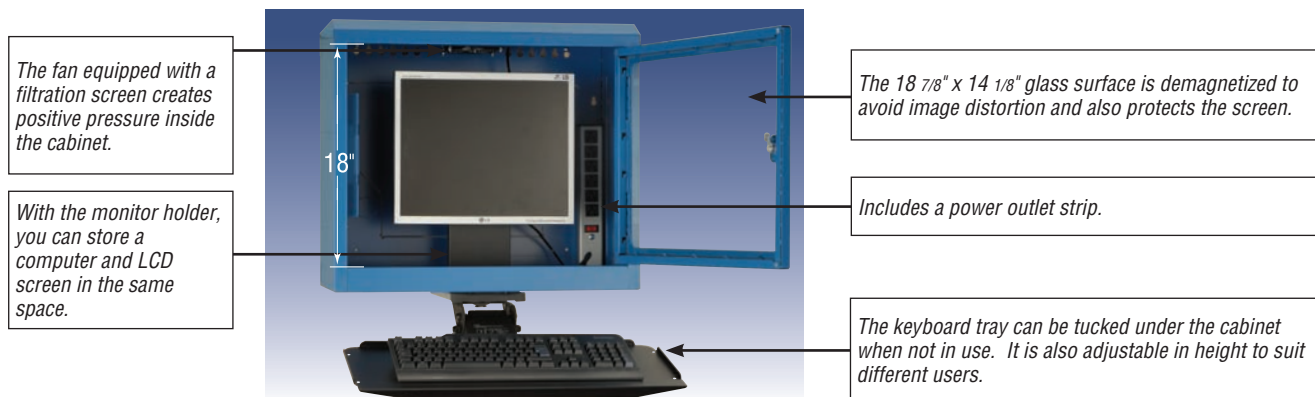

Smart Computer Cabinet with Choice of Configurations

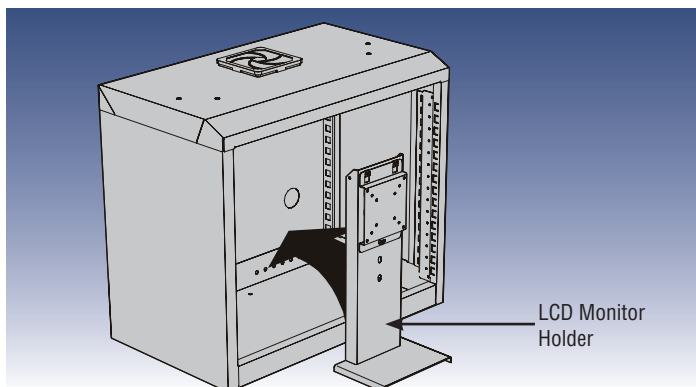

Cabinet dimensions : 24" W x 14" D x 21" H
 Glass surface dimensions : 18 7/8" W x 14 1/8" H
 Keyboard tray dimensions : 23 11/16" W x 8 1/2" D

Product #	Type
R5MCA-2450	Wall-mounted cabinet only
R5MCA-2451	Wall-mounted cabinet with glass door
R5MCA-2452	Wall-mounted cabinet with keyboard tray
R5MCA-2453	Wall-mounted cabinet with glass door and keyboard tray

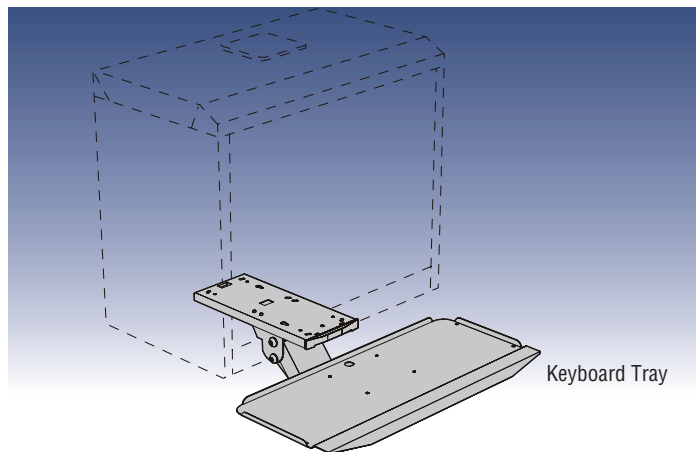
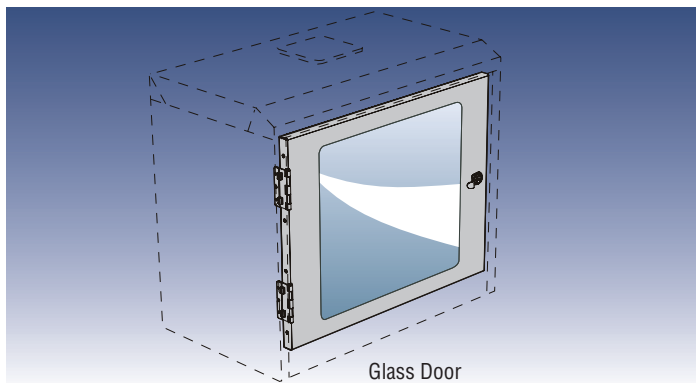

NOTE The wall-mounted cabinet includes the LCD monitor holder.

Computer Cabinet

Computer Cabinet Housing with Back Panel

RD31

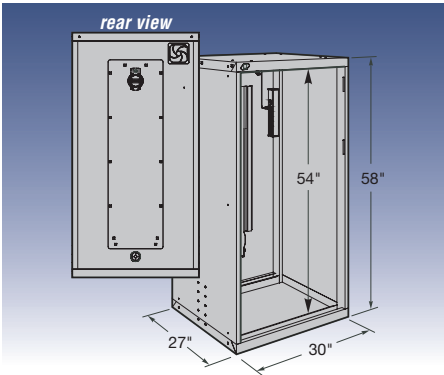

Equipped with ventilator with filtration screen;
 Includes power outlet strip;
 Back access panel provides easy access to computer components. Includes a lock;
 Space to run wires;
 Compatible with 4" and 6" casters;
 Compatible with RA53 forklift base, the RA55 recessed base and base risers RB94 and RB95;
 Note : It is strongly suggested to order a base (RA55, RB94 or RB95) for upright positions or for taller people.

Product #	W x D x H
RD31-302758L3	30" x 27" x 58"



Recessed Base

RA55

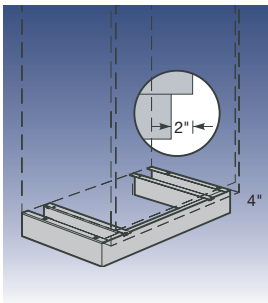

Designed to raise the height of a cabinet by 4";
 Designed for moving the cabinet from the front with a forklift or pallet-jack;
 Includes a removable cover plate at the front for aesthetics and in order to move the cabinet from the front;
 Compatible with the RA56 rear base cover plate, offered as an option. Front cover plate included;
 Front cover plate is on a straight angle to facilitate cleaning floors;
 Designed to allow user to anchor the cabinet to the floor;
 Compatible with leveling glides RA74;
 Not compatible with casters.

Product #	W x D x H
RA55-302704	30" x 27" x 4"

Riser Base

RB95

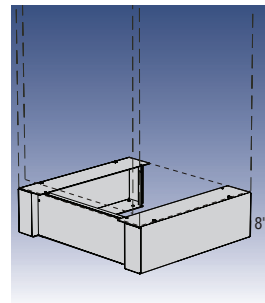

Used to raise the height of a cabinet by 8";
 Provides improved ergonomics for taller people;
 Installs directly under the cabinet;
 Used to move the cabinet from the front with a forklift;
 Compatible with leveling glides (RA74);
 Compatible with the RB98 rear base cover plate, offered as an option. Front cover plate included.

Product #	W x D x H
RB95-302708	30" x 27" x 8"

Base Riser for Mobile Cabinet

RB94

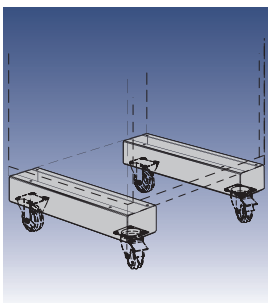

Designed to raise the height of a mobile cabinet by 4";
 Allows medium height and tall people to be comfortable when working at the cabinet;
 Installs directly under cabinet;
 Compatible with 4" and 6" high casters.

Product #	D x H
RB94-2704	27" x 4"

Cover Plate

RA56 / RB98

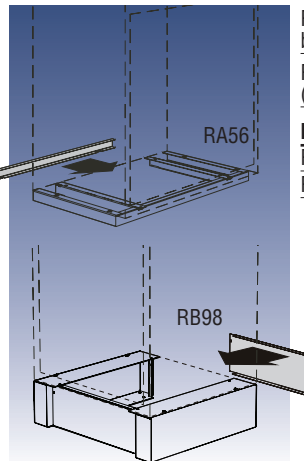

RA56 : Closes off the back of 4" recessed bases (RA55);
 RB98 : Closes off the back of riser base (RB95).

Product #	W x H	For
RA56-3004	30" x 4"	RA55
RB98-3008	30" x 8"	RB95

Components and Accessories

Leveling Glide Kit

RA74

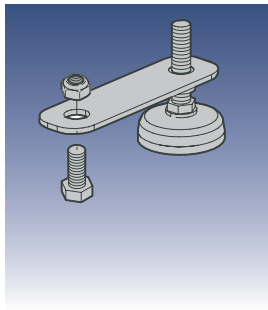

Sold in kits of 4;
Installs directly under the cabinet, without base, or under the RB95 riser base.
Installs directly under the cabinet without base.

Product #
RA74-01

4" and 6" casters

RB80 / RB83

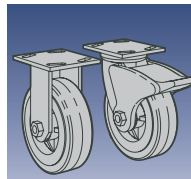

Sold in pairs;
Choice of 3 types of casters : rigid, swivel, swivel with total-lock brake system (on wheel and swivel);

4" casters: total height of 5 1/4";
6" casters: total height of 7 1/2";

Polyurethane casters (do not mark floors). Superior quality industrial casters;

The casters install directly under cabinet (without base); they are also compatible with the base riser (RB94) for mobile cabinets.

Product #	Height	Type of caster
RB80-01	4"	Rigid
RB80-02	4"	Swivel
RB80-03	4"	Swivel with total-lock brake system
RB83-01	6"	Rigid
RB83-02	6"	Swivel
RB83-03	6"	Swivel with total-lock brake system

Keyboard Drawer

RF31

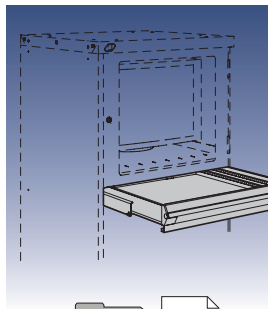

Possible to store a standard (12" deep) three-ring binder behind keyboard;

Compartments can be created by adding partitions, dividers and plastic bins;

Standard lock included;

Note : It is strongly recommended to order the RD40 keyboard riser to place keyboard and mouse in an ergonomic position.

Product #	W x D x H
RF31-302704L3	30" x 27" x 4"

SEE PAGES 147-150

KA, KD or MK
SEE PAGE 184

Keyboard Riser

RD40

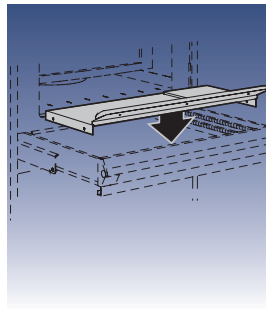

Allows user to place keyboard and mouse in an ergonomic position;

Equipped with wrist rest;

Leaves enough room to store a standard (12" deep) three-ring binder behind keyboard;

Leaves enough room to add compartments by adding partitions, dividers and plastic bins.

Product #	W x D x H
RD40-301204	30" x 12" x 4"

Roll-Out Shelf for Integrated Door

RF50

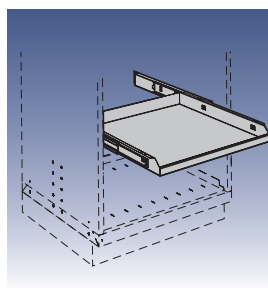

Allows storage of bulky items;
Compatible with the RB30 integrated door;
65% extension;
175 lb capacity;
Painted steel with back and side edges;
Full access to contents.

Product #	W x D
RF50-3027	30" x 27"

Adjustable Shelf

RB24

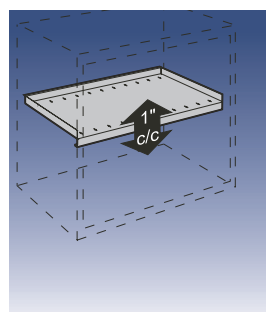

Perfect for storing bulky items;
Has edges along the sides and back to prevent items from falling into the bottom of the cabinet;

Adjustable every 1" c/c;

Up to 400 lb capacity, evenly distributed load.

Product #	W x D
RB24-3027	30" x 27"

Bottom Shelf for Cabinet

RB25

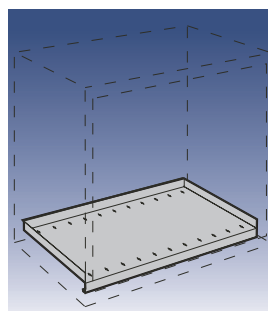

Perfect for storing bulky items;
Has edges along the sides and back to prevent items from falling into the bottom of the cabinet;

Up to 400 lb capacity, evenly distributed load.

Product #	W x D
RB25-3027	30" x 27"



COMPUTER STATION

Glass Door for Screen RD50

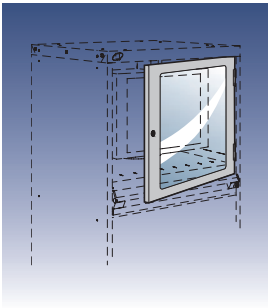

Demagnetized glass panel 21 1/4" W x 18 7/8" H to avoid image distortion;
 Factory installed on RD31 cabinet housings;
 Standard lock included.

Product #	W x H
RD50-3022L3	30" x 22"



Single Integrated Door, Solid or Glass RB30 / RB31

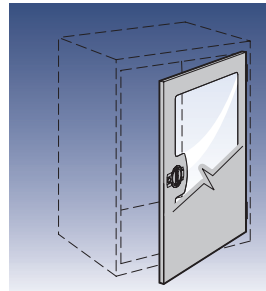

Single Integrated door : RB30;
 Single Integrated glass door : RB31;
 Compatible with the bottom shelf (RB25), the adjustable shelf (RB24) and the roll-out shelf (RF50);
 Opens 180° for full access to items stored inside;
 Factory installed on RD31 cabinet housings ;
 Standard lock included.

Product #	W x H
RB30-3028L3	30" x 28"
RB31-3028L3	30" x 28"



Foldaway Shelf RC00

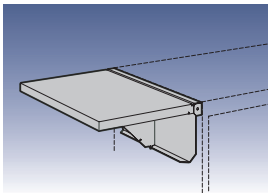

50 lb capacity (evenly distributed load);
 Rubber mat surface for added protection;
 RC01 side and back stops can be installed as an option.

Product #	W x D
RC00-152701	15" x 27"

Side and Back Stops for Foldaway Shelf RC01

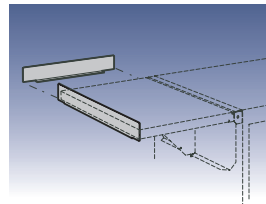

Use the 15" stop for the front or back of the shelf;
 Use the 27" stop for the sides;
 Height : 1".

Product #	Width
RC01-15	15"
RC01-27	27"

Accessories Underneath the Worksurface

Sliding Keyboard Tray WS90-01

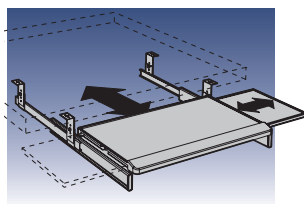

May be mounted on all surfaces;
 Mouse tray slides to the left or right side, as needed;
 Usable area : 8 1/2" x 20 1/2";
 Mouse tray : 9 3/8" x 9 1/8".

Product #	Color
WS90-01	Black

Adjustable Keyboard Tray WS90-02

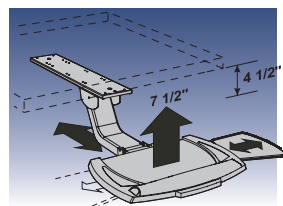

Support with articulating arm designed for use in the sit/stand position;
 May be mounted on all surfaces;
 Includes :
 - mouse tray, slides to the left or right side, as needed
 - ergonomic palm rest

Slides under the work surface for storage.
 Sturdy construction;

Usable area : 9 1/2" x 20 1/2";
 Mouse tray : 9 3/8" x 9".

Product #	Color
WS90-02	Black

CPU Support WS92



May be mounted on all surfaces;
 Handle allows width of plastic side support to be adjusted;
 Adjustments accommodate computers with dimensions of 3 1/2" to 9 1/4" width by 12 1/2" to 22 1/2" height;
 Width : 8 3/8" to 11 1/2";
 Depth : 6 3/4" (8 1/2" with handle);
 Height: 18" to 26".

Product #	Color
WS92-01	Black

Components and Accessories

Computer Supports for Multi-Purpose Frames

Standard Monitor Tray

WM62 / WM64

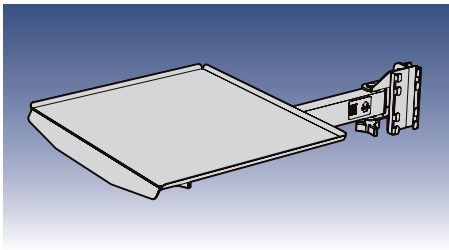

May be used to hold a computer monitor, laptop computer, electronic device or any other object;
 Usable tray space : 16" W x 13 7/8" D;
 Includes one 18" heavy-duty arm with single or double articulation and a non-slip rubber mat;
 The double articulated model allows for increased adjusting possibilities;
 Compatible with the WM63 keyboard and mouse tray;
 50 lb capacity (wall mounted version: the wall and wall anchoring must be strong enough);
 Color : Black;
 Wall anchoring not included for the wall mounted model.

Product #	Articulating Arm	Model
WM62-01A	Single	For WM11 frame
WM62-02A	Double	For WM11 frame
WM64-01A	Single	Wall mounted
WM64-02A	Double	Wall mounted



Keyboard and Mouse Tray

WM63

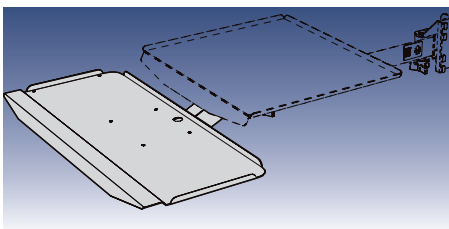

Installs on the WM62 and WM64 monitor tray with arm;
 Color : Black;
 Usable tray space : 23 11/16" W x 8 1/2" D.

Product #
WM63-2402



LCD Monitor Holder

WM65 / WM66

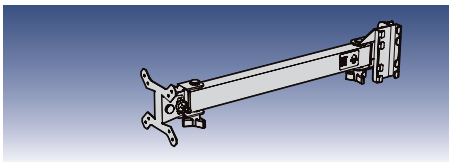

Can be used to hold the majority of LCD monitors on the market;
 Screen anchor support respects VESA 75 & 100 standards;
 Possible to tilt the screen;
 Color : Black;
 Note : Not compatible with the keyboard tray.

Product #	Articulating Arm	Model
WM65-01A	Single	For WM11 frame
WM65-02A	Double	For WM11 frame
WM66-01A	Single	Wall mounted
WM66-02A	Double	Wall mounted

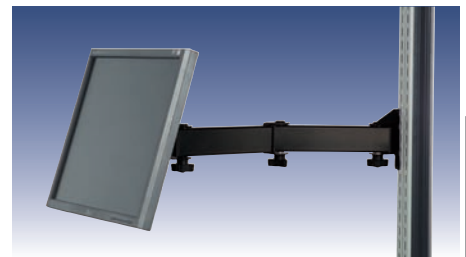

LCD Monitor and Keyboard Holder

WM65 / WM66

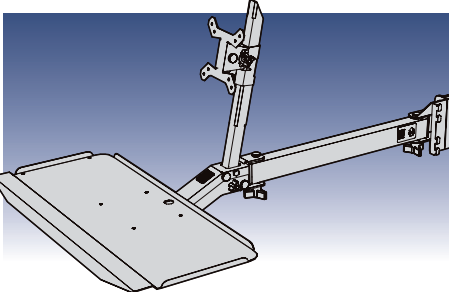

Can be used to hold the majority of LCD monitors on the market;
 Screen anchor support respects VESA 75 & 100 standards;
 Includes a keyboard holder, usable surface is 23 11/16" W x 8 1/2" D;
 Color : Black;
 Screen can be adjusted in height, and can also be tilted.

Product #	Articulating Arm	Model
WM65-01B	Single	For WM11 frame
WM65-02B	Double	For WM11 frame
WM66-01B	Single	Wall mounted
WM66-02B	Double	Wall mounted



Wall Mounted

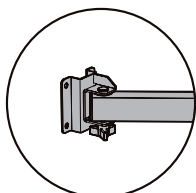

For WM11 Frame

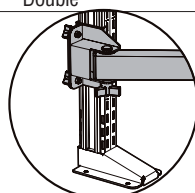

Double Articulating Arm

