

# TYPICAL WAREHOUSE APPLICATIONS

**IMMINENT DANGER FEATURE STANDARD ON ALL MODELS WITH BURST OR AUDIBLE!**

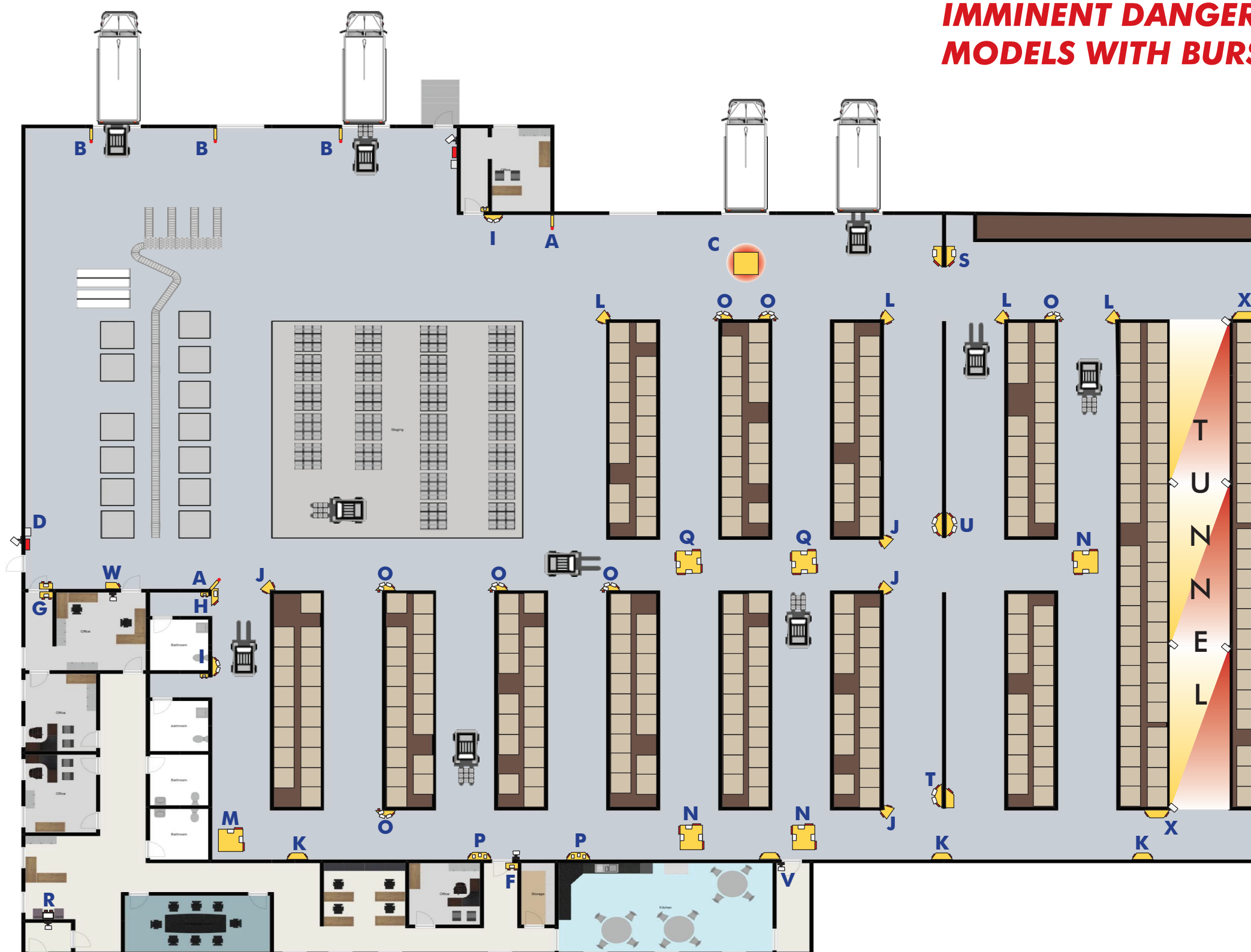

- A** Area Monitor (see catalog, pg. 4)
- B** Dock Door Monitor (pg. 12)
- C** Dock Watcher (pg. 12) – Up To 4 Dock Doors
- D** Dual Use 1 (pg. 14) – Indoor-Outdoor
- E** Economy Strobe (pg. 4)
- F** Hall Door Basic (pg. 5)
- G** Hall Door Monitor 2 (pg. 6)
- H** Hall Door Monitor 3 (pg. 6)
- I** Hall Door Monitor 4 (pg. 6)
- J** Look Out 1 (pg. 8)
- K** Look Out 1 Wall (pg. 8)
- L** Look Out 2 (pg. 8)
- M** Look Out 2 XL (pg. 8)
- N** Look Out 3 (pg. 9)
- O** Look Out 3 Rack – Left- or Right-Hand Mount
- P** Look Out 3 Wall (pg. 9)
- Q** Look Out 4 (pg. 10)
- R** Office Door Basic (pg. 5)
- S** Overhead Door 2 (pg. 7)
- T** Overhead Door 3 (pg. 7)
- U** Overhead Door 4 (pg. 7)
- V** Overhead Door Basic – Double (pg. 5)
- W** Overhead Door Basic – Single (pg. 5)
- X** Tunnel Application (300' example shown)