

X-PTS

AUTOMATION OF ORDER PREPARATION



HIGHLY-EFFICIENT
ROBOTIC PREPARATION
SOLUTIONS



Robust, modular and flexible solutions for very high preparation efficiency, the goods-to-person and goods-to-robot systems are especially suited to logistics centres seeking a combination of strong reactivity and high order preparation quality.

These compact and scalable systems can reduce the picking area significantly and its associated operating costs.

The goods-to-person and goods-to-robot systems can be rolled out in several phases in a new or existing warehouse alongside other intralogistics processes.

APPLICATIONS

Several logistics processes can be incorporated, from the retail preparation to stacking full boxes onto pallets via restocking manual picking areas.

RETAIL PREPARATION

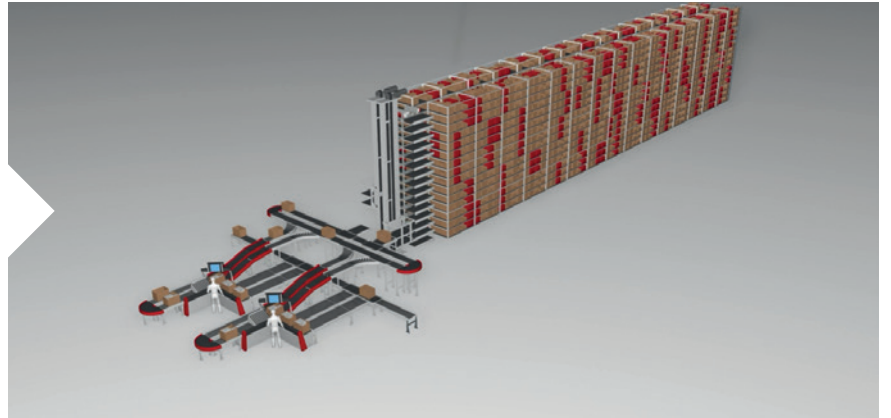

PREPARATION OF FULL PACKAGES

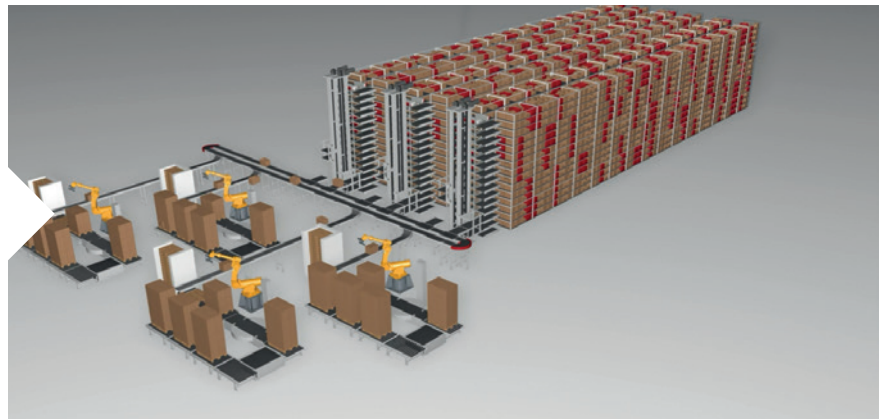

MIXED MODE: RETAIL PREPARATION AND PALLET STACKING BUFFER

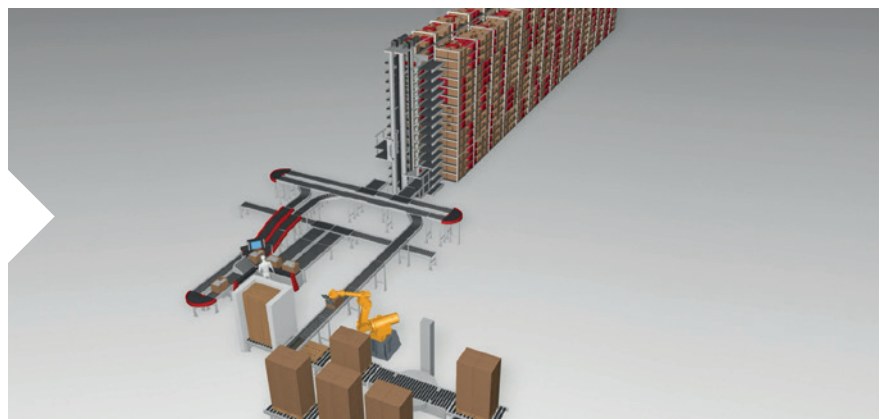



KEY COMPONENTS

**THESE SYSTEMS ARE MADE OF X-PTS
STORAGE AISLES AND INTELIS CONVEYORS
SUPPLYING THE PREPARATION, MANUAL
AND ROBOTIC STATIONS**

X-PTS AISLE

The X-PTS aisle is a shuttle system for stocking/destocking lightweight loads. It comprises:

- shuttles to move horizontally on each level.
- infeed and outfeed lifts to move vertically.

The X-PTS aisle is a high-speed shuttle system, based on our patented design of dual cradle lift that can perform cycles in optimum manner by carrying four loads at once.



GOODS-TO-PERSON WORKSTATION (PICK STATION)

The pick station is an ergonomic preparation station, designed to maintain steady rates and meet activity peaks. It can be used at will in different modes and activities: picking, inventory, exclusion, replenishment etc.

- Very high preparation quality thanks to the one-to-one picking, from a single position for a single place container.
- Reduced biomechanical and posture stress thanks to the sloping containers and easier validations.
- Intuitive HCI that are quick to learn and provide operator comfort.



CHARACTERISTICS

Stored loads

- Weight: up to 32 kg
- Dimensions: from 300x300x400mm to 620x420x425mm

Shuttle

- Speed: 3 m/s
- Acceleration: 1.5 m/s²

Lift

- Speed: 4.5 m/s
- Acceleration: 6 m/s²

X-PTS

HIGHLY-EFFICIENT ROBOTIC PREPARATION SOLUTIONS

ADVANTAGES

GREAT STORAGE FLEXIBILITY

- Crates, trays and boxes mixable in the same aisle.
- Single- or dual-storage format, up to six deep, of shelves that can be compartmentalised into several cells.
- System operating in ambient temperature, refrigerated and freezing environments.

SYSTEM DENSITY

- Compact structure: low height of tier step and inter-load differences.
- Very high storage density that can reduce warehousing volume.

HIGHLY EFFICIENT PREPARATION

- High-speed aisles capable of achieving a combination of 1100 infeeds and outfeeds per hour.
- Ergonomic work stations for rates up to 900 order lines per hour.

MAXIMUM AVAILABILITY

- Aisles divided into several isolated, secure areas so that work can continue without stopping in the adjacent areas.
- Control automatically takes into account maintenance work on part of the system, activations/deactivations of pick stations, etc. so that the system can continue to operate.

OPTIMUM CONTROL

- Scheduling algorithms balancing the activity of different components and the optimum use of the system.
- Full supervision cockpit to visualise and control the activity.
- Stock image guaranteed by different inventory logics.
- Automatic adaptation to changes in the rotation class of items.