

# FORK MOUNTED COIL RAM - CCF-36-4

APPROX WEIGHT: 300.83 lbs.  
DOES NOT INCLUDE WEIGHT OF POWER OR PACKAGING!!!

\*\*\* ANY ADDITIONS, DELETIONS, OR OMISSIONS MUST BE CORRECTED ON THIS DRAWING AS THIS DRAWING WILL BE CONSIDERED ALL INCLUSIVE \*\*\*

ALL GRAPHICS PROVIDED ARE FOR REFERENCE ONLY. IF CERTAIN DIMENSIONS ARE CRITICAL PLEASE VERIFY THOSE DIMENSIONS WITH YOUR SALESPERSON

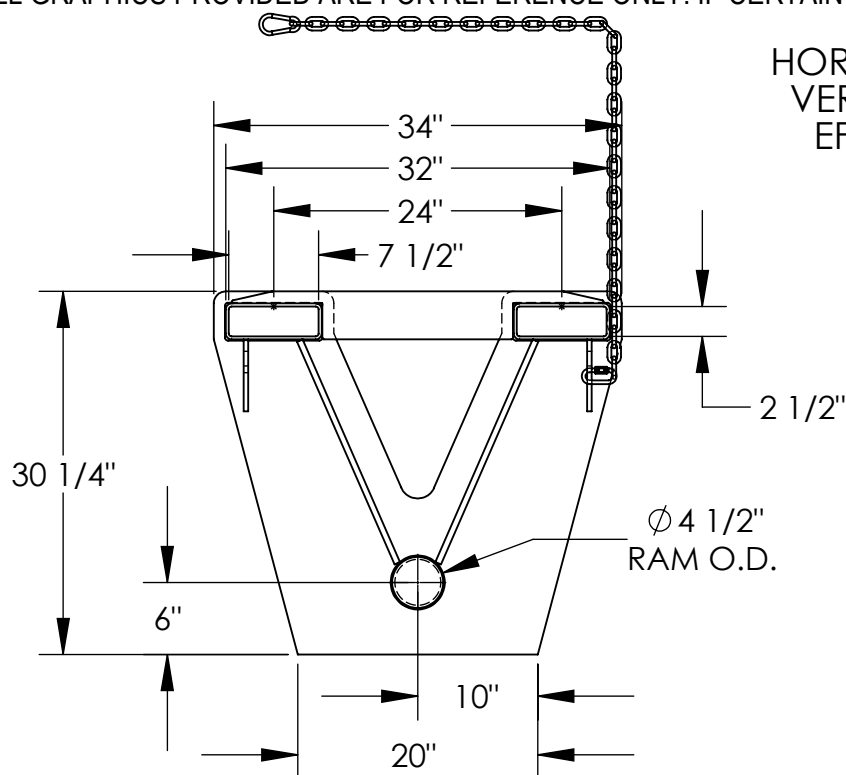

HORIZONTAL CENTER OF GRAVITY: 7.78"  
VERTICAL CENTER OF GRAVITY: 16.51"  
EFFECTIVE THICKNESS: LESS THAN 1"  
LOST LOAD: 300.83 lbs.

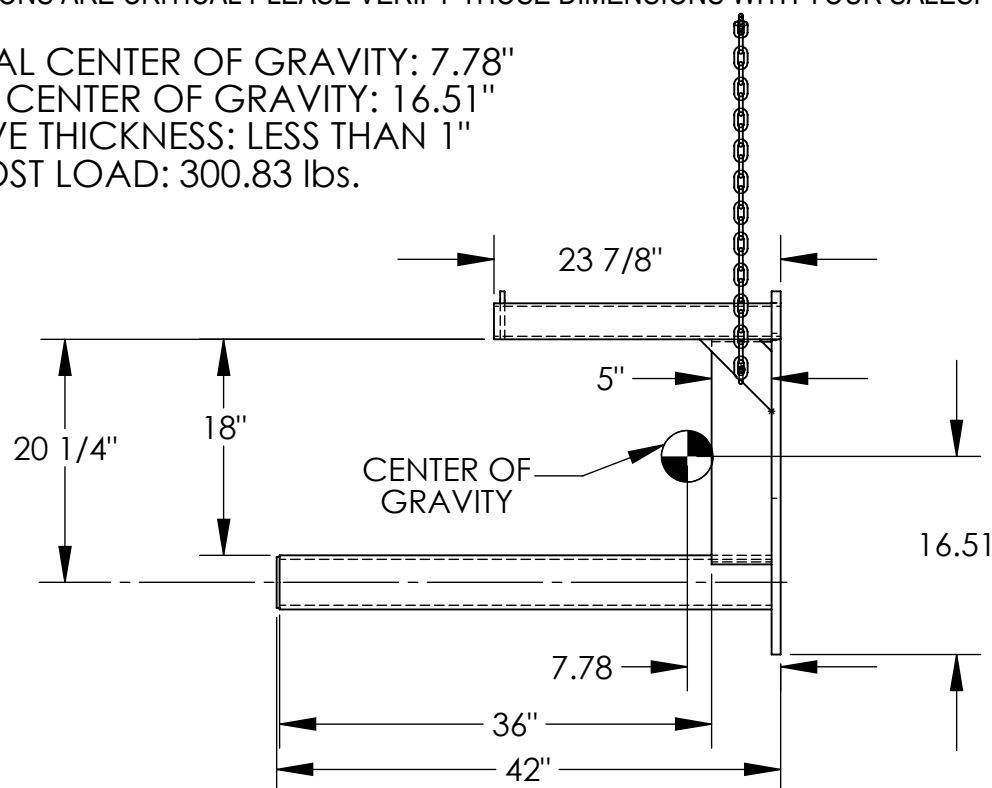

## STANDARD FEATURES

MODEL NUMBER IS CCF-36-4  
OVERALL WIDTH IS 34"  
OVERALL HEIGHT IS 30 1/4"  
USABLE RAM LENGTH IS 36"  
RAM O.D. IS 4 1/2"  
UNIFORM CAPACITY IS 3,000 LBS.  
STANDARD FORK POCKETS ARE  
7 1/2" W x 2 1/2" H USABLE ON  
24" CENTERS

## SPECIAL FEATURES

NONE

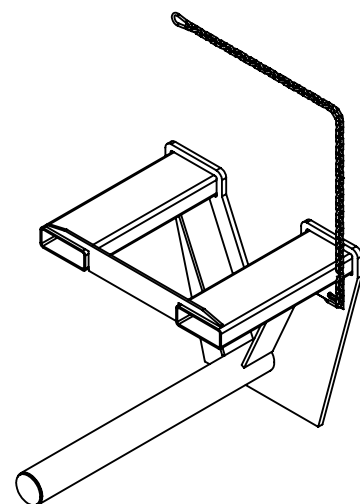

3-D VIEW SHOWN  
FOR REFERENCE ONLY  
SCALE: 1:24

## DIMENSION TOLERANCE $\pm 1/4$ "

APPROVAL

I, THE UNDERSIGNED, AGREE THAT THE PRODUCT AS REPRESENTED SATISFIES DESIGN AND DIMENSION REQUIREMENTS. I ALSO ACKNOWLEDGE MY DUTY TO CONFIRM PRODUCT AND INSTALLATION COMPLIANCE WITH ALL APPLICABLE FEDERAL, STATE AND LOCAL REGULATIONS AND STANDARDS.

**ANY MODIFIED UNITS ARE NON-RETURNABLE**

[ ] As drawn [ ] As marked

Signed: \_\_\_\_\_ Date: \_\_\_\_\_

Printed Name: \_\_\_\_\_

LEAD TIME WILL START UPON RECEIPT OF SIGNED APPROVAL DRAWING

FOR INTERNAL USE ONLY  
PROJECT SIGN OFF

SALES	
ENG.	
FAB.	
POWER	

DISTRIBUTOR'S NAME:

VESTIL MANUFACTURING

DRAWN BY: B. NOTHNAGEL

DATE: 8/1/2015

REFERENCE: X

SCALE: 1:16

QUOTED LEAD TIME: X

QUOTE #  
X

P.O.# X

W.O.# X

SALES: X

FILE NAME:

08-007-263